

# Wild Earth Travel

*Small Ships, Big Adventures*

**wildearth-travel.com**

**info@wildearth-travel.com**

## WILD COASTS OF ARGENTINA, SOUTH GEORGIA, AND THE FALKLANDS EXPEDITION

Discover Argentina's rugged eastern coast as we seek out secluded ports, wildlife-rich estuaries, and the vibrant waters of World Heritage-listed Peninsula Valdes, where our arrival coincides with the whale breeding season. Get immersed in a sea of black and white amid tens of thousands of king penguins on a remote beach in South Georgia, then hike the rocky shores of the Falkland Islands among fur seals and the world's largest colony of black-browed albatrosses.



### ITINERARY

#### DAYS 1-2 Buenos Aires, Argentina / Embark Ship

Arrive in Buenos Aires and check into the Alvear Icon Hotel (or similar). Set out on a guided tour of the city's beaux-arts palaces. Visit Recoleta--the final resting place of Argentina's iconic first lady, Eva Peron--and enjoy a private visit to El Zanjón de Granados, one of the city's premier museums. In the early evening, we gather for an informal reception and a drink at the hotel. After a choice of explorations the following day, set sail on National Geographic Endurance.

Wild Earth Travel

*Small Ships, Big Adventures*

**0800 945 3327** (within New Zealand) | +64 (0) 3 365 1355 | **1800 107 715** (within Australia)

info@wildearth-travel.com | **wildearth-travel.com**

# Wild Earth Travel

*Small Ships, Big Adventures*

**wildearth-travel.com**

**info@wildearth-travel.com**

Breakfast, lunch, and dinner are included on Day 2.

Arrival Time: Arrive before 11:30 a.m. local time.

Arrival City: Buenos Aires, Argentina

## DAY 3 Montevideo, Uruguay

Arrive in Uruguay's vibrant capital city and discover its elegant mix of architectural styles, ranging from Spanish colonial to art deco, or opt to join a bird-watching excursion in nearby wetlands. Later, travel outside the city to a family-owned estancia, or ranch, where we enjoy a traditional asado barbecue lunch accompanied by gaucho music and dancing.

Meals Included: Breakfast, Lunch, Dinner

## DAY 4 At Sea

As National Geographic Endurance sails south along the Argentinian coast, hear talks from our onboard naturalists and visit the ship's open Bridge to learn about navigation. Unwind with a massage in the spa or a session in the fitness center, get lost in a book in the library, or simply soak up the views from the rooftop observation deck or one of the outdoor infinity hot tubs.

Meals Included: Breakfast, Lunch, Dinner

## DAYS 5-6 Bahía Blanca / At Sea

Dock in the port city of Bahia Blanca. Travel into the hills and discover the flora and fauna of the Argentinean pampas on a guided hike. As we make our way back to the coast, visit one of the world's largest colonies of burrowing parrots. Scan the cliffs to see thousands of the colorful birds that make their nests

here. Once back on board, spend time on deck with our naturalists or relax and enjoy the ship's many amenities.

Meals Included: Breakfast, Lunch, Dinner

## DAYS 7-8 Puerto Madryn

Granted UNESCO World Heritage status as a marine sanctuary in 1999, Peninsula Valdes is the world's most important breeding ground for endangered southern right whales. Our arrival coincides with the height of whale season, optimizing our chances for spotting these magnificent creatures in their natural environment. Set out by local boat to seek out whale calves and their often-curious mothers, which can grow up to 50 feet long. Set foot on secluded beaches frequented by southern elephant seals, nesting Magellanic penguins, and frolicking sea lions. Scan the shores for orcas, which are known to beach themselves here to hunt for prey. During walks and hikes, keep an eye out for terrestrial wildlife such as the guanaco, armadillo, and the ostrich-like rhea.

Meals Included: Breakfast, Lunch, Dinner

## DAYS 9-10 Bahía Bustamante

Included in Patagonia Austral Marine National Park and the UNESCO-listed Patagonia Azul Biosphere Reserve, Bahia Bustamante is a hidden gem along the southern coast of Argentina. Steppes of inland Patagonia meet the sea, providing a rugged backdrop to the white-sand beaches and clear waters. Take a Zodiac cruise or kayak along the coast to observe an abundance of wildlife, such as blue-eyed and rock cormorants, Magellanic penguins, sea lions, and more. Learn about the rugged ranchers who settled in the region-remote and still largely wild-in the 1950s and built sustainable wool production on the grasslands and harvested seaweed from the sea.

Meals Included: Breakfast, Lunch, Dinner

## DAY 11 Puerto Deseado / At Sea

Wild Earth Travel

*Small Ships, Big Adventures*

**0800 945 3327** (within New Zealand) | +64 (0) 3 365 1355 | **1800 107 715** (within Australia)

info@wildearth-travel.com | **wildearth-travel.com**

# Wild Earth Travel

*Small Ships, Big Adventures*

[wildearth-travel.com](http://wildearth-travel.com)

[info@wildearth-travel.com](mailto:info@wildearth-travel.com)

Travel in small boats into the Reserva Natural Ria Deseado, a submerged estuary that is home to the black-and-white Commerson's dolphin-one of the smallest cetaceans in the world-and the only rockhopper penguin colony in Patagonia. Seek out these rare marine species and discover the reserve's unique geology. Later, at a local museum in Puerto Deseado, learn about the famous explorers who passed this way and peruse a collection of well-preserved artifacts retrieved from the shipwrecked H.M.S. Swift, a British sloop of war that sank in 1770. Spend the afternoon sailing Argentina's southern coast.

Meals Included: Breakfast, Lunch, Dinner

## DAYS 12-13 Falkland Islands

Discover the remote South Atlantic archipelago of the Falkland Islands, where some 200 islands each offer a distinct variation on rugged coastal beauty. White-sand beaches, soaring cliffs, windswept moors, and swaying tussock grass set a stunning natural backdrop to encounters with thriving wildlife-from thousands of gentoo, rockhopper, and Magellanic penguins to black-browed albatrosses, elephant and fur seals, and sea lions hauled out on rocks. Enjoy a variety of excursions with our naturalists and take in sweeping views at every turn.

Meals Included: Breakfast, Lunch, Dinner

## DAYS 14-15 At Sea

As we journey across these southern waters, deepen your understanding of this far-flung region. Learn about the history of Antarctic exploration and join our naturalists on deck to identify seabirds soaring overhead.

## DAYS 16-20 South Georgia Island

Spend five incredible days exploring the spectacular coastlines and abundant wildlife of South Georgia. Our schedule is flexible, and we anticipate opportunities to walk, hike, kayak, or explore by Zodiac most days. Take in unforgettable wildlife spectacles: the antics of elephant seals, leopard seals, and fur seals; cliffs inhabited by hundreds of nesting albatrosses; and shores peppered with tens of thousands of king penguins. Our stops may include visits to the abandoned whaling station at Grytviken, which played a part in the extraordinary story of Sir Ernest Shackleton's ill-fated expedition and is now the explorer's final resting place, as well as Stromness Bay, where Shackleton, Tom Crean, and Frank Worsley finally reached help after a year and a half stranded in Antarctica.

Meals Included: Breakfast, Lunch, Dinner

## DAYS 21-22 At Sea / Falklands

After time at sea, we return to the Falklands archipelago and its natural wonders. Stroll around the lively Victorian town of Port Stanley, the largest and most populated city in the Falklands, and mingle with islanders at a local pub in this remote outpost.

Meals Included: Breakfast, Lunch, Dinner

## DAYS 23-24 Falklands / At Sea

As we sail back to Ushuaia, an albatross or two may join the escort of seabirds that cross our bow and follow in our wake. Soak up final vistas of these southern waters, share photos with fellow travelers, and toast our epic voyage at a farewell dinner.

Meals Included: Breakfast, Lunch, Dinner

## DAY 25 Ushuaia / Disembark Ship / Fly to Buenos Aires



0800 945 3327 (within New Zealand) | +64 (0) 3 365 1355 | 1800 107 715 (within Australia)

[info@wildearth-travel.com](mailto:info@wildearth-travel.com) | [wildearth-travel.com](http://wildearth-travel.com)





# Wild Earth Travel

*Small Ships, Big Adventures*



**wildearth-travel.com**

**info@wildearth-travel.com**

Disembark in Ushuaia, the southernmost city in the world. Take a charter flight to Buenos Aires and connect with your flight home.

Meals Included: Breakfast

**Please Note:**

Itineraries are subject to change.



**Wild Earth Travel**

*Small Ships, Big Adventures*

**0800 945 3327** (within New Zealand) | +64 (0) 3 365 1355 | **1800 107 715** (within Australia)

info@wildearth-travel.com | **wildearth-travel.com**

# Wild Earth Travel

*Small Ships, Big Adventures*

**wildearth-travel.com**

**info@wildearth-travel.com**

## YOUR SHIP: NATIONAL GEOGRAPHIC ENDURANCE

<b>YOUR SHIP:</b>	<b>National Geographic Endurance</b>
<b>VESSEL TYPE:</b>	<b>Expedition Ship</b>
<b>LENGTH:</b>	<b>124 m</b>
<b>PASSENGER CAPACITY:</b>	<b>126</b>
<b>BUILT/REFURBISHED:</b>	<b>2020</b>

National Geographic Endurance is a state-of-the-art expedition vessel purpose-built for year-round polar navigation. Named in honour of Sir Ernest Shackleton's legendary Endurance expedition, she is the first polar ship in Lindblad's history designed from the keel up for exploration. With an ice-class rating of PC5 (Category A) and a fully stabilised hull, she grants access to remote and often uncharted corners of the Arctic and Antarctica in exceptional comfort and safety.

Her revolutionary X-Bow®--a striking forward-leaning design--enables superior wave-cutting performance, ensuring a smoother, quieter ride and minimising spray on deck for better wildlife observation. On board, guests enjoy thoughtfully designed public spaces including a wraparound observation lounge, library, and an expedition base for gear and briefings. Dining is offered across three flexible venues, all serving sustainable, locally inspired cuisine. With a full suite of tools for exploration and a design deeply rooted in expedition heritage, Endurance is the ultimate platform for discovering Earth's most remote regions.



Wild Earth Travel

*Small Ships, Big Adventures*

**0800 945 3327** (within New Zealand) | +64 (0) 3 365 1355 | **1800 107 715** (within Australia)

info@wildearth-travel.com | wildearth-travel.com

# Wild Earth Travel

*Small Ships, Big Adventures*

[wildearth-travel.com](http://wildearth-travel.com)

[info@wildearth-travel.com](mailto:info@wildearth-travel.com)

## INSIDE YOUR SHIP

### Observation Deck

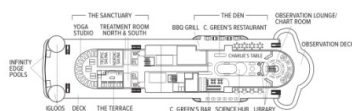

### Bridge Deck

- Category 5
- Category 6
- Category 7



### Lounge Deck

- Category 4
- Category B Solo



### Main Deck

- Category 3
- Category 2 Solo



### Fore Deck

- Category 1
- Category 2



### Expedition Deck



Wild Earth Travel

*Small Ships, Big Adventures*

0800 945 3327 (within New Zealand) | +64 (0) 3 365 1355 | 1800 107 715 (within Australia)

[info@wildearth-travel.com](mailto:info@wildearth-travel.com) | [wildearth-travel.com](http://wildearth-travel.com)





# Wild Earth Travel

*Small Ships, Big Adventures*



**wildearth-travel.com**

**info@wildearth-travel.com**

## PRICING

---



Wild Earth Travel

*Small Ships, Big Adventures*

**0800 945 3327** (within New Zealand) | +64 (0) 3 365 1355 | **1800 107 715** (within Australia)

info@wildearth-travel.com | **wildearth-travel.com**