

Wild Earth Travel

Small Ships, Big Adventures

wildearth-travel.com

info@wildearth-travel.com

DAY 2: THURSDAY AM: Mosquera PM: South Plaza

AM: Mosquera

Galapagos sea lions are true beach lovers and Mosquera offers beautiful white coral sand beaches, which contrast with the blue water and thus attract numerous sea lions. During a beach walk, you can observe numerous species of waders and sanderlings. Between the rocks, the red clip crabs wait to play hide and seek while you try to get the perfect photo. If you are lucky, you may even encounter yellow-crowned night-herons or even a red-footed booby.

PM - South Plaza

Popular South Plaza is not to be missed! This bizarre 'Jurassic islet' is the best place to see the emblematic 'Galapagos dragons', which crawl across it.

DAY 3: FRIDAY AM: Cormorant Point, Champion Islet (Floreana) PM: Baroness Lookout, Post Office Bay (Floreana)

AM - Cormorant Point, Champion Islet

This morning you will have a wet landing on this peninsula that is covered with aromatic palo santo forest. The sand at the beach is green, because it contains a high percentage of glassy olivine crystals that have been blown out by the surrounding tuff cones. Crossing to the other side of the peninsula, there is a 'flour sand' beach that originated from coral pulverized by Parrotfish. From the shore you could spot schools of stingrays who love burying themselves in the sandy bottom. During the first months of the year, Pacific green turtles come ashore to bury their eggs. Return on board.

PM: Baroness Lookout, Post Office Bay

While you were having lunch we navigated to Post Office Bay. This mailing station has been intermittently in use since the eighteenth century, when the Galapagos was a resupplying port for Pacific pirates. You can join their tradition and send greeting cards to your beloved ones worldwide using the historical barrel (it works). Nearby, the beach is normally visited by sea lions, pacific green turtles, golden rays and even penguins. Next, you may climb the miniature basaltic cone of Baroness Lookout and take in the paradisiacal coastal views. This viewpoint was the favourite spot of one of Floreana's first modern-era colonists, the eccentric self-proclaimed Baroness and 'Empress of

Galapagos' Eloisa von Wagner Bosquet, who even built her house a few metres behind. She and one of her lovers were the first in a series of mysterious disappearances and deaths occurring in this island during the 1930s.

DAY 4: SATURDAY AM: Suarez Point (Española) PM: Gardner Bay (Española)

AM: Suarez Point (Española)

This island is one of the greatest in the world for birdwatchers. Different kinds of finches, frigates, blue-footed boobies and Nazca boobies can be found, as well as the endemic Española mockingbird, Albatross, and Galapagos hawk. Watch your step, because each Albatross' couple lay an egg on the floor and make it roll over to improve hatching success. The juveniles attend the cliffs of the island to learn to fly by jumping into the abyss. And the chicks are organized in nurseries where they will safely remain while the adults are away at sea. Another highlight during this visit is "El Soplador", a 25 m water geiser produced by ocean waves crashing with great pressure with cracks in the island's cliff, spouting up through a lava tunnel. This site offers a fantastic background for a meditative experience or a memorable photo.

PM: Gardner Bay (Española)

We will keep exploring Española island, the oldest in the archipelago, estimated at over 4 million years old, located in the extreme southeast of the archipelago. On the north-eastern coast of this island, Gardner Bay offers a wonderful place to refresh in the turquoise sea and to snorkel side by side with eagle rays, golden rays, barracudas, batfish, turtles, sea lions, and white tipped sharks.

DAY 5: SUNDAY AM: Interpretation Center (San Cristobal) Transfer to San Cristobal airport.

AM: Interpretation Centre and Frigatebird Hill (San Cristobal)

Today, for your last excursion, you will disembark to San Cristobal island. There you will visit an Interpretation Center, where photos, historic documents and maquettes will help you get a glimpse of the seriousness and complexity of preserving the unique ecosystems of Galapagos. After this visit, you will disembark and get transferred to San Cristobal airport. There you will catch your flight.

Wild Earth Travel

Small Ships, Big Adventures

0800 945 3327 (within New Zealand) | +64 (0) 3 365 1355 | **1800 107 715** (within Australia)

info@wildearth-travel.com | **wildearth-travel.com**



Wild Earth Travel

Small Ships, Big Adventures



wildearth-travel.com

info@wildearth-travel.com

Please note:

Itineraries are subject to change.

Wild Earth Travel
Small Ships, Big Adventures

0800 945 3327 (within New Zealand) | +64 (0) 3 365 1355 | **1800 107 715** (within Australia)

info@wildearth-travel.com | **wildearth-travel.com**



Wild Earth Travel

Small Ships, Big Adventures

wildearth-travel.com

info@wildearth-travel.com

YOUR SHIP: TRIBUTE

YOUR SHIP:	Tribute
VESSEL TYPE:	Luxury Yacht
LENGTH:	43 meters
PASSENGER CAPACITY:	16
BUILT/REFURBISHED:	

Built/Refit: 2008/2023

Experience Galapagos in Luxury: Indulge in sophisticated design and breathtaking ocean views aboard our cruise. Savor local flavors in elegant indoor and outdoor dining areas. Retreat to premium suites with modern amenities. Relax in the outdoor Jacuzzi while soaking in stunning Galapagos vistas.

Amenities

Indulge in absolute luxury as you explore the Galapagos Islands with our Tribute Cruise. Enjoy the finest amenities, including a cocktail bar and wine vault, an ocean-view dining experience, and a delightful coffee and chocolate corner.

Our pop-up boutique offers exclusive treasures, while Freddy's lounge and library provide a tranquil escape.

The upper deck invites you to unwind in the sunset lounge, rejuvenate in the private massage area, or stay active in the workout zone.

On the sun deck, relish al fresco dining, savor a BBQ feast, and soak in breathtaking views from the panoramic lounge and sky tub. Your every desire is our pleasure.

Suites and Cabins

Immerse yourself in refinement aboard our Tribute Cruise.

Choose from our elegantly appointed suites and cabins to find your perfect sanctuary.

The Panorama Suites offer spacious comfort, with an average of 20m², and feature superior foam mattresses, a pillow menu, and individual air conditioning.

The Premium Suites, averaging 25m², include a convertible sofa, double washbasin, and extra storage.

Our Owner's Suite, an expansive 50m², boasts a resting lounge, double washbasin, and binoculars for wildlife enthusiasts.

For added convenience, our under-deck cabins provide privacy and comfort with private facilities and an average size of 18m². Enjoy every moment in style.

Elevated On-board Safety

Ensuring the utmost safety on-board is our paramount priority. We have proudly acquired the International Safety Management Certificate from the International Marine Organisation (IMO), demonstrating our unwavering commitment to safety protocols. Our vessel is equipped with state-of-the-art security equipment, adheres to stringent on-board regulations, and provides clear safety instructions.

Scheduled maintenance and rigorous inspections maintain our yacht in impeccable, secure condition, ensuring peace of mind for all our esteemed guests.



Wild Earth Travel
Small Ships, Big Adventures

0800 945 3327 (within New Zealand) | +64 (0) 3 365 1355 | **1800 107 715** (within Australia)

info@wildearth-travel.com | **wildearth-travel.com**



Wild Earth Travel

Small Ships, Big Adventures



wildearth-travel.com

info@wildearth-travel.com



med guests.



Wild Earth Travel

Small Ships, Big Adventures

0800 945 3327 (within New Zealand) | +64 (0) 3 365 1355 | **1800 107 715** (within Australia)

info@wildearth-travel.com | **wildearth-travel.com**

Wild Earth Travel

Small Ships, Big Adventures

wildearth-travel.com

info@wildearth-travel.com

INSIDE YOUR SHIP

Main Deck



Upper Deck

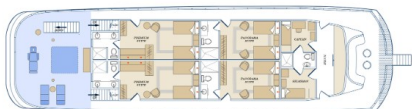

Sun Deck

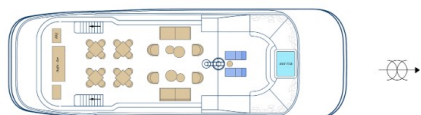

Suite. From



Wild Earth Travel
Small Ships, Big Adventures

0800 945 3327 (within New Zealand) | +64 (0) 3 365 1355 | 1800 107 715 (within Australia)

info@wildearth-travel.com | wildearth-travel.com

Wild Earth Travel

Small Ships, Big Adventures

wildearth-travel.com

info@wildearth-travel.com

PRICING

18-Jun-2025 to 22-Jun-2025

Suite. From 5595 USD pp

02-Jul-2025 to 06-Jul-2025

Suite. From 5595 USD pp

16-Jul-2025 to 20-Jul-2025

Suite. From 5595 USD pp

13-Aug-2025 to 17-Aug-2025

Suite. From 5595 USD pp

27-Aug-2025 to 31-Aug-2025

Suite. From 5595 USD pp

10-Sep-2025 to 14-Sep-2025

Suite. From 5595 USD pp

24-Sep-2025 to 28-Sep-2025

Suite. From 5595 USD pp

08-Oct-2025 to 12-Oct-2025

Suite. From 5595 USD pp

22-Oct-2025 to 26-Oct-2025

Suite. From 5595 USD pp

05-Nov-2025 to 09-Nov-2025

Suite. From 5595 USD pp

19-Nov-2025 to 23-Nov-2025

Suite. From 5595 USD pp

03-Dec-2025 to 07-Dec-2025

Suite. From 5595 USD pp

17-Dec-2025 to 21-Dec-2025

Suite. From 5595 USD pp

14-Jan-2026 to 18-Jan-2026

Suite. From 5995 USD pp

28-Jan-2026 to 01-Feb-2026

Suite. From 5995 USD pp

11-Feb-2026 to 15-Feb-2026

Suite. From 5995 USD pp

25-Feb-2026 to 01-Mar-2026

Suite. From 5995 USD pp

ADDITIONAL CHARGES:

Galapagos National Park entrance
fee & TCC 220 USD pp

Wild Earth Travel
Small Ships, Big Adventures

0800 945 3327 (within New Zealand) | +64 (0) 3 365 1355 | **1800 107 715** (within Australia)

info@wildearth-travel.com | wildearth-travel.com