

Wild Earth Travel

Small Ships, Big Adventures

wildearth-travel.com

info@wildearth-travel.com

TRIBUTE LUXURY GALAPAGOS CRUISE B - WILDLIFE DISCOVERY

Set sail on our Central & North Galapagos Safari, a 5-day Wildlife Discovery. Begin your journey to the pristine Lobos Islet.

Dive into encounters with the vibrant wildlife of Santa Fe, including endemic species. Explore the secluded wonders of Genovesa, famous for Darwin Bay and Prince Philip's Steps. Venture to Chinese Hat and Rabida, discovering unique landscapes and wildlife.

Conclude your adventure with a visit to the Charles Darwin Center on Santa Cruz, where conservation and discovery merge.

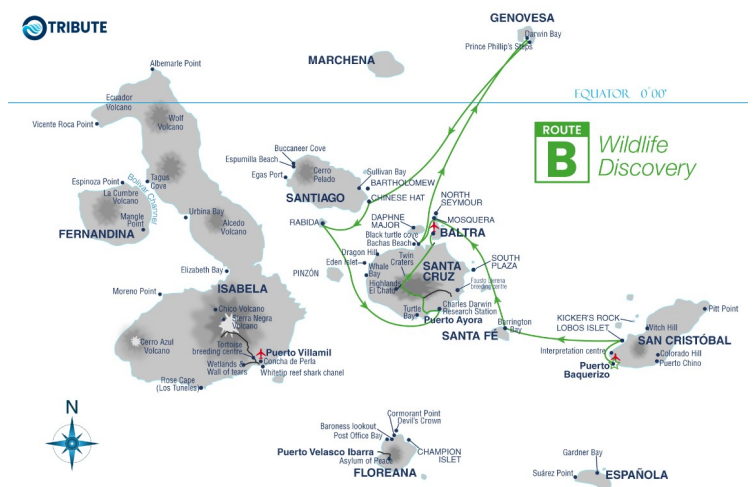

ITINERARY

DAY 1: SUNDAY AM: Flight to San Cristobal Airport (SCY) **PM:** Lobos Islet

AM: Arrival in Galapagos and boarding the yacht

Upon arrival at San Cristobal, you will pass through an airport inspection point to insure that no foreign plants or animals are introduced to the islands, as well as to pay the park entrance fee of \$100 (unless it has been prepaid). A guide will meet you, help you collect your luggage, and escort you on a short bus ride to the harbour, where you will board the Tribute cruise. You will be assigned to your cabins, and lunch will be served shortly after.

PM: Lobos islet (San Cristobal)

Lobos Islet harbours a colony of Galapagos sea lions. As in other colonies in the archipelago, you can approach nurturing females within a few metres. During breeding season this colony is also visited by territorial males, defending and mating their harem. There are two other emblematic species

Wild Earth Travel

Small Ships, Big Adventures

0800 945 3327 (within New Zealand) | +64 (0) 3 365 1355 | 1800 107 715 (within Australia)

info@wildearth-travel.com | wildearth-travel.com



Wild Earth Travel

Small Ships, Big Adventures

wildearth-travel.com

info@wildearth-travel.com

breeding here: male blue-footed boobies and great frigate birds who try to impress the females (and tourists) with clumsy dances, heaving their feet or blowing up their balloon-sized scarlet pouches.

DAY 2: MONDAY AM: Santa Fe PM: Black Turtle Cove (Santa Cruz)

AM: Santa Fe island

During your excursion at Santa Fe island, you will get surprised at how close to you some curious sea lions waddle. Likewise approachable for a close-up are Galapagos hawks that usually perch at their outlooks, ready to snatch away a baby marine iguana or lava lizard. We start next a cactus forest trail, that gives a close-up view on how these surrealistic, house-high giant opuntia prickly pears have grown out larger than on any other island and tell a fascinating evolutionary story. At the calm, turquoise Barrington Bay, you can swim in close company with Galapagos sea lions, fluorescent blue chin parrot fishes, yellowtail surgeon fishes, whiptail stingrays, Pacific green turtles, whitetip reef sharks, and more.

PM - Black Turtle Cove

You will disembark the cruise in the afternoon, to explore Black Turtle Cove from the dinghy. This place is a living illustration of how mangroves alter the marine environment to create a rich and unique habitat. Three mangrove species crowd the area from the shore out into the lagoon, which reaches almost a mile inland. As we drift through quiet waters in the zodiac, you are likely to see spotted eagle rays, which swim in a diamond formation. White-tipped reef sharks slip beneath the boat and Pacific green turtles come to the surface for air.

DAY 3: TUESDAY AM: Darwin Bay (Genovesa) PM: Prince Philip's Steps (Genovesa)

AM: Darwin Bay (Genovesa)

As one of the outer islands and most exclusive places on the Galapagos, Genovesa is well worth last night's longer navigation. This compact site in the heart of its flooded crater shows the extremely varied coastal ecosystems of the Galapagos in miniature; nearly too much for a single day. Whimbrels and wandering tattlers forage actively along the surf, next to resting Galapagos sea

lions. Impressive frigatebirds and red-footed boobies nest in the mangroves, where you can also see vocalists such as the yellow warbler, Darwin's finches and the Galapagos mockingbird. Uniquely, two subpopulations of the same species of large cactus finch differ in their singing

PM: Prince Philip's Steps (Genovesa)

Not only because of its historical English name (Tower) Genovesa has a royal touch. Follow in the footsteps of Prince Philip - Galapagos lover for many years - and visit this favourite birding spot with the largest breeding colonies of red-footed and Nazca boobies, and look for the remarkable short-eared owl that hunts on foot!

DAY 4: WEDNESDAY AM: Chinese Hat PM: Rabida

AM: Chinese Hat

Approaching Chinese Hat from the north, you will understand the reason of its name. You arrive just in time to witness how this young barren islet is being colonised by pioneer species sprouting from holes in the lava. The presence of Galapagos sea lions, countless marine iguanas, eagles and mockingbirds contribute to soil fertilisation. Snorkelling here is highly recommended, as it's home of a colony of Galapagos Penguins, critically endangered because of the effects of climate change. While you're swimming, they might approach curiously to your mask, alongside sea lions and elusive Pacific green turtles.

PM: Rabida island

This afternoon you have a 'wet landing' on the extraordinary red beach of Rabida island. Oxidised iron particles have given its rocks and sand an intense rusty colour. Contiguous to the beach is a shallow green lagoon, an oasis on this otherwise arid island, which attracts all kind of aquatic birds, like pintails and sometimes American flamingos. Between the evergreen foliage of the surrounding mangrove bushes, many species of songbirds hide and breed. One of the most outstanding attractions is the major breeding colony of brown pelicans, the only ones in the world that plunge-dive. On return you will be picked up by the inflatable dinghies, to get ready for snorkelling

DAY 5: THURSDAY AM: Charles Darwin Center (Santa Cruz) Transfer to Baltra airport.



Wild Earth Travel

Small Ships, Big Adventures

wildearth-travel.com

info@wildearth-travel.com

AM - Charles Darwin

Research Station (Santa Cruz) The dinghies will bring you to the touristic pier of Puerto Ayora, in Santa Cruz island, from where you will be brought to the Charles Darwin Research Station. This institution was named after the British naturalist who developed his Theory of Evolution after visiting these islands in 1835, and works on the conservation and restoration of the Galapagos ecosystems, as well as for the sustainable development of its communities. There is an interpretation centre about the National Park and its Marine Reserve. The most memorable part of your visit will probably be the successful breeding centre and the enclosures with Galapagos giant tortoises. After this visit, you will disembark the Tribute, and be transferred to Baltra airport.

Please note:

Itineraries are subject to change.

Wild Earth Travel
Small Ships, Big Adventures

0800 945 3327 (within New Zealand) | +64 (0) 3 365 1355 | **1800 107 715** (within Australia)

info@wildearth-travel.com | **wildearth-travel.com**



Wild Earth Travel

Small Ships, Big Adventures

wildearth-travel.com

info@wildearth-travel.com

YOUR SHIP: TRIBUTE

YOUR SHIP:	Tribute
VESSEL TYPE:	Luxury Yacht
LENGTH:	43 meters
PASSENGER CAPACITY:	16
BUILT/REFURBISHED:	

Built/Refit: 2008/2023

Experience Galapagos in Luxury: Indulge in sophisticated design and breathtaking ocean views aboard our cruise. Savor local flavors in elegant indoor and outdoor dining areas. Retreat to premium suites with modern amenities. Relax in the outdoor Jacuzzi while soaking in stunning Galapagos vistas.

Amenities

Indulge in absolute luxury as you explore the Galapagos Islands with our Tribute Cruise. Enjoy the finest amenities, including a cocktail bar and wine vault, an ocean-view dining experience, and a delightful coffee and chocolate corner.

Our pop-up boutique offers exclusive treasures, while Freddy's lounge and library provide a tranquil escape.

The upper deck invites you to unwind in the sunset lounge, rejuvenate in the private massage area, or stay active in the workout zone.

On the sun deck, relish al fresco dining, savor a BBQ feast, and soak in breathtaking views from the panoramic lounge and sky tub. Your every desire is our pleasure.

Suites and Cabins

Immerse yourself in refinement aboard our Tribute Cruise.

Choose from our elegantly appointed suites and cabins to find your perfect sanctuary.

The Panorama Suites offer spacious comfort, with an average of 20m², and feature superior foam mattresses, a pillow menu, and individual air conditioning.

The Premium Suites, averaging 25m², include a convertible sofa, double washbasin, and extra storage.

Our Owner's Suite, an expansive 50m², boasts a resting lounge, double washbasin, and binoculars for wildlife enthusiasts.

For added convenience, our under-deck cabins provide privacy and comfort with private facilities and an average size of 18m². Enjoy every moment in style.

Elevated On-board Safety

Ensuring the utmost safety on-board is our paramount priority. We have proudly acquired the International Safety Management Certificate from the International Marine Organisation (IMO), demonstrating our unwavering commitment to safety protocols. Our vessel is equipped with state-of-the-art security equipment, adheres to stringent on-board regulations, and provides clear safety instructions.

Scheduled maintenance and rigorous inspections maintain our yacht in impeccable, secure condition, ensuring peace of mind for all our esteemed guests.



Wild Earth Travel
Small Ships, Big Adventures

0800 945 3327 (within New Zealand) | +64 (0) 3 365 1355 | **1800 107 715** (within Australia)

info@wildearth-travel.com | **wildearth-travel.com**



Wild Earth Travel

Small Ships, Big Adventures



wildearth-travel.com

info@wildearth-travel.com



med guests.



Wild Earth Travel

Small Ships, Big Adventures

0800 945 3327 (within New Zealand) | +64 (0) 3 365 1355 | **1800 107 715** (within Australia)

info@wildearth-travel.com | **wildearth-travel.com**

Wild Earth Travel

Small Ships, Big Adventures

wildearth-travel.com

info@wildearth-travel.com

INSIDE YOUR SHIP

Main Deck



Upper Deck

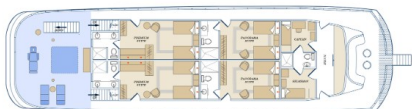

Sun Deck

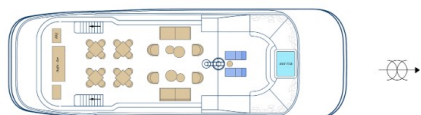

Suite. From



Wild Earth Travel
Small Ships, Big Adventures

0800 945 3327 (within New Zealand) | +64 (0) 3 365 1355 | 1800 107 715 (within Australia)

info@wildearth-travel.com | wildearth-travel.com

Wild Earth Travel

Small Ships, Big Adventures

wildearth-travel.com

info@wildearth-travel.com

PRICING

22-Jun-2025 to 26-Jun-2025

Suite. From 5595 USD pp

06-Jul-2025 to 10-Jul-2025

Suite. From 5595 USD pp

20-Jul-2025 to 24-Jul-2025

Suite. From 5595 USD pp

03-Aug-2025 to 07-Aug-2025

Suite. From 5595 USD pp

17-Aug-2025 to 21-Aug-2025

Suite. From 5595 USD pp

14-Sep-2025 to 18-Sep-2025

Suite. From 5595 USD pp

28-Sep-2025 to 02-Oct-2025

Suite. From 5595 USD pp

12-Oct-2025 to 16-Oct-2025

Suite. From 5595 USD pp

26-Oct-2025 to 30-Oct-2025

Suite. From 5595 USD pp

09-Nov-2025 to 13-Nov-2025

Suite. From 5595 USD pp

23-Nov-2025 to 27-Nov-2025

Suite. From 5595 USD pp

07-Dec-2025 to 11-Dec-2025

Suite. From 5595 USD pp

21-Dec-2025 to 25-Dec-2025

Suite. From 5595 USD pp

04-Jan-2026 to 08-Jan-2026

Suite. From 5995 USD pp

18-Jan-2026 to 22-Jan-2026

Suite. From 5995 USD pp

01-Feb-2026 to 05-Feb-2026

Suite. From 5995 USD pp

15-Feb-2026 to 19-Feb-2026

Suite. From 5995 USD pp

ADDITIONAL CHARGES:

Galapagos National Park entrance
fee & TCC 220 USD pp

Wild Earth Travel
Small Ships, Big Adventures

0800 945 3327 (within New Zealand) | +64 (0) 3 365 1355 | **1800 107 715** (within Australia)

info@wildearth-travel.com | wildearth-travel.com