

Wild Earth Travel

Small Ships, Big Adventures

wildearth-travel.com

info@wildearth-travel.com

STEWART ISLAND / RAKIURA NEW ZEALAND CRUISE

SCENIC, HISTORY & NATURE EXPEDITIONS Our seven-day Scenic Expeditions are designed for individuals, couples or small groups of family or friends who wish to book a cabin or cabins to join others to experience and explore the inlets, bays and rivers of Stewart Island in a kayak, or in the Fiordland Jewel's tender boat, if the weather permits there is a chance that we can circumnavigate the island and discover remote areas of Rakiura National Park, which comprises 85% of the island's 1,570 square kilometers. On most days there will be the opportunity to head to shore, with the chance to stretch your legs. Bush, island and beach walks include the Ulva Island bird sanctuary, historic Norwegian whaling station in Prices Inlet and Little Glory Bay. Experience Stewart Island's abundant marine and bird life. All nine luxury cabins have sea views and a private ensuite and are fully air-conditioned and heated.



ITINERARY

Day 1 Embarkation

It is recommended to stay in Invercargill or Bluff the night before and after the charter. The ferry will take you from Bluff to Oban where you will board the Fiordland Jewel in Halfmoon Bay, Oban late morning, and then return 7 days later to Halfmoon Bay, Oban. Explore Paterson Inlet/Whaka a Te Wera, a 8,900-hectare inlet with 188 kilometres of coastline, formed by post-glaciation flooding 12,000 to 16,000 years ago. The Rakeahua River flows into its South West Arm and the Freshwater River near North Arm. Please note: There are variations are subject to the weather. This is a sample itinerary

Wild Earth Travel

Small Ships, Big Adventures

0800 945 3327 (within New Zealand) | +64 (0) 3 365 1355 | **1800 107 715** (within Australia)

info@wildearth-travel.com | **wildearth-travel.com**



of a Stewart Island expedition. Plan A is to travel the distance around Stewart Island - approx. 130 to 160 kms. Plan B is to do as much as we can given the Skipper's judgement and weather conditions whilst you are on board. In addition to below there is also lots of cruising, fishing and kayaking or walking where time allows

Day 2 Ulva Island

Spend the morning exploring the largest island in Paterson Inlet/Whaka a Te Wera the Ulva Island bird sanctuary. In the afternoon visit the historic Norwegian whaling station in Prices Inlet and/or kayak Kaipipi Bay. Cruise to Port Adventure, a bay 10 kilometres south along the coast from The Neck the long peninsula at the mouth of Paterson Inlet, popular for fishing, diving and hunting. It was the site of a settlement of 36 Maori who arrived from The Neck in 1843.

Day 3 Port Pegasus

Port Adventure to Port Pegasus. Cruise along the coast which is largely rocky with occasional beaches. South of Lords River/Tutaekawetoweto it is exposed and mostly cliffs. Subsidence has created drowned river valleys such as Tikotatahi Bay, Tutaepawhati Bay and Big Kurii Bay. On arrival in Port Pegasus there may be time for kayaking and/or a short walk before dinner.

Day 4 & 5 Port Pegasus/Pikihititi

Port Pegasus/Pikihititi. Explore this large sheltered harbour on the south-east coast. Its inlets, coves and bays cover some 40 square kilometres, with many safe and sheltered anchorages. Four major passages provide access to the sea. The passages in turn open out into two main arms - North Arm and South Arm. It was first charted by William Stewart in 1809. A colonisation enterprise in the 1820s was not successful. Activities around Port Pegasus can include walks and kayaking.

Day 6 Oban

Commence the journey back to Oban along the west or east coast.

Day 7 Disembarkation

Depart the Fiordland Jewel early morning in Oban, and catch the ferry back to Bluff. This cruise around Stewart Island, may include (weather permitting) activities such as: Kayaking Tender boat excursions Walking Launching the ROV to view underwater marine life Some fishing Bluff Oyster dredging

Please Note:

Itineraries are subject to change.

Wild Earth Travel

Small Ships, Big Adventures

wildearth-travel.com

info@wildearth-travel.com

YOUR SHIP: FIORDLAND JEWEL

YOUR SHIP: Fiordland Jewel

VESSEL TYPE: Catamaran

LENGTH: 24 metres

PASSENGER CAPACITY: 18-20

BUILT/REFURBISHED:

The Fiordland Jewel is a 24m, three-deck catamaran with a high quality 5-star marine fit-out. Our Milford Sound Overnight Cruise sleeps 20 passengers a night and on our Fiordland and Stewart Island private charters and our small group scenic boat expeditions we cater to a maximum of 18 passengers in nine climate-controlled cabins, each with their own ensuite bathroom.

Features :

Helicopter pad.

Top-deck hot tub.

Cabin information:

1 x Governor Cabin. At the top of the boat all by itself with its own full width forward window and large side windows. Super-King double bed, the ensuite has a separate shower and toilet.

4 x Captain Cook Cabins. All on the main deck all with sea views. Super-King double bed, each ensuite has a separate shower and toilet.

2 x Endeavour Cabins. Both on the main deck both with sea views. King single beds, each ensuite has a separate shower and toilet.

2 x Resolution Cabins. Both on the main deck both with sea views. 2 single bunks single beds, each ensuite has a combined shower and toilet.



and toilet.

Wild Earth Travel

Small Ships, Big Adventures

0800 945 3327 (within New Zealand) | +64 (0) 3 365 1355 | **1800 107 715** (within Australia)

info@wildearth-travel.com | **wildearth-travel.com**

Wild Earth Travel

Small Ships, Big Adventures

wildearth-travel.com

info@wildearth-travel.com

INSIDE YOUR SHIP

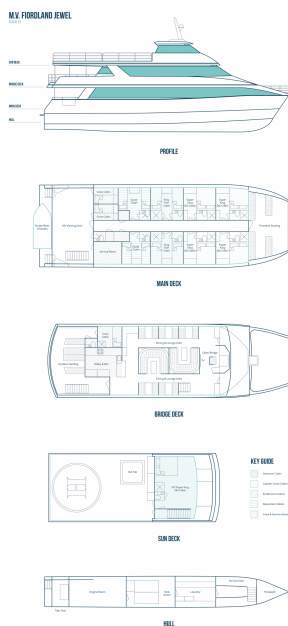

Captain Cook Deluxe King



Endeavour Deluxe Twin



Governor Suite Executive King



Resolution Deluxe Quadruple



Wild Earth Travel

Small Ships, Big Adventures

0800 945 3327 (within New Zealand) | +64 (0) 3 365 1355 | 1800 107 715 (within Australia)

info@wildearth-travel.com | wildearth-travel.com

Wild Earth Travel

Small Ships, Big Adventures

wildearth-travel.com

info@wildearth-travel.com

PRICING

13-Aug-2025 to 19-Aug-2025

Resolution Deluxe Quadruple	4350 NZD pp
Endeavour Deluxe Twin	7100 NZD pp
Captain Cook Deluxe King	7100 NZD pp
Governor Suite Executive King	8600 NZD pp

20-Aug-2025 to 26-Aug-2025

Resolution Deluxe Quadruple	4350 NZD pp
Endeavour Deluxe Twin	7100 NZD pp
Captain Cook Deluxe King	7100 NZD pp
Governor Suite Executive King	8600 NZD pp

Optional extras & upgrades

Pre and Post Add-on Queenstown Transfers 200 NZD

It is recommended to stay in Invercargill or Bluff the night before and after the charter. We have the option to arrange a transfer from Queenstown the day prior, in our two 11 seater vans, to Bluff at the additional charge of \$200 per person, round trip.