

# Wild Earth Travel

*Small Ships, Big Adventures*

**wildearth-travel.com**

**info@wildearth-travel.com**

## SOUTHERN QUEST - 8 DAY SOUTHERN KIMBERLEY CRUISE

Many icons of the Kimberley can be found in the stunning southern region. This area is prolific with islands, whirlpools, inlets and pockets of rainforest home to many species of birds and other wildlife. You will explore a land of extraordinary contrast and colour, rich in history, ancient Aboriginal rock art and breathtaking scenery. We visit the famous Horizontal Falls, Montgomery Reef and the King Cascade - a spring-fed waterfall in the Prince Regent River as well as many other Kimberley icons. This 8 day Kimberley cruise also includes a scenic flight over the Mitchell Falls. This 8 day Kimberley cruise also includes a helicopter flight over the Mitchell Falls.

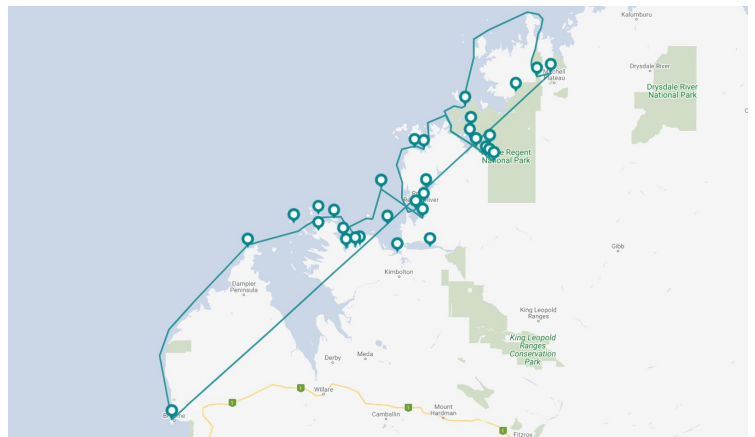

### ITINERARY

#### DAY 1: BROOME - CAPE LEVEQUE

Your Southern Quest begins when a courtesy vehicle picks you up from your accommodation at approximately 4.30pm and transfers you to the Kimberley Quest II, where you will be welcomed on-board by your captain and crew. Enjoy a relaxing drink as you watch the sun dip below the horizon, while cruising past the famous Cable Beach.

#### DAY 2: BUCCANEER ARCHIPELAGO, DUGONG BAY, TALBOT BAY

This morning will find us crossing the vast King Sound, cruising through the thousand islands of the Buccaneer Archipelago; this is your first taste of the Kimberley. Cool off with a refreshing swim in Dugong Bay, followed by a scenic tender excursion. Around the corner lies Talbot Bay, home to one of the icons of the Kimberley coast, the spectacular Horizontal Waterfalls. Take a tender and head in for an up-close and exhilarating ride through this natural phenomenon. In the afternoon take a scenic excursion up the back of Cyclone Creek to marvel at the amazing rock formations.

Wild Earth Travel

*Small Ships, Big Adventures*

**0800 945 3327** (within New Zealand) | +64 (0) 3 365 1355 | **1800 107 715** (within Australia)

info@wildearth-travel.com | **wildearth-travel.com**



# Wild Earth Travel

*Small Ships, Big Adventures*

**wildearth-travel.com**

**info@wildearth-travel.com**

## DAY 3: COLLIER BAY, MONTGOMERY REEF, RED CONE CREEK

Early morning we take you fishing in Collier Bay, your first chance to catch a barramundi. We then cruise to the amazing Montgomery Reef, which covers more than 300km<sup>2</sup>, making it Australia's largest inshore reef. Watch as the tide falls right before your eyes, creating a spectacular waterfall effect. Take a tender ride to view many marine species, including turtles and sea birds. Enjoy an afternoon cruise to Red Cone Creek for a refreshing swim at Ruby Falls or try your luck at mud crabbing.

## DAY 4: DOUBTFUL BAY, SALE RIVER, RAFT POINT

This morning we fish the inlets of Doubtful Bay for the elusive barramundi and threadfin salmon. We then explore the Sale River and take an excursion upstream for a dip in the spring-fed rainforest pools, on the journey home view ancient rock art from the tenders. In the afternoon we cruise towards Steep Island, anchor below Raft Point and walk to the caves perched on the hill. Here is some of the finest well-preserved Wandjina art in the Kimberley. From the top we have an amazing view of the Kimberley Coast as the sun begins to set, capturing this unique landscape at its best.

## DAY 5: KURI BAY, CAMDEN HARBOUR

Relax on board as we cruise past Augustus Island and the remote pearling settlement of Kuri Bay. At nearby Camden Harbour, we visit the forlorn settler's graves on Sheep Island and soak up the history of the first European settlement in the 1860s. In the afternoon take a tender excursion for a spot of exploration. Have a go at fishing or collect rock oysters, before unwinding on the sundeck to take in the beautiful scenery.

## DAY 6: PRINCE REGENT RIVER, KING CASCADE, CATHEDRAL FALLS

Early morning we cruise through St George Basin, a stunning inland sea. Leaving the vista of mighty Mt Trafalgar and Mt Waterloo, we cruise up the Prince Regent River, marvelling at the pristine waterway that cuts through sandstone cliffs and gorges. Arriving at King Cascade, which is spring fed, marvel at the rush of water cascading in breathtaking tiers, surrounded by lush

ferns and a myriad of wildlife. Climb above the falls for an unforgettable swim in a massive crystal clear pool. Be rewarded with a breathtaking view over the magnificent Prince Regent River in the distance - wilderness adventuring at its best! Late afternoon join our guides for an excursion to Cathedral Falls, while spotting crocodiles and flying foxes. Alternatively fish the Prince Regent River which is renowned for big Barra and Threadfin Salmon.

## DAY 7: PRINCE REGENT RIVER, CAMP CREEK, CAREENING BAY

Wake early morning for your last chance to catch a Barra in the rich waters of the Prince Regent River. Visit Camp Creek, a beautiful waterway lined with weeping paperbarks where you can enjoy a walk to the top of the falls for another memorable swim. In the afternoon we cruise out of the Prince Regent River and visit Careening Bay, site of an ancient boab tree first visited in 1820 by Phillip Parker King. Relax on board to another spectacular sunset as the sun sinks below the Kimberley horizon, while we cross Prince Frederick Harbour towards the Hunter River.

## DAY 8: HUNTER RIVER - BROOME

In the morning we explore the spectacular Hunter River, one of the most scenic rivers for a relaxing ride in the tenders as we spot ancient rock art, crocodiles and flying foxes, taking in the flora and fauna of the Kimberley for the last time.

Depart the Kimberley Quest II by helicopter where you will enjoy a scenic flight over the Mitchell Falls. At the Mitchell Plateau airstrip you will board a light aircraft and discover the immensity of the Kimberley.

Return to Broome by sunset where our team will transfer you to your accommodation or airport.

### Please Note:

This is only a suggested itinerary. The remote Kimberley region experiences large tidal movements which can affect our itinerary. We may need to vary this from time to time, however, no matter the tides, we always visit the spectacular icons of this region. There will be plenty of land and sightseeing excursions to many untouched places, and opportunities to catch fresh fish for the table. Please note scenic helicopter flights are available on request.



# Wild Earth Travel

*Small Ships, Big Adventures*

**wildearth-travel.com**

**info@wildearth-travel.com**

## YOUR SHIP: KIMBERLEY QUEST II

|                            |                           |
|----------------------------|---------------------------|
| <b>YOUR SHIP:</b>          | <b>Kimberley Quest II</b> |
| <b>VESSEL TYPE:</b>        | <b>Luxury Expedition</b>  |
| <b>LENGTH:</b>             | <b>24 metres</b>          |
| <b>PASSENGER CAPACITY:</b> | <b>18</b>                 |
| <b>BUILT/REFURBISHED:</b>  | <b>2005</b>               |

The Kimberley Quest II has been designed for relaxing and exploring the Kimberley coastline in complete comfort and style. This custom-built vessel is fully air-conditioned, equipped with a helipad, spa, large en-suited cabins and offers indoor and outdoor alfresco areas so there will always be plenty of room to take in the panoramic scenery and breathtaking sunsets. Whilst on board take advantage of the extensive library, including a fantastic array of Kimberley reference books and general interest novels, otherwise sit with the Captain in the wheelhouse and learn more about the Kimberley outback.

Accommodating just 18 passengers and 6 crew, your holiday of a lifetime can be enjoyed with fellow travellers in luxurious and intimate surrounds. You have the choice of 9 cabins from deluxe twin, double, superior and the exclusive flybridge. All cabins feature private ensuites, individual air-conditioning, viewing windows, mini-refrigerators and are serviced daily by your hostess.

Carrying three excursion tenders, days are filled with a myriad of activities both on and off land, exploring the spectacular region with your very own local guide who has extensive knowledge of the Kimberley coastline. During your cruise you are free to do as

much or as little as you wish and can be sure that your Kimberley Cruise with us will exceed your expectations!



pectations!

# Wild Earth Travel

*Small Ships, Big Adventures*

[wildearth-travel.com](http://wildearth-travel.com)

[info@wildearth-travel.com](mailto:info@wildearth-travel.com)

## INSIDE YOUR SHIP

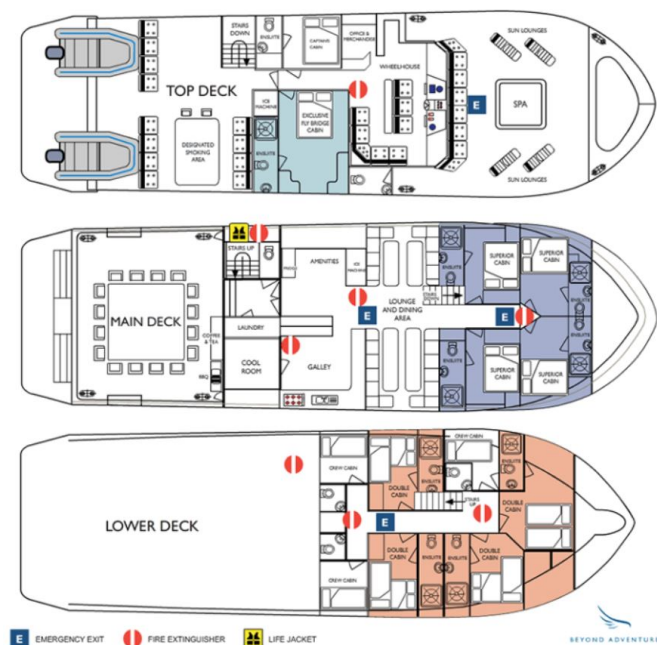

Double Cabin



Flybridge Cabin



Superior Cabin



Wild Earth Travel  
*Small Ships, Big Adventures*

0800 945 3327 (within New Zealand) | +64 (0) 3 365 1355 | 1800 107 715 (within Australia)

[info@wildearth-travel.com](mailto:info@wildearth-travel.com) | [wildearth-travel.com](http://wildearth-travel.com)



# Wild Earth Travel

*Small Ships, Big Adventures*

[wildearth-travel.com](http://wildearth-travel.com)

[info@wildearth-travel.com](mailto:info@wildearth-travel.com)

## PRICING

### 08-Jul-2025 to 15-Jul-2025

|                 |              |
|-----------------|--------------|
| Double Cabin    | 14990 AUD pp |
| Superior Cabin  | 16990 AUD pp |
| Flybridge Cabin | 18490 AUD pp |

### 15-Jul-2025 to 22-Jul-2025

|                 |              |
|-----------------|--------------|
| Double Cabin    | 14990 AUD pp |
| Superior Cabin  | 16990 AUD pp |
| Flybridge Cabin | 18490 AUD pp |

### 29-Jul-2025 to 05-Aug-2025

|                 |              |
|-----------------|--------------|
| Double Cabin    | 14990 AUD pp |
| Superior Cabin  | 16990 AUD pp |
| Flybridge Cabin | 18490 AUD pp |

### 05-Aug-2025 to 12-Aug-2025

|                 |              |
|-----------------|--------------|
| Double Cabin    | 14990 AUD pp |
| Superior Cabin  | 16990 AUD pp |
| Flybridge Cabin | 18490 AUD pp |

### 12-Aug-2025 to 19-Aug-2025

|                 |              |
|-----------------|--------------|
| Double Cabin    | 14990 AUD pp |
| Superior Cabin  | 16990 AUD pp |
| Flybridge Cabin | 18490 AUD pp |

### 19-Aug-2025 to 26-Aug-2025

|                 |              |
|-----------------|--------------|
| Double Cabin    | 14990 AUD pp |
| Superior Cabin  | 16990 AUD pp |
| Flybridge Cabin | 18490 AUD pp |

### 26-Aug-2025 to 02-Sep-2025

|                 |              |
|-----------------|--------------|
| Double Cabin    | 14990 AUD pp |
| Superior Cabin  | 16990 AUD pp |
| Flybridge Cabin | 18490 AUD pp |

### 02-Sep-2025 to 09-Sep-2025

|                 |              |
|-----------------|--------------|
| Double Cabin    | 14990 AUD pp |
| Superior Cabin  | 16990 AUD pp |
| Flybridge Cabin | 18490 AUD pp |

### 26-May-2026 to 02-Jun-2026

|                 |              |
|-----------------|--------------|
| Double Cabin    | 14990 AUD pp |
| Superior Cabin  | 16990 AUD pp |
| Flybridge Cabin | 18490 AUD pp |

### 02-Jun-2026 to 09-Jun-2026

|                 |              |
|-----------------|--------------|
| Double Cabin    | 14990 AUD pp |
| Superior Cabin  | 16990 AUD pp |
| Flybridge Cabin | 18490 AUD pp |

### 09-Jun-2026 to 16-Jun-2026

|                 |              |
|-----------------|--------------|
| Double Cabin    | 14990 AUD pp |
| Superior Cabin  | 16990 AUD pp |
| Flybridge Cabin | 18490 AUD pp |

### 16-Jun-2026 to 23-Jun-2026

|                 |              |
|-----------------|--------------|
| Double Cabin    | 14990 AUD pp |
| Superior Cabin  | 16990 AUD pp |
| Flybridge Cabin | 18490 AUD pp |

# Wild Earth Travel

*Small Ships, Big Adventures*

**wildearth-travel.com**

**info@wildearth-travel.com**

## PRICING

### 23-Jun-2026 to 30-Jun-2026

|                 |              |
|-----------------|--------------|
| Double Cabin    | 14990 AUD pp |
| Superior Cabin  | 16990 AUD pp |
| Flybridge Cabin | 18490 AUD pp |

### 30-Jun-2026 to 07-Jul-2026

|                 |              |
|-----------------|--------------|
| Double Cabin    | 14990 AUD pp |
| Superior Cabin  | 16990 AUD pp |
| Flybridge Cabin | 18490 AUD pp |

### 07-Jul-2026 to 14-Jul-2026

|                 |              |
|-----------------|--------------|
| Double Cabin    | 14990 AUD pp |
| Superior Cabin  | 16990 AUD pp |
| Flybridge Cabin | 18490 AUD pp |

### 04-Aug-2026 to 11-Aug-2026

|                 |              |
|-----------------|--------------|
| Double Cabin    | 14990 AUD pp |
| Superior Cabin  | 16990 AUD pp |
| Flybridge Cabin | 18490 AUD pp |

### 11-Aug-2026 to 18-Aug-2026

|                 |              |
|-----------------|--------------|
| Double Cabin    | 14990 AUD pp |
| Superior Cabin  | 16990 AUD pp |
| Flybridge Cabin | 18490 AUD pp |

### 18-Aug-2026 to 25-Aug-2026

|                 |              |
|-----------------|--------------|
| Double Cabin    | 14990 AUD pp |
| Superior Cabin  | 16990 AUD pp |
| Flybridge Cabin | 18490 AUD pp |

### 25-Aug-2026 to 01-Sep-2026

|                 |              |
|-----------------|--------------|
| Double Cabin    | 14990 AUD pp |
| Superior Cabin  | 16990 AUD pp |
| Flybridge Cabin | 18490 AUD pp |

### 01-Sep-2026 to 08-Sep-2026

|                 |              |
|-----------------|--------------|
| Double Cabin    | 14990 AUD pp |
| Superior Cabin  | 16990 AUD pp |
| Flybridge Cabin | 18490 AUD pp |

### 08-Sep-2026 to 15-Sep-2026

|                 |              |
|-----------------|--------------|
| Double Cabin    | 14990 AUD pp |
| Superior Cabin  | 16990 AUD pp |
| Flybridge Cabin | 18490 AUD pp |