

Wild Earth Travel

Small Ships, Big Adventures

wildearth-travel.com

info@wildearth-travel.com

SOUTHERN FIORDS NEW ZEALAND CRUISE

Explore Doubtful, Breaksea and Dusky Sounds, including Preservation and Chalky Inlets, aboard the Fiordland Jewel

Soak in the atmosphere and pristine wilderness of New Zealand's largest National Park on this six-night expedition. Part of the Te Wahipounamu World Heritage site, Fiordland's Doubtful, Breaksea and Dusky Sounds are rich in history and spectacular scenery. Experience the area's native birds and sea life up close and personal, with opportunities for kayaking, short walks and fishing to catch a feed, if you so wish, from our purpose-built catamaran, the Fiordland Jewel.

With a maximum of just 18 passengers onboard, there will be many opportunities to soak up stories of the area from our knowledgeable crew, and to take in breathtaking vistas from the deck or from any of our nine climate-controlled cabins, all of which have sea views and private ensuites. Relax in the hot tub on the top deck and enjoy all your meals prepared by our talented onboard chef.

Individual cabins can be booked for yourself, your small group of family and friends, or as a couple, for an experience you'll be talking about for years to come.



rs to come.

ITINERARY

Wild Earth Travel

Small Ships, Big Adventures

0800 945 3327 (within New Zealand) | +64 (0) 3 365 1355 | **1800 107 715** (within Australia)

info@wildearth-travel.com | **wildearth-travel.com**



Wild Earth Travel

Small Ships, Big Adventures

wildearth-travel.com

info@wildearth-travel.com

DAY 1

Fly via helicopter from Te Anau and land directly onboard the Fiordland Jewel which will be waiting in Preservation Inlet or Dusky Sound..

DAY 2-5

Cruise through Breaksea, Dusky Sounds, and Preservation and Chalky Inlets. We may do activities such as:

Bush, island and beach walks including the most south-westerly point of the South Island, Puysegur Point

Visit historic Captain Cook and Gold Rush sites

View incredible wildlife - Dusky Sound and its surrounding fiords are havens for marine and bird life

Some fishing to catch a feed, if you wish to do so

Kayaking and tender boat excursions

DAY 6-7

We'll start to head back north through Breaksea and Doubtful Sounds. At Doubtful Sound on Day 7, you'll disembark and take a coach over the Wilmot Pass, a boat over Lake Manapouri to return to Manapouri.

Please note:

Of course, the weather is central to a Fiordland experience, so the itinerary of your cruise may differ depending on the conditions on the day. The above sample itinerary is from Preservation Inlet ending in Doubtful Sound, Doubtful Sound to Preservation Inlet is in reverse.

Wild Earth Travel

Small Ships, Big Adventures

wildearth-travel.com

info@wildearth-travel.com

YOUR SHIP: FIORDLAND JEWEL

YOUR SHIP:	Fiordland Jewel
VESSEL TYPE:	Catamaran
LENGTH:	24 metres
PASSENGER CAPACITY:	18-20
BUILT/REFURBISHED:	

The Fiordland Jewel is a 24m, three-deck catamaran with a high quality 5-star marine fit-out. Our Milford Sound Overnight Cruise sleeps 20 passengers a night and on our Fiordland and Stewart Island private charters and our small group scenic boat expeditions we cater to a maximum of 18 passengers in nine climate-controlled cabins, each with their own ensuite bathroom.

Features :

Helicopter pad.

Top-deck hot tub.

Cabin information:

1 x Governor Cabin. At the top of the boat all by itself with its own full width forward window and large side windows. Super-King double bed, the ensuite has a separate shower and toilet.

4 x Captain Cook Cabins. All on the main deck all with sea views. Super-King double bed, each ensuite has a separate shower and toilet.

2 x Endeavour Cabins. Both on the main deck both with sea views. King single beds, each ensuite has a separate shower and toilet.

2 x Resolution Cabins. Both on the main deck both with sea views. 2 single bunks single beds, each ensuite has a combined shower and toilet.



and toilet.

Wild Earth Travel

Small Ships, Big Adventures

0800 945 3327 (within New Zealand) | +64 (0) 3 365 1355 | **1800 107 715** (within Australia)

info@wildearth-travel.com | **wildearth-travel.com**

Wild Earth Travel

Small Ships, Big Adventures

wildearth-travel.com

info@wildearth-travel.com

INSIDE YOUR SHIP

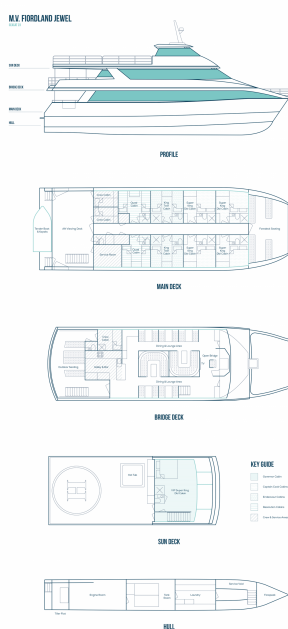

Captain Cook Deluxe King



Endeavour Deluxe Twin



Governor Suite Executive King



Resolution Deluxe Quadruple



Wild Earth Travel
Small Ships, Big Adventures

0800 945 3327 (within New Zealand) | +64 (0) 3 365 1355 | 1800 107 715 (within Australia)

info@wildearth-travel.com | wildearth-travel.com

Wild Earth Travel

Small Ships, Big Adventures

wildearth-travel.com

info@wildearth-travel.com

PRICING

27-May-2025 to 02-Jun-2025

Resolution Deluxe Quadruple	4750 NZD pp
Captain Cook Deluxe King	7500 NZD pp
Endeavour Deluxe Twin	7500 NZD pp
Governor Suite Executive King	9000 NZD pp

02-Jun-2025 to 08-Jun-2025

Resolution Deluxe Quadruple	4750 NZD pp
Endeavour Deluxe Twin	7500 NZD pp
Captain Cook Deluxe King	7500 NZD pp
Governor Suite Executive King	9000 NZD pp

14-Jun-2025 to 20-Jun-2025

Resolution Deluxe Quadruple	4750 NZD pp
Endeavour Deluxe Twin	7500 NZD pp
Captain Cook Deluxe King	7500 NZD pp
Governor Suite Executive King	9000 NZD pp

01-Sep-2025 to 07-Sep-2025

Resolution Deluxe Quadruple	4750 NZD pp
Captain Cook Deluxe King	7500 NZD pp
Endeavour Deluxe Twin	7500 NZD pp
Governor Suite Executive King	9000 NZD pp

07-Sep-2025 to 13-Sep-2025

Resolution Deluxe Quadruple	4750 NZD pp
Captain Cook Deluxe King	7500 NZD pp
Endeavour Deluxe Twin	7500 NZD pp
Governor Suite Executive King	9000 NZD pp

19-Sep-2025 to 25-Sep-2025

Resolution Deluxe Quadruple	4750 NZD pp
Captain Cook Deluxe King	7500 NZD pp
Endeavour Deluxe Twin	7500 NZD pp
Governor Suite Executive King	9000 NZD pp

25-Sep-2025 to 01-Oct-2025

Resolution Deluxe Quadruple	4750 NZD pp
Captain Cook Deluxe King	7500 NZD pp
Endeavour Deluxe Twin	7500 NZD pp
Governor Suite Executive King	9000 NZD pp

01-Oct-2025 to 07-Oct-2025

Resolution Deluxe Quadruple	4750 NZD pp
Endeavour Deluxe Twin	7500 NZD pp
Captain Cook Deluxe King	7500 NZD pp
Governor Suite Executive King	9000 NZD pp

07-Oct-2025 to 13-Oct-2025

Resolution Deluxe Quadruple	4750 NZD pp
Captain Cook Deluxe King	7500 NZD pp
Endeavour Deluxe Twin	7500 NZD pp
Governor Suite Executive King	9000 NZD pp

Wild Earth Travel

Small Ships, Big Adventures

wildearth-travel.com

info@wildearth-travel.com

PRICING

13-Oct-2025 to 19-Oct-2025

Resolution Deluxe Quadruple	4750 NZD pp
Endeavour Deluxe Twin	7500 NZD pp
Captain Cook Deluxe King	7500 NZD pp
Governor Suite Executive King	9000 NZD pp

26-May-2026 to 01-Jun-2026

Resolution Deluxe Quadruple	4750 NZD pp
Captain Cook Deluxe King	7500 NZD pp
Endeavour Deluxe Twin	7500 NZD pp
Governor Suite Executive King	9000 NZD pp

01-Jun-2026 to 07-Jun-2026

Resolution Deluxe Quadruple	4750 NZD pp
Captain Cook Deluxe King	7500 NZD pp
Endeavour Deluxe Twin	7500 NZD pp
Governor Suite Executive King	9000 NZD pp

Optional extras & upgrades

Return transfers from Queenstown 200 NZD