

# Wild Earth Travel

*Small Ships, Big Adventures*

[wildearth-travel.com](http://wildearth-travel.com)

[info@wildearth-travel.com](mailto:info@wildearth-travel.com)

## SOUTH GREENLAND EXPLORATION: FJORDS, WATERFALLS, AND FISHING VILLAGES

Blanketed in ice and carved by glaciers, Greenland is a dazzling tableau of the Arctic's epic glory. Witness the centuries of tradition and ingenuity of Arctic farmers, from the ruins of Brattahlíð, the estate of Eric the Red, to the modern landscape of Kujataa, the UNESCO World Heritage region of Southern Greenland. Explore these storied fjords as the ship cruises through the dramatic cliffs of Prins Christian Sund and Skjoldungen Island, and experience them up close through hikes and kayaking alongside locals. This is an expedition deep into wilderness, rich Inuit culture, and Norse lore.



### ITINERARY

#### DAY 1 Reykjavik, Iceland

Arrive in Reykjavik. Upon arrival, visit the Perlan Natural History museum for breakfast and an introduction to the flora, fauna, and geology of the Island. This afternoon, enjoy lunch and the option to visit the country's National Museum at your own pace.

#### DAY 2 Reykjavik, / Kangerlussuaq, Greenland / Embark

Enjoy the morning at leisure. After lunch, transfer to the airport for a chartered flight to Greenland and embark our ship at the head of Kangerlussuaq Fjord, a 120-mile-long waterway whose name means "large fjord" in Greenlandic. Meals Included: Breakfast, Lunch, Dinner

Wild Earth Travel

*Small Ships, Big Adventures*

0800 945 3327 (within New Zealand) | +64 (0) 3 365 1355 | 1800 107 715 (within Australia)

[info@wildearth-travel.com](mailto:info@wildearth-travel.com) | [wildearth-travel.com](http://wildearth-travel.com)



# Wild Earth Travel

*Small Ships, Big Adventures*

**wildearth-travel.com**

**info@wildearth-travel.com**

## DAY 3 Nuuk

Perched on the seaside in the shadow of ice-capped Sermitsiaq Mountain, Nuuk is the world's smallest capital city by population, with some 18,000 inhabitants. Watch for harp seals as we enter the harbor and take a walking tour with local residents to learn how the community has changed over the generations. At the National Museum, examine the extraordinary 15th-century Qilakitsoq mummies found near Uummannaq—a discovery that was featured in a National Geographic magazine cover story in 1985. The Arctic ice preserved these mummies so well that researchers have been able to study their tattoos, their medical conditions, and even what they ate. Meals Included: Breakfast, Lunch, Dinner

## DAY 4 Paamiut and Kuannersooq Fjord

Lying at the unofficial boundary between western and southern Greenland, Paamiut serves as the gatekeeper to a fjord system filled with hundreds of islands, multiple fjords and bays, as well as terminal glaciers stretching out from the Greenlandic ice sheet. Enjoy an exploration day in these fjords, on the lookout for a view of the ice sheet and wildlife that calls the fjords home, such as fin whales and sea eagles. Meals Included: Breakfast, Lunch, Dinner

## DAY 5 At Sea / Tunulliarfik Fjord

Today we sail along the southeastern coast of Greenland from the "Western Settlement" to the "Eastern Settlement" areas of the Vikings in Greenland. Follow the waterway known as Tunulliarfik to Brattahlíð, where Erik the Red established his farm in 982 AD after his exile from Iceland. Erik's wife, Þjodhild, built the first Christian church in the western hemisphere here. Visit replicas of the church and Erik the Red's longhouse and see the shores from which their son, Leif Eriksson, launched the first voyages to North America—500 years before Columbus. Meals Included: Breakfast, Lunch, Dinner

## DAY 6 Qaqortoq

Our exploration of Erik the Red's Eastern Settlement continues in the fjords around Qaqortoq. The Sissarluttoq World Heritage Center is dotted with ruins

of Inuit and Norse farm, stables, and storerooms made of sandstone and granite blocks, allowing you to imagine what farming was like on the edge of the ice cap over 1,000 years ago. Explore the ruins of the 14th-century Hvalsey Church and venture deep into the fjord to witness how these ancient remnants create the backdrop for daily farming life in southern Greenland. Continue to Qaqortoq, inhabited since the Viking era and now the largest town in South Greenland with just over 3,200 residents. Stroll through the town square and visit the museum, where Greenlandic kayaks, hunting equipment, and local art and handicrafts are on display. Sample traditional Greenlandic food this afternoon. Meals Included: Breakfast, Lunch, Dinner

## DAY 7 Nanortalik / Tasermuit Fjord

After we anchor off the small fishing village of Nanortalik, go ashore to explore Greenland's most southerly town and meet some of the residents for a performance of local folk music and dance. Visit reconstructed longhouses and learn about the construction of traditional umiaks and kayaks. Meals Included: Breakfast, Lunch, Dinner

## DAY 8 Southeastern Greenland Fjords

Sail through the dramatic fjords of Prins Christian Sund, marked with retreated glaciers, as we make our way through the southern fjords to the eastern shores of Greenland. The Greenland ice sheet is the second largest body of ice in the world after Antarctica and covers roughly 80% of Greenland's surface. The island's coast is etched with thousands of fjords which play host to calving glaciers and ice flows. Spend the day exploring the islands and inlets of the eastern coast, using our underwater cameras and Remotely Operated Vehicle (ROV) to discover marine life and fascinating underwater geology. Venture deep into Skjoldungen Fjord and take a Zodiac or a kayak for a foray among the icebergs. Meals Included: Breakfast, Lunch, Dinner

## DAY 9 Crossing the Denmark Strait

Sail away from the shores of Greenland as we voyage across the Denmark Strait to the Westfjords of Iceland. Known as the world's largest waterfall, the Denmark Strait contains underwater cataracts that fall as deep as 10,000 feet as the cold Arctic water sinks below warmer water flowing northward. Listen to talks by our experts, review your expedition photos with our Certified Photo Instructors, or enjoy the observation deck and keep an eye out for wildlife.

Wild Earth Travel  
*Small Ships, Big Adventures*

**0800 945 3327** (within New Zealand) | +64 (0) 3 365 1355 | **1800 107 715** (within Australia)

info@wildearth-travel.com | wildearth-travel.com



Meals Included: Breakfast, Lunch, Dinner

#### DAY 10 Snaefellsnes Peninsula, Iceland

Arrive at the Snaefellsnes Peninsula today, known for its volcanic landscape, colorful fishing villages, and breathtaking waterfalls. Visit the Kirkjufellsfoss waterfall for a breathtaking view of Kirkjufell, one of the most photographed mountains in Iceland. Meals Included: Breakfast, Lunch, Dinner

#### DAY 11 Reykjavík / Disembark Ship

Today we complete our voyage, disembarking the ship in the Icelandic capital of Reykjavik for the transfer to the airport and flights home. Meals Included: Breakfast

#### Please Note:

Itineraries are subject to change.

# Wild Earth Travel

*Small Ships, Big Adventures*

[wildearth-travel.com](http://wildearth-travel.com)

[info@wildearth-travel.com](mailto:info@wildearth-travel.com)

## YOUR SHIP: NATIONAL GEOGRAPHIC ENDURANCE

<b>YOUR SHIP:</b>	<b>National Geographic Endurance</b>
<b>VESSEL TYPE:</b>	<b>Expedition Ship</b>
<b>LENGTH:</b>	<b>124 m</b>
<b>PASSENGER CAPACITY:</b>	<b>126</b>
<b>BUILT/REFURBISHED:</b>	<b>2020</b>

National Geographic Endurance is a state-of-the-art expedition vessel purpose-built for year-round polar navigation. Named in honour of Sir Ernest Shackleton's legendary Endurance expedition, she is the first polar ship in Lindblad's history designed from the keel up for exploration. With an ice-class rating of PC5 (Category A) and a fully stabilised hull, she grants access to remote and often uncharted corners of the Arctic and Antarctica in exceptional comfort and safety.

Her revolutionary X-Bow®--a striking forward-leaning design--enables superior wave-cutting performance, ensuring a smoother, quieter ride and minimising spray on deck for better wildlife observation. On board, guests enjoy thoughtfully designed public spaces including a wraparound observation lounge, library, and an expedition base for gear and briefings. Dining is offered across three flexible venues, all serving sustainable, locally inspired cuisine. With a full suite of tools for exploration and a design deeply rooted in expedition heritage, Endurance is the ultimate platform for discovering Earth's most remote regions.



Wild Earth Travel

*Small Ships, Big Adventures*

**0800 945 3327** (within New Zealand) | +64 (0) 3 365 1355 | **1800 107 715** (within Australia)

[info@wildearth-travel.com](mailto:info@wildearth-travel.com) | [wildearth-travel.com](http://wildearth-travel.com)



**Wild Earth Travel**  
*Small Ships, Big Adventures*

**wildearth-travel.com**

**info@wildearth-travel.com**

**INSIDE YOUR SHIP**

Observation Deck

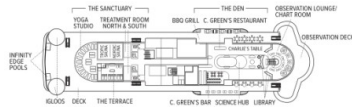

Bridge Deck

- Category 5
- Category 6
- Category 7



Lounge Deck

- Category 4
- Category B Solo



Main Deck

- Category 3
- Category 2 Solo



Fore Deck

- Category 1
- Category 2



Expedition Deck



Category 1



Category 2



Category 3



Category 4



Category 5



Category 6



Category 7



Suite A Solo



**Wild Earth Travel**  
*Small Ships, Big Adventures*

**0800 945 3327** (within New Zealand) | +64 (0) 3 365 1355 | **1800 107 715** (within Australia)

info@wildearth-travel.com | wildearth-travel.com



# Wild Earth Travel

*Small Ships, Big Adventures*

**wildearth-travel.com**      **info@wildearth-travel.com**

## PRICING

### 27-Jul-2025 to 06-Aug-2025

Category 1	17800 AUD pp
Category 2	18290 AUD pp
Category 3	22310 AUD pp
Category 4	24530 AUD pp
Category 5	27220 AUD pp
Suite A Solo	27780 AUD pp
Suite B Solo	30580 AUD pp
Category 6	31190 AUD pp
Category 7	34610 AUD pp

### 18-Aug-2025 to 28-Aug-2025

Category 1	17270 AUD pp
Category 2	17750 AUD pp
Category 3	21650 AUD pp
Category 4	23800 AUD pp
Suite A Solo	25910 AUD pp
Category 5	26410 AUD pp
Category 6	30260 AUD pp
Suite B Solo	32470 AUD pp
Category 7	33570 AUD pp



## SPECIAL OFFERS

### **\*\*SUITE EXCLUSIVES\*\***

Spacious living areas and incredible views immerse you in the beauty of your marine surroundings. Our new Suite Exclusives package helps make your voyage all the more memorable.

### **\*\*BAR TAB & CREW TIPS INCLUDED\*\***

Your bar tab and tips to the ship's crew on all departures aboard National Geographic Endurance, National Geographic Resolution, National Geographic Orion, National Geographic Explorer, Sea Cloud, and Sea Cloud II are included in your fare. Bar tab excludes certain super premium brands, which are available for sale. Call for details.

### **\*\*10% OFF BACK-TO-BACK VOYAGES\*\***

Save 10% on consecutive departures, applicable on voyage fares only and not valid on extensions or airfare. Valid for new bookings only, subject to availability, and may not be combined with other offers. Call for details.

### **\*\*CELEBRATE LIFE'S MILESTONES\*\***

Celebrate a milestone with a group of eight or more and enjoy a special amenity package including: 5% savings on voyage fares, custom group photo, US\$150 shipboard credit for the group, and other special gifts. Milestone celebration to be communicated at time of booking. Valid for new bookings only on select departures, subject to availability, not applicable on airfare or extensions, and may not be combined with other offers. Deposit, final payments, and cancellation policies for group travel vary from our regular policies. Call for details.

### **\*\*SAVE 5% TRAVELING AS A GROUP\*\***

Save 5% when traveling as a group of eight or more people. Valid on voyage fares only and not applicable on extensions or airfare. Deposit, final payments, and cancellation policies for group travel vary from our regular policies. Valid for new bookings only, subject to availability, and may not be combined with other offers. Call for details.

### **\*\*BRINGING THE KIDS\*\***

We believe sharing an expedition with your kids or grandkids is a life-enhancing experience. So take \$625 off for each child under the age of 18.

### **\*\*COMBINING OFFERS\*\***

Combine now and save!

Certain offers may be combinable, up to two savings opportunities, except where noted otherwise. For example, travel with a group of 8 or more on back-to-back expeditions, and take advantage of both savings.



**0800 945 3327** (within New Zealand) | +64 (0) 3 365 1355 | **1800 107 715** (within Australia)

info@wildearth-travel.com | wildearth-travel.com