

# Wild Earth Travel

*Small Ships, Big Adventures*

**wildearth-travel.com**

**info@wildearth-travel.com**

## SCANDINAVIA AND THE BALTIC SEA: COASTS, ISLANDS, AND ARCHIPELAGOS EXPEDITION

The islands and archipelagos of Scandinavia and the Baltic Sea delight travelers with serene nature, idyllic villages, vibrant cities, and maritime history. Discover some of the highlights as you sail through this picturesque region once traversed by Viking ships and Hanseatic League merchants. Stroll into the past in places like Gamla Stan, Stockholm's colorful Old Town, UNESCO-designated Visby, or Mariehamn, "the town of a thousand Linden trees." Kayak and Zodiac past remote lighthouses in the Åland Islands and venture to Stora Karlsö, a bird-filled nature reserve which rests upon ancient coral reefs.



### ITINERARY

#### Day 1 Stockholm, Sweden / Embark Ship

Arrive in Stockholm and transfer to the city center. As the largest city in Scandinavia, the city offers a dynamic blend of culture, architecture, and history. Spend the day at your own pace taking in this world capital throughout the ages before embarking the ship this afternoon.

Meals Included: Dinner

#### Day 2 Stockholm Archipelago

Wild Earth Travel

*Small Ships, Big Adventures*

**0800 945 3327** (within New Zealand) | +64 (0) 3 365 1355 | **1800 107 715** (within Australia)

info@wildearth-travel.com | **wildearth-travel.com**

# Wild Earth Travel

*Small Ships, Big Adventures*

**wildearth-travel.com**

**info@wildearth-travel.com**

## Day 6 Stora Karlsö

This morning, wake up next to Gamla Stan, Stockholm's oldest district as you take advantage of the city's highlights and walk among the cobblestone streets, along the surrounding canals, or through the numerous public parks. Visit the Vasa Museum which houses the world's only preserved 17th century ship and hear from experts about its sister ship which was recently discovered in the Baltic Sea. This afternoon, enjoy one of the most iconic Scandinavian sailings as you navigate the Stockholm archipelago or "skargarden," watching local ferries crisscross the waterways and photographing the quaint cottages that line the shores.

Meals Included: Breakfast, Lunch, Dinner

## Days 3-4 Finnish Archipelago

The Finnish Archipelago, comprising more than 6,700 islands, is known for its slower pace, strong ties to the sea, and independent nature. Discover the Åland Islands, a fascinating autonomous region, as you explore from its capital of Mariehamn to the outer island of Uto. Visit remote lighthouses perched on red granite islands; navigate through coves and islands on Zodiacs and kayaks; explore the decks of the Pommern, a four-masted barque and one of the last of the Flying P-Liners; and walk Mariehamn's city streets to see why it's referred to as "the town of a thousand Linden trees."

Meals Included: Breakfast, Lunch, Dinner

## Day 5 Visby, Gotland

A former Viking site on the island of Gotland, the UNESCO-designated city of Visby is one of the best-preserved medieval cities in Scandinavia. Its history as a part of the Hanseatic League can still be witnessed in its two-mile-long city wall, cobblestone streets, and stone houses. Outside its walls, Gotland lures travelers with its rich history, striking nature, and a growing reputation for local crafts and goods. Spend the day exploring the island or follow the local lifestyle of slowing down and enjoying the rhythm of the Baltic Sea.

Meals Included: Breakfast, Lunch, Dinner

The second oldest nature reserve in the world after Yellowstone National Park, Stora Karlsö is a nature lovers' paradise. Composed of fossilized coral reefs formed over 400 million years ago, the scenery is one of the main draws of this "rock" in the middle of the Baltic Sea. It's home to the biggest bird cliffs in the Baltic, which teem with colonies of breeding guillemots and razorbills, and it's carpeted with an array of dazzling flowers, depending on the season. You'll be guided through this rich diversity by your naturalists as well as by the Reserve Rangers.

Meals Included: Breakfast, Lunch, Dinner

## Day 7 Bornholm, Denmark

Arrive at the island of Bornholm, a Danish island located in the Baltic Sea, between Sweden and Germany. Known for its local makers and crafters, Bornholm offers a relaxing atmosphere. Rønne, the capital of the island, is a market town dating back to 1327 and that creative mindset continues to grow in modern times. Spend the day getting to know the history, artists, and landscape of this Danish gem.

Meals Included: Breakfast, Lunch, Dinner

## Day 8 Copenhagen / Disembark Ship

Disembark in Copenhagen and transfer to the airport for flights home.

Meals Included: Breakfast

### Please note:

Itineraries are subject to change.

Wild Earth Travel

*Small Ships, Big Adventures*

**0800 945 3327** (within New Zealand) | +64 (0) 3 365 1355 | **1800 107 715** (within Australia)

info@wildearth-travel.com | wildearth-travel.com



# Wild Earth Travel

*Small Ships, Big Adventures*

[wildearth-travel.com](http://wildearth-travel.com)

[info@wildearth-travel.com](mailto:info@wildearth-travel.com)

## YOUR SHIP: NATIONAL GEOGRAPHIC ENDURANCE

<b>YOUR SHIP:</b>	<b>National Geographic Endurance</b>
<b>VESSEL TYPE:</b>	<b>Expedition Ship</b>
<b>LENGTH:</b>	<b>124 m</b>
<b>PASSENGER CAPACITY:</b>	<b>126</b>
<b>BUILT/REFURBISHED:</b>	<b>2020</b>

National Geographic Endurance is a state-of-the-art expedition vessel purpose-built for year-round polar navigation. Named in honour of Sir Ernest Shackleton's legendary Endurance expedition, she is the first polar ship in Lindblad's history designed from the keel up for exploration. With an ice-class rating of PC5 (Category A) and a fully stabilised hull, she grants access to remote and often uncharted corners of the Arctic and Antarctica in exceptional comfort and safety.

Her revolutionary X-Bow®--a striking forward-leaning design--enables superior wave-cutting performance, ensuring a smoother, quieter ride and minimising spray on deck for better wildlife observation. On board, guests enjoy thoughtfully designed public spaces including a wraparound observation lounge, library, and an expedition base for gear and briefings. Dining is offered across three flexible venues, all serving sustainable, locally inspired cuisine. With a full suite of tools for exploration and a design deeply rooted in expedition heritage, Endurance is the ultimate platform for discovering Earth's most remote regions.



Wild Earth Travel

*Small Ships, Big Adventures*

**0800 945 3327** (within New Zealand) | +64 (0) 3 365 1355 | **1800 107 715** (within Australia)

[info@wildearth-travel.com](mailto:info@wildearth-travel.com) | [wildearth-travel.com](http://wildearth-travel.com)

# Wild Earth Travel

*Small Ships, Big Adventures*

[wildearth-travel.com](http://wildearth-travel.com)

[info@wildearth-travel.com](mailto:info@wildearth-travel.com)

## INSIDE YOUR SHIP

### Observation Deck

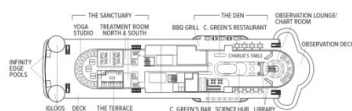

### Bridge Deck

- Category 5
- Category 6
- Category 7



### Lounge Deck

- Category 4
- Category B Solo



### Main Deck

- Category 3
- Category 2 Solo



### Fore Deck

- Category 1
- Category 2



### Expedition Deck







# Wild Earth Travel

*Small Ships, Big Adventures*



**wildearth-travel.com**

**info@wildearth-travel.com**

## PRICING

---



Wild Earth Travel

*Small Ships, Big Adventures*

**0800 945 3327** (within New Zealand) | +64 (0) 3 365 1355 | **1800 107 715** (within Australia)

info@wildearth-travel.com | **wildearth-travel.com**