



Wild Earth Travel

Small Ships, Big Adventures

wildearth-travel.com

info@wildearth-travel.com

DAY 1

Your adventure will start in Manapouri at 12.30pm with a boat transfer across Lake Manapouri to West Arm, where you will change to a coach to travel over the Wilmot Pass. Here you will capture breathtaking vistas of Doubtful Sound and the surrounding Mountains. You will board the Fiordland Jewel at Deep Cove. After meeting the crew and settling into your cabins you can relax and take in the sensational surrounds and discover untouched landscapes thriving with an abundance of wildlife. Doubtful Sound is defined by lush rainforests clinging to dramatic peaks. Waterfalls are also gloriously abundant in the area.

before returning to the terminal at 9.00am. Van transfer back to your vehicle in Manapouri (included).

Please Note:

Of course, the weather is central to a Fiordland experience, so the itinerary of your cruise may differ depending on the conditions on the day. The above sample itinerary is from Doubtful Sound ending in Milford Sound, Milford Sound to Doubtful Sound is in reverse.

DAY 2-5

We cruise the arms and view the islands of Doubtful Sound and at some stage, depending on the weather, we head towards Nancy Sound and spend the next few days visiting Caswell, George and Bligh Sounds. We may do activities such as: View incredible wildlife - keep an eye out for bottlenose dolphins and fur seals, on rare occasions we may encounter whales Spot birds such as the rare and captivating Fiordland crested penguin, New Zealand falcons, white-faced herons, white herons, cattle egrets, a variety of shags and the common black-backed gull. On our short sea passages we frequently see Albatross including the Royal Albatross which has the longest wingspan in the world. Some fishing to catch a feed, if you wish to do so Kayaking and tender boat excursions Stargazing on clear evenings as the unpolluted sky is full of stars and our top deck is the perfect viewing platform, perhaps one night you will be able to do this whilst relaxing in our top-deck hot tub!

DAY 6

Enter the magnificent Milford Sound Cruise past Bowen Falls, Sinbad Gully, the world-renowned Mitre Peak, Mt Pembroke, Bridal Veil Falls and Fairy Falls then we venture up the north side of the fiord past Dale Point, the Piopiotahi Marine Reserve, Seal Rock, Stirling Falls, The Lion and the Cascade Range. After cruising, we anchor at Deepwater Basin for the night.

DAY 7

Watch the sunrise over continental breakfast, which is served from 7am-8am,



0800 945 3327 (within New Zealand) | +64 (0) 3 365 1355 | **1800 107 715** (within Australia)

info@wildearth-travel.com | **wildearth-travel.com**

Wild Earth Travel

Small Ships, Big Adventures

wildearth-travel.com

info@wildearth-travel.com

YOUR SHIP: FIORDLAND JEWEL

YOUR SHIP: **Fiordland Jewel**

VESSEL TYPE: **Catamaran**

LENGTH: **24 metres**

PASSENGER CAPACITY: **18-20**

BUILT/REFURBISHED:

The Fiordland Jewel is a 24m, three-deck catamaran with a high quality 5-star marine fit-out. Our Milford Sound Overnight Cruise sleeps 20 passengers a night and on our Fiordland and Stewart Island private charters and our small group scenic boat expeditions we cater to a maximum of 18 passengers in nine climate-controlled cabins, each with their own ensuite bathroom.

Features :

Helicopter pad.

Top-deck hot tub.

Cabin information:

1 x Governor Cabin. At the top of the boat all by itself with its own full width forward window and large side windows. Super-King double bed, the ensuite has a separate shower and toilet.

4 x Captain Cook Cabins. All on the main deck all with sea views. Super-King double bed, each ensuite has a separate shower and toilet.

2 x Endeavour Cabins. Both on the main deck both with sea views. King single beds, each ensuite has a separate shower and toilet.

2 x Resolution Cabins. Both on the main deck both with sea views. 2 single bunks single beds, each ensuite has a combined shower and toilet.



and toilet.

Wild Earth Travel

Small Ships, Big Adventures

0800 945 3327 (within New Zealand) | +64 (0) 3 365 1355 | **1800 107 715** (within Australia)

info@wildearth-travel.com | **wildearth-travel.com**

Wild Earth Travel

Small Ships, Big Adventures

wildearth-travel.com

info@wildearth-travel.com

INSIDE YOUR SHIP

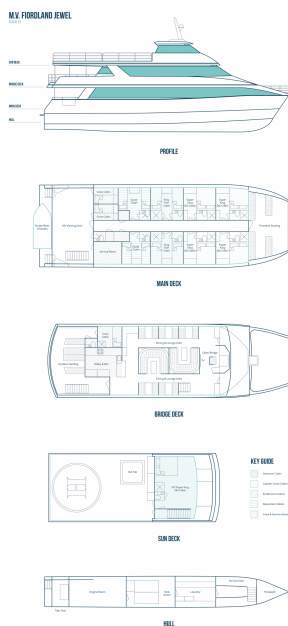

Captain Cook Deluxe King



Endeavour Deluxe Twin



Governor Suite Executive King



Resolution Deluxe Quadruple



Wild Earth Travel

Small Ships, Big Adventures

0800 945 3327 (within New Zealand) | +64 (0) 3 365 1355 | 1800 107 715 (within Australia)

info@wildearth-travel.com | wildearth-travel.com



Wild Earth Travel

Small Ships, Big Adventures

wildearth-travel.com

info@wildearth-travel.com

PRICING

20-Jun-2025 to 26-Jun-2025

Resolution Deluxe Quadruple	4450 NZD pp
Endeavour Deluxe Twin	7200 NZD pp
Captain Cook Deluxe King	7200 NZD pp
Governor Suite Executive King	8700 NZD pp

Wild Earth Travel

Small Ships, Big Adventures

0800 945 3327 (within New Zealand) | +64 (0) 3 365 1355 | **1800 107 715** (within Australia)

info@wildearth-travel.com | **wildearth-travel.com**