

Wild Earth Travel

Small Ships, Big Adventures

wildearth-travel.com

info@wildearth-travel.com

MONIQUE 8 DAY GALAPAGOS CRUISE B

Itinerary B offers an unforgettable 7-night cruise through the remote and wildlife-rich islands of the Galapagos. Beginning with iconic sites like the Charles Darwin Research Station and ending in the peaceful mangroves of Black Turtle Cove, each day is packed with up-close wildlife encounters, striking landscapes, and fascinating ecological insight. You'll walk among giant tortoises, snorkel with sea lions and rays, and witness dramatic bird colonies across a diverse range of island ecosystems.

This journey blends education, adventure, and natural beauty in one of the world's most protected and awe-inspiring destinations.

For shorter, 3- or 4-night cruises, please contact us.



ITINERARY

Day 1 – Baltra Airport & Charles Darwin Research Station (Santa Cruz Island)

After arriving at Baltra Airport, you'll be welcomed and transferred to M/C Monique.

In the afternoon, visit the Charles Darwin Research Station and tortoise breeding center, then head into the highlands of Santa Cruz to see giant tortoises in the wild and enjoy birdwatching in the lush landscape.

Day 2 – Post Office Bay & Cormorant Point (Floreana Island)

In the morning, explore Post Office Bay, where you can join a centuries-old tradition of mail exchange. Enjoy snorkeling, kayaking, and lava tunnel walks.

In the afternoon, visit Cormorant Point's unique green and white sand beaches, and watch for flamingos and other waterbirds around a nearby lagoon.

Day 3 – Punta Suarez & Gardner Bay (Española Island)

Wild Earth Travel

Small Ships, Big Adventures

0800 945 3327 (within New Zealand) | +64 (0) 3 365 1355 | **1800 107 715** (within Australia)

info@wildearth-travel.com | **wildearth-travel.com**



Wild Earth Travel

Small Ships, Big Adventures

wildearth-travel.com

info@wildearth-travel.com

Hike the rugged trail at Punta Suarez to encounter blue-footed boobies, marine iguanas, and waved albatrosses (in season).

In the afternoon, relax at Gardner Bay's soft white beach, swim or snorkel with sea lions, and explore coral reefs around Gardner and Osborn Islets.

Day 4 – Witch Hill, Kicker Rock & Interpretation Center (San Cristobal Island)

Begin with views of the iconic Kicker Rock, then enjoy swimming and snorkeling in the peaceful bay of Witch Hill.

Later, visit the San Cristobal Interpretation Center for an insightful overview of Galapagos geology, ecology, and conservation efforts.

Day 5 – Santa Fe & South Plaza Islands

In the morning, hike among giant cacti and endemic land iguanas on Santa Fe, followed by snorkeling in its calm bay.

In the afternoon, explore colorful South Plaza Island, where seabirds soar above dramatic cliffs and vivid succulents cover the ground.

Day 6 – Darwin Bay & El Barranco (Genovesa Island)

Disembark on Darwin Bay's coral beach, home to nesting frigatebirds and red-footed boobies.

In the afternoon, climb Prince Philip's Steps to a seabird-rich plateau and enjoy kayaking, snorkeling, or dinghy rides near fur seals and sharks.

Day 7 – Chinese Hat & Dragon Hill (Santa Cruz Island)

Snorkel or kayak around the striking lava formations of Chinese Hat, a small scenic islet off Santiago Island.

In the afternoon, hike Dragon Hill to spot land iguanas and flamingos, followed by offshore snorkeling in the nearby waters.

Day 8 – Black Turtle Cove & Departure (Santa Cruz Island)

Glide silently by dinghy through the mangrove-fringed waters of Black Turtle Cove, a peaceful haven for rays, sea turtles, and reef sharks.

After this serene finale, you'll be transferred to Baltra Airport for your return flight to mainland Ecuador.

Please note:

Itineraries are subject to change.

Wild Earth Travel

Small Ships, Big Adventures

wildearth-travel.com

info@wildearth-travel.com

YOUR SHIP: MONIQUE

YOUR SHIP:	Monique
VESSEL TYPE:	Premium Yacht
LENGTH:	
PASSENGER CAPACITY:	16
BUILT/REFURBISHED:	

Monique is one of the newest luxury catamarans cruising the Galapagos Islands, designed for intimate, immersive exploration. With space for just 16 guests and a nearly 1:1 crew-to-guest ratio, every journey aboard Monique is defined by personalized service and exceptional comfort. Three beautifully designed decks feature panoramic lounges, shaded observation areas, and spacious staterooms with sweeping ocean views. The ship is powered by 20 solar panels and 5 lithium batteries, offering a sustainable way to explore the pristine Galapagos environment. Guests can unwind in the outdoor whirlpool, relax with a drink at the sky deck bar, or enjoy al-fresco dining while surrounded by the region's dramatic landscapes.

Each itinerary aboard Monique takes travelers to some of the Galapagos' most iconic sites, including Santa Cruz, Isabela, Rabida, and Fernandina. From the birdlife of North Seymour to the volcanic beauty of Sullivan Bay, every stop reveals a new side of this extraordinary archipelago. Guided by expert naturalists, guests experience secluded beaches, rich wildlife habitats, and unforgettable moments of discovery. Dining onboard is a highlight, with the Epicure Cuisine Experience blending regional flavors, premium ingredients, and refined

presentation to reflect the richness of the journey itself. Whether on a 3-, 4-, or 7-night expedition, Monique offers an unmatched blend of adventure, luxury, and sustainability.



ainability.

Wild Earth Travel

Small Ships, Big Adventures

0800 945 3327 (within New Zealand) | +64 (0) 3 365 1355 | **1800 107 715** (within Australia)

info@wildearth-travel.com | **wildearth-travel.com**

Wild Earth Travel

Small Ships, Big Adventures

wildearth-travel.com

info@wildearth-travel.com

INSIDE YOUR SHIP

Main Deck

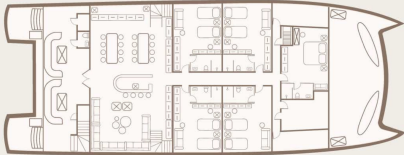

Upper Deck

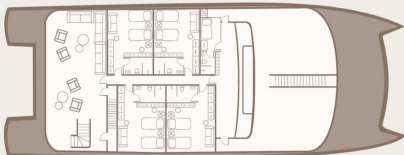

Sky Deck

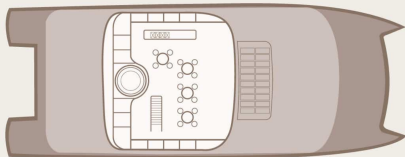

Golden Stateroom



Wild Earth Travel

Small Ships, Big Adventures

0800 945 3327 (within New Zealand) | +64 (0) 3 365 1355 | 1800 107 715 (within Australia)

info@wildearth-travel.com | wildearth-travel.com



Wild Earth Travel

Small Ships, Big Adventures

wildearth-travel.com

info@wildearth-travel.com

PRICING

02-Apr-2026 to 09-Apr-2026

Golden Stateroom	8290 USD pp
------------------	-------------

15-Oct-2026 to 22-Oct-2026

Golden Stateroom	8290 USD pp
------------------	-------------

16-Apr-2026 to 23-Apr-2026

Golden Stateroom	8290 USD pp
------------------	-------------

29-Oct-2026 to 05-Nov-2026

Golden Stateroom	8290 USD pp
------------------	-------------

14-May-2026 to 21-May-2026

Golden Stateroom	8290 USD pp
------------------	-------------

12-Nov-2026 to 19-Nov-2026

Golden Stateroom	8290 USD pp
------------------	-------------

11-Jun-2026 to 18-Jun-2026

Golden Stateroom	8290 USD pp
------------------	-------------

26-Nov-2026 to 03-Dec-2026

Golden Stateroom	8290 USD pp
------------------	-------------

09-Jul-2026 to 16-Jul-2026

Golden Stateroom	8290 USD pp
------------------	-------------

10-Dec-2026 to 17-Dec-2026

Golden Stateroom	8290 USD pp
------------------	-------------

23-Jul-2026 to 30-Jul-2026

Golden Stateroom	8290 USD pp
------------------	-------------

06-Aug-2026 to 13-Aug-2026

Golden Stateroom	8290 USD pp
------------------	-------------

20-Aug-2026 to 27-Aug-2026

Golden Stateroom	8290 USD pp
------------------	-------------

03-Sep-2026 to 10-Sep-2026

Golden Stateroom	8290 USD pp
------------------	-------------

17-Sep-2026 to 24-Sep-2026

Golden Stateroom	8290 USD pp
------------------	-------------

01-Oct-2026 to 08-Oct-2026

Golden Stateroom	8290 USD pp
------------------	-------------



Wild Earth Travel
Small Ships, Big Adventures

0800 945 3327 (within New Zealand) | +64 (0) 3 365 1355 | **1800 107 715** (within Australia)

info@wildearth-travel.com | wildearth-travel.com