



GALAPAGOS HORIZON 8 DAY CRUISE B

When is the best time to visit Galapagos? Galapagos is a place that can be visited at any time. There are two seasons, and the warmest is between December and May. It is the time of year when the sky is always clear, and the sun shines strongly. If you love to dive in amazing places, the best time to visit Galapagos is from June to November. During this season the weather is a little cooler, but it gives you the chance to enjoy the best from Galapagos' famous marine reserve. Good weather for visiting all year round. Galapagos is on the Equator, but the weather is not tropical. Temperatures range from 69°-84°F / 21°-30°C Very little rainfall. Warm season Dec-May. Dry season Jun-Nov.



ITINERARY

Day 1 Santiago Island

Morning flight from Quito or Guayaquil to Baltra, Galapagos Islands. You will arrive at Baltra Island in the morning. After passing through immigration and baggage claim, you will be met by a Horizon staff member and transferred to the yacht. You will be shown to your cabin where you will have some time to settle in before lunch and a welcome briefing. You will visit Sullivan Bay located on the southeast part of Santiago. This place is interesting for its geology because the area is covered by lava flows. This place has elevations in the form of small volcanoes formed by the lava flows.

Day 2 Isabela & Fernandina Islands

Comprised of two separate coves, Vicente Roca Point is a large bay with spectacular sea life. Keep an eye out for seahorses, sea turtles, and the strange yet fascinating Mola mola (or sun fish) while you snorkel. Crossing the Bolivar Channel that divides Isabela and Fernandina Islands, you will land at Espinoza Point, and after walking past a colony of marine iguanas and a group of sea lions, you will reach the island's highlight: the flightless cormorant nesting site. This area also provides a great opportunity to see the Galapagos



Wild Earth Travel

Small Ships, Big Adventures

wildearth-travel.com

info@wildearth-travel.com

hawk.

Day 3 Isabela Island

You will visit Tagus Cove on Isabela Island which is located across from Fernandina Island, near the Bolivar Channel dividing the two islands. This spot has been frequented by ships since the 1800s, using the area as an anchorage site. Trails winding by Lake Darwin up to a ridge display wonderful views. Urbina Bay is located at the base of Alcedo Volcano on the west coast between Tagus Cove and Elizabeth Bay. This area experienced a major uplift in 1954 causing the land to rise over 16 feet. The coast expanded half a mile out leaving marine life stranded on the new shore. This area is also a great place for snorkeling.

Day 4 Isabela Island

Elizabeth Bay is located on the east coast of Isabela Island. The bay contains many islets, which can be visited by dinghy. Penguins and blue-footed boobies can be spotted on the rocky islets. With an abundance of marine life and clear water, the area is perfect for snorkeling and viewing schools of colorful fish, sea lions, and perhaps even sharks. Moreno Point is located southwest of Elizabeth Bay. Here a dry landing onto what was once flowing lava is possible. The lava has left craters in its wake which formed crystal tide pools. By looking into the pools, you can peer into another world as the marine life drifts by your window. In the brackish pools of this area, you may see pink flamingos, white-cheeked pintails, and common gallinules. If you look carefully into the pools, you may see white-tip reef sharks and some sea turtles.

Day 5 Santa Cruz Island

You will visit "Fausto Llerena" Tortoise Breeding Center in Puerto Ayora, where giant tortoises are bred in captivity. This is home to tortoises ranging from 3-inches (new hatchlings) to 4-feet long adults. Subspecies of the giant tortoises interact with one another, and many of the older tortoises are accustomed to humans stretching out their heads for a photo opportunity. The babies are kept until they are about four years-old and strong enough to survive on their own. Accessible by bus from Puerto Ayora, the highlands of Santa Cruz are a deep green which contrast beautifully with the dry, lower part of the islands. The predominant vegetation in the highlands are Scalesia trees which create a lush green forest. The lava tunnels, over half a mile long, are underground and walking through them is a unique, surreal experience. At this place you'll have lunch.

Day 6 Floreana Island

You will land on a beach and head to a spot where 18th century whalers placed a wooden barrel used as an unofficial mail box. The custom continues to this day with Galapagos visitors. So, don't forget your postcards, and don't be surprised if the post card arrives to its destination before you even get home! You will have a chance to snorkel around Devil's Crown which is the rocky remains of an offshore volcano sticking out of the water. This is a great location to spot a wide range of marine creatures. Cormorant Point hosts a large flamingo lagoon where other birds such as common stilts and white-cheeked pintails can also be seen. The beaches on this island are distinct: The Green Beach is named so due to its green color, which comes from a high percentage of olivine crystals in the sand, and the Flour Sand Beach is composed of white coral.

Day 7 Santa Fe & San Cristobal Islands

Santa Fe Island (Barrington) is home to the small picturesque bay and anchorage on the island's northeast coast. The bay has two visitor trails: one leading to a scenic viewpoint atop a cliff, and the other spanning from a small beach to a tall prickly pear cactus forest. You will take an excursion to Lobos Island which means "Sea Lion Island." This appropriately named island is ripe with noisy, playful, jolly sea lions who will welcome you to their home with open, well, fins. This island also offers great snorkeling opportunities as well as the chance to see blue-footed and Nazca boobies.

Day 8 San Cristobal Island

Breeding Center David Rodriguez - "La Galapaguera", in Cerro Colorado, is a new visitor site in the southeast part of San Cristobal Island and can now be reached in roughly one hour by road from Puerto Baquerizo Moreno. On the trees and shrubs surrounding the site, you may see land birds like warblers, finches and mockingbirds. Giant tortoises can be observed on the trails. They live there wild but in a protected area to ensure their survival by sealing them off from introduced predators like pigs and goats. After this final visit, you will be transferred to the San Cristobal airport in time for your flight back to the mainland.

Please Note:

Itineraries are subject to change.

Wild Earth Travel

Small Ships, Big Adventures

0800 945 3327 (within New Zealand) | +64 (0) 3 365 1355 | **1800 107 715** (within Australia)

info@wildearth-travel.com | **wildearth-travel.com**

Wild Earth Travel

Small Ships, Big Adventures

wildearth-travel.com

info@wildearth-travel.com

YOUR SHIP: GALAPAGOS HORIZON

YOUR SHIP:	Galapagos Horizon
VESSEL TYPE:	Trimaran
LENGTH:	125 ft (38 m)
PASSENGER CAPACITY:	16
BUILT/REFURBISHED:	



Launched: 2018

Horizon provides a top-notch experience with one of the smoothest rides in Galapagos.

Horizon is outfitted with 8 elegant and ample cabins, each with their own private balcony. Her amenities include a modern lounge, bar, al fresco dining area, and an extensive solarium with jacuzzi, designed to catch the best sights that the islands can offer, surrounded by endless charm.

Wild Earth Travel

Small Ships, Big Adventures

0800 945 3327 (within New Zealand) | +64 (0) 3 365 1355 | **1800 107 715** (within Australia)

info@wildearth-travel.com | **wildearth-travel.com**



Small Ships, Big Adventures

wildearth-travel.com

info@wildearth-travel.com

INSIDE YOUR SHIP

Main Deck

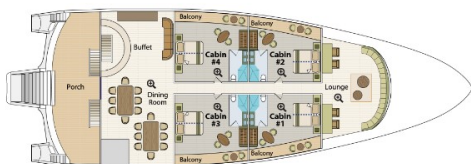

Upper Deck

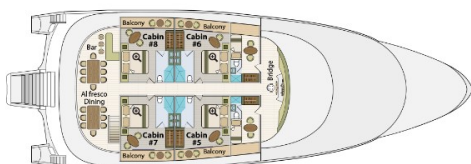

Sundeck

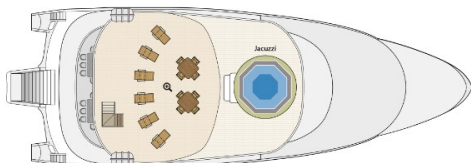

Standard Cabin





Wild Earth Travel

Small Ships, Big Adventures

wildearth-travel.com

info@wildearth-travel.com

PRICING

09-Aug-2025 to 16-Aug-2025

Standard Cabin	9345 USD pp
----------------	-------------

23-Aug-2025 to 30-Aug-2025

Standard Cabin	9345 USD pp
----------------	-------------

04-Oct-2025 to 11-Oct-2025

Standard Cabin	9345 USD pp
----------------	-------------

01-Nov-2025 to 08-Nov-2025

Standard Cabin	9345 USD pp
----------------	-------------

13-Dec-2025 to 20-Dec-2025

Standard Cabin	9345 USD pp
----------------	-------------

10-Jan-2026 to 17-Jan-2026

Standard Cabin	9445 USD pp
----------------	-------------

16-May-2026 to 23-May-2026

Standard Cabin	9445 USD pp
----------------	-------------

13-Jun-2026 to 20-Jun-2026

Standard Cabin	9445 USD pp
----------------	-------------

22-Aug-2026 to 29-Aug-2026

Standard Cabin	9445 USD pp
----------------	-------------

17-Oct-2026 to 24-Oct-2026

Standard Cabin	9445 USD pp
----------------	-------------

12-Dec-2026 to 19-Dec-2026

Standard Cabin	9445 USD pp
----------------	-------------



Wild Earth Travel
Small Ships, Big Adventures

0800 945 3327 (within New Zealand) | +64 (0) 3 365 1355 | **1800 107 715** (within Australia)

info@wildearth-travel.com | wildearth-travel.com