

ALASKA'S INSIDE PASSAGE SOJOURN - SOUTHEAST ALASKA CRUISE

Explore Southeast Alaska, from its northern to southern ends, on our 8-Night, 9-Day Alaska's Inside Passage Sojourn. Enjoy a collection of unique towns and Alaska Native villages, where you'll learn about the region's compelling history and three distinct Native cultures- Tlingit, Haida, and Tsimshian. Along the way, you'll journey through Southeast Alaska's most abundant wildlife areas and glacial fjords. Kayak, skiff, and hiking excursions allow for up-close and personal exploration.



ITINERARY

Day 1 Ketchikan & Annette Island

Wild Earth Travel

Small Ships, Big Adventures

wildearth-travel.com

info@wildearth-travel.com

Welcome to Ketchikan, otherwise known as Alaska's "First City" and "Salmon Capital of the World." We encourage you to arrive early and explore the community's rich culture, history, and biodiversity. After boarding the ship, take in the sights of the beautiful Tongass Narrows as you set out on your journey. Enjoy a welcome dinner while aboard then step ashore on Annette Island near the Tsimshian community of Metlakatla. Gather around a beach campfire as a local cultural guide/storyteller shares insights into the history and culture of the Tsimshian people.

Day 2 Misty Fjords National Monument

Your ship will glide beneath the glacier-sculpted cliffs of Misty Fjords—one of Southeast Alaska's national monuments. Discover the fjord's natural history, listen to the calls of a myriad of seabirds, see famous New Eddystone Rock (a stunning volcanic core), and savor adventures aboard our expedition vessel or kayaks.

Day 3 Kasaan

Walk an enchanted forest path laden with intricately carved totem poles to the Chief Son-i-Hat Whale-House-- the only remaining traditional Haida longhouse in the United States. Inside stand four original house posts, or "Ga ats," that were most likely carved at Old Kasaan in about 1880.

Day 4 Wrangell

Home to a little over 2,000 permanent residents, Wrangell is the only town in Alaska to have been under the jurisdiction of three flags and ruled by four nations--the Tlingit, Russia, England, and the United States. Enjoy several options to explore this colorful history, including a guided tour and a trip to the Wrangell Museum. Visit the intriguing state historic park, Petroglyph Beach, which contains the highest concentration of petroglyphs in Southeast Alaska.

Day 5 Frederick Sound and Tracy or Endicott Arm

Scout for humpback whales and other marine mammals in Frederick Sound. Humpbacks are famous for behavior that lends itself to incredible viewing and

photography, such as tail lobbing, lunge feeding, pectoral slapping, breaching, and picturesque dives that showcase their massive fluke. Journey through Tracy or Endicott Arm in the Tracy Arm-Fords Terror Wilderness--a place the famous naturalist, John Muir, called, "a wild, unfinished Yosemite." Renowned for its glaciers, pristine waterfalls, towering icebergs, abundant harbor seals, and granite cliffs that rise from sea level to 4,000 feet, this wilderness is often referred to by locals as one of the most scenic areas in the state."

Day 6 Juneau and Orca Point Lodge

Spend the day visiting highlights of the scenic capital city of Juneau. In downtown, we'll tour the captivating Alaska State Museum. There will also be time to explore on your own. The area boasts a vibrant culinary scene with award-winning restaurants and food trucks, local breweries, and distilleries. You can delve into indigenous culture by exploring exhibits, art displays, and a clan house at the Walter Soboleff Center. Other options include the Alaska State Capitol, city museum, Mt. Roberts Tram, and life-size humpback whale statue, "Thaku".

End the day's adventure with a relaxing evening at Orca Point Lodge, our own exclusive day lodge on Colt Island*. Enjoy the beautiful beach and a marine life viewing tank. Alaska crab and other delicious fare are served in the lodge, while s'mores are available at our beachside campfire.

*The lodge stop is subject to availability. If scheduling conflicts preclude the lodge, an alternative evening activity will be determined by your captain and guide staff.

Day 7 Glacier Bay National Park

This remarkable national park fjord extends 65-miles, contains tidewater glaciers, and provides pristine habitat for a wide-array of wildlife, including both brown and black bears, wolves, mountain goats, Steller sea lions, and humpback whales. The highlight for many is Margerie Glacier or John Hopkins Glacier, which have been known for their dramatic calving displays.

Day 8 Wilderness Exploration

Savor the serenity of raw wilderness on an unscripted morning and afternoon of Southeast Alaska discovery. The countless options are dictated by the day's

Wild Earth Travel

Small Ships, Big Adventures

0800 945 3327 (within New Zealand) | +64 (0) 3 365 1355 | 1800 107 715 (within Australia)

info@wildearth-travel.com | wildearth-travel.com



unique circumstances. Opportunities may include a coastline kayak paddle, up-close whale encounters, or a hike through an alluring old-growth forest. We may do a beach landing on an unspoiled shoreline to explore a tidal flat or track along with a foraging bear from the safety of our expedition vessel. Regardless of the activity, you'll experience the magic of the archipelago's many remote coves, bays, and inlets.

Day 9 Sitka

Disembark in beautiful Sitka, the only community in Southeast Alaska that faces the open ocean waters of the Gulf of Alaska. Transportation to your hotel or the airport is complimentary on the day of disembarkation. We encourage you to spend some time exploring our beautiful home port's rich culture, history, and biodiversity.

Please Note:

Itineraries are subject to change.



wildearth-travel.com

info@wildearth-travel.com

YOUR SHIP: BARANOF DREAM

YOUR SHIP:	Baranof Dream
VESSEL TYPE:	Expedition
LENGTH:	47.5 meters
PASSENGER CAPACITY:	49 (in twin Cabins)
BUILT/REFURBISHED:	1980/2011

The 143-foot Baranof Dream features a shallow draft for navigating intimate coves and passages, a spacious bow for viewing fjords and glaciers, a covered outside deck and a relaxed cruising speed for optimum viewing of wilderness and wildlife. Cabins offer large viewing windows. The Lounge and Dining Room offer intimate venues to get to know your fellow travelers.



Wild Earth Travel

Small Ships, Big Adventures

wildearth-travel.com

info@wildearth-travel.com

INSIDE YOUR SHIP

BARANOF DREAM

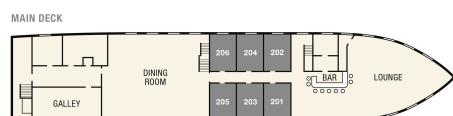
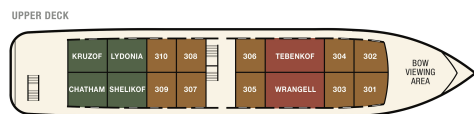
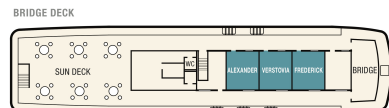
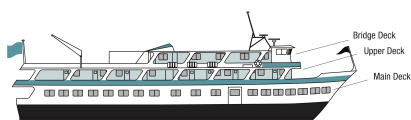

SHIP SPECIFICATIONS

Passengers: 49**
Length: 143 feet
Staterooms: 25
Cruising Speed: 9 knots

STATEROOMS/CATEGORIES

Deluxe Suite: One queen bed with two chairs or replaced with one twin bed or one twin bunk bed. Large picture window, wardrobe, private bathroom with shower. Approx. 210 sq. ft.

*Select cabins can accommodate 3rd or 4th guest

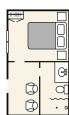

Deluxe: One queen bed, with either two chairs or an additional twin bed (or bunk bed) in the sitting room. Large picture window, wardrobe, private bathroom with shower. Approx. 110 sq. ft.

*Select cabins can accommodate a 3rd guest



AAA: One queen bed, with either two chairs or one twin bed. Large picture window, wardrobe, private bathroom with shower. Approx. 116 sq. ft.

*Select cabins can accommodate 3rd or 4th guests



AA: Two twin beds, picture window, wardrobe, private bathroom with shower. Approx. 105 sq. ft.



A: One queen and one single bed, picture window, private bathroom with shower. Approx. 109 sq. ft.

*Select cabins can accommodate a 3rd guest



Category A



Category AA



Category AAA



Deluxe



Deluxe Suite





PRICING

23-Jul-2025 to 31-Jul-2025

Category A	5995 USD pp
Category AA	6595 USD pp
Category AAA	7195 USD pp
Deluxe	8495 USD pp
Deluxe Suite	9195 USD pp

23-May-2026 to 31-May-2026

Category A	6195 USD pp
Category AA	6795 USD pp
Category AAA	7495 USD pp
Deluxe	8795 USD pp
Deluxe Suite	9495 USD pp

08-Aug-2025 to 16-Aug-2025

Category A	5995 USD pp
Category AA	6595 USD pp
Category AAA	7195 USD pp
Deluxe	8495 USD pp
Deluxe Suite	9195 USD pp

08-Jun-2026 to 16-Jun-2026

Category A	6195 USD pp
Category AA	6795 USD pp
Category AAA	7495 USD pp
Deluxe	8795 USD pp
Deluxe Suite	9495 USD pp

24-Aug-2025 to 01-Sep-2025

Category A	5995 USD pp
Category AA	6595 USD pp
Category AAA	7195 USD pp
Deluxe	8495 USD pp
Deluxe Suite	9195 USD pp

26-Jun-2026 to 04-Jul-2026

Category A	6195 USD pp
Category AA	6795 USD pp
Category AAA	7495 USD pp
Deluxe	8795 USD pp
Deluxe Suite	9495 USD pp

09-Sep-2025 to 17-Sep-2025

Category A	5995 USD pp
Category AA	6595 USD pp
Category AAA	7195 USD pp
Deluxe	8495 USD pp
Deluxe Suite	9195 USD pp

Wild Earth Travel

Small Ships, Big Adventures



wildearth-travel.com

info@wildearth-travel.com

PRICING

12-Jul-2026 to 20-Jul-2026

Category A	6195 USD pp
Category AA	6795 USD pp
Category AAA	7495 USD pp
Deluxe	8795 USD pp
Deluxe Suite	9495 USD pp

ADDITIONAL CHARGES:

Port taxes/fees from 300 USD pp

07-Aug-2026 to 15-Aug-2026

Category A	6195 USD pp
Category AA	6795 USD pp
Category AAA	7495 USD pp
Deluxe	8795 USD pp
Deluxe Suite	9495 USD pp

23-Aug-2026 to 31-Aug-2026

Category A	6195 USD pp
Category AA	6795 USD pp
Category AAA	7495 USD pp
Deluxe	8795 USD pp
Deluxe Suite	9495 USD pp

08-Sep-2026 to 16-Sep-2026

Category A	6195 USD pp
Category AA	6795 USD pp
Category AAA	7495 USD pp
Deluxe	8795 USD pp
Deluxe Suite	9495 USD pp