

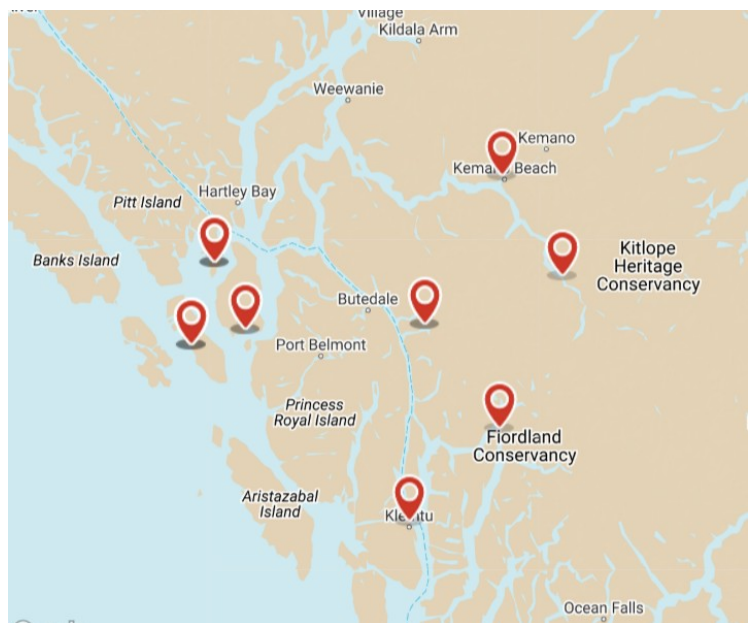

GREAT BEAR RAINFOREST AND KITLOPE CRUISE

Wild Wonders That We Have Explored and Supported Since 1986

Cruise through dramatic coastal mountains into the stunning Kitlope River. Here, snow-capped peaks tower over estuaries where bears graze on sedge in spring or fish for salmon in late summer. Join knowledgeable crew on shore excursions to explore the Kitlope River Estuary, relax on secluded beaches, trek through ancient rainforests, and discover the area's historical significance.



ITINERARY

Days 1-3 Tour Kickoff in Kitamaat

Day 1: Board ship at Kitamaat Village, orientation, cruising into the Great Bear Rainforest, making way towards the Kitlope River, watching for marine mammals and birds. Anchorage at remote hot springs.

Day 2: Cruise to spectacular mainland inlet estuary popular with grizzly and black bears. Estuary meadow walk (wildflowers), learning about bear habitat, river exploration, look for bears.

Day 3: Morning exploration ashore, then cruising Whale Channel, an aptly named waterway popular with cetaceans. Visit whale research scientists at remote station. Marine mammal viewing (several species). Anchorage at



remote island on west coast. Beachcombing, hike to view, beach fire.

Days 4-7 Gardner Canal

Day 4: Return to mainland waterways between steep islands, through channel popular with whales. Enter Gardner Canal, the longest fjord on the coast. This waterway seems like remote wilderness but is filled with the stories and history of the Henaaksiala people, and around every turn is a new story, including some sasquatch stories, and Monkey Beach.

Day 5: Sail deep into the coast mountains, leaving the outside world behind as the fjord snakes past 4,000-foot peaks to the Kitlope. Go ashore in the vast Kitlope River & estuary for the amazing tale of the G'psgolox pole. Explore the river and the estuary.

Day 6: Further exploration in the Kitlope, and/or or cruise to Kowesas to explore ashore, and then Kemaano shore trip. Cruise to hot springs.

Day 7: Cruise to Kitamaat, watching for wildlife.

Please note:

Itineraries are subject to change.



wildearth-travel.com

info@wildearth-travel.com

YOUR SHIP: CASCADIA

YOUR SHIP:	Cascadia
VESSEL TYPE:	Catamaran
LENGTH:	138 ft / 42 m
PASSENGER CAPACITY:	24
BUILT/REFURBISHED:	2007/2018/2019

Cascadia is a go-anywhere, expedition style catamaran. She accommodates up to 24 guests in 12 luxurious cabins, with a crew of 10. She is unlike any other vessel offering expeditions on the British Columbia coast, having been built specifically for high-quality, boutique cruises. Light, spacious and comfortable, she is also capable of reaching the wildest, most naturally rich places on the coast. Her small size and guest numbers provide an authentic, human-scale experience that respects the carrying capacity of coastal inlets and communities.

Ship And Accommodations Find comfort and solitude in your private cabin or enjoy time in any of the interior or outdoor lounges, or the "open" bridge. Cascadia's large windows bring the outside in, and her separate dining area becomes a sophisticated "long table" event for meals. Her decks are wide and welcoming, with seating areas on different levels.

Salon Large windows surround the salon making it a perfect place to look for whales while staying protected, chat with other guests while lounging on our comfortable sofas, or enjoy a beverage from the nearby bar.

Dining Area Enjoy our chefs' fine west-coast influenced creations while watching the sun go down. Sit and discuss your day's

adventure with your captain, afloat in a remote natural anchorage.

Terrace Lounge And Dining Area Dine alfresco on temperate evenings, lounge with your morning coffee, or watch the world go by during the day. This area is the perfect mix of outside and inside.

Bridge of Cascadia Cascadia's bridge is open to you. You'll have 180-degree views from here, along with being able to learn about navigation and the vessel systems from our crew. On the port side, you may also enjoy our indoor-outdoor loveseat. You can watch the world go by from behind a protective window, but still have quick access to the fresh air and the deck for whale watching.

Top Deck & Hot Tub Lounge on a chaise, soak under the stars, or enjoy the bird's eye view of the ship and the world around her from Cascadia's new top deck.

Cabins All cabins have individual climate control, wardrobes and an outside location, with windows for natural light. All have ensembles. All are 'outside' cabins, with windows for natural light. **Kayaks, Shore Boats, Naturalist Tools** Cascadia has 6 double and 2 single kayaks for paddling in coves and bays, as well as two beautiful landing craft style tenders, custom designed for our program. She carries a suite of tools for exploring the natural world, including a hydrophone for listening to whales. Her library contains books on the cultural history and nature of the BC and Alaska coast.



Wild Earth Travel

Small Ships, Big Adventures

wildearth-travel.com

info@wildearth-travel.com



aska coast.

Wild Earth Travel

Small Ships, Big Adventures

0800 945 3327 (within New Zealand) | +64 (0) 3 365 1355 | **1800 107 715** (within Australia)

info@wildearth-travel.com | **wildearth-travel.com**

Wild Earth Travel

Small Ships, Big Adventures

wildearth-travel.com

info@wildearth-travel.com

INSIDE YOUR SHIP

TOP DECK

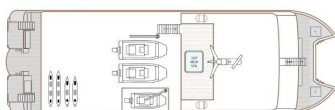

BRIDGE DECK

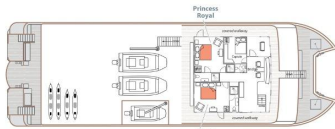

MAIN DECK



LOWER DECK

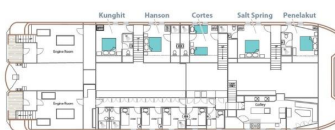

Cabin

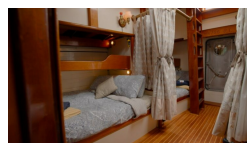

Category 1



Category 2



Category 3





Wild Earth Travel

Small Ships, Big Adventures



wildearth-travel.com

info@wildearth-travel.com

PRICING

02-Jun-2026 to 09-Jun-2026

Cabin	6000 CAD pp
-------	-------------

23-Aug-2026 to 29-Aug-2026

Category 1	8300 CAD pp
Category 2	9770 CAD pp
Category 3	11150 CAD pp
7 Day Cruise	0 pp



Wild Earth Travel
Small Ships, Big Adventures

0800 945 3327 (within New Zealand) | +64 (0) 3 365 1355 | **1800 107 715** (within Australia)

info@wildearth-travel.com | **wildearth-travel.com**