

Wild Earth Travel

Small Ships, Big Adventures

wildearth-travel.com

info@wildearth-travel.com

GALAPAGOS HORIZON 5 DAY CRUISE A

When is the best time to visit Galapagos? Galapagos is a place that can be visited at any time. There are two seasons, and the warmest is between December and May. It is the time of year when the sky is always clear, and the sun shines strongly. If you love to dive in amazing places, the best time to visit Galapagos is from June to November. During this season the weather is a little cooler, but it gives you the chance to enjoy the best from Galapagos' famous marine reserve. Good weather for visiting all year round. Galapagos is on the Equator, but the weather is not tropical. Temperatures range from 69°-84°F / 21°-30°C Very little rainfall. Warm season Dec-May. Dry season Jun-Nov.



ITINERARY

Day 1 Arrival to Baltra Airport and Transfer to the boat, Bartholomew Island

Bartholomew Island Home of the famous Pinnacle Rock, Bartholomew consists of an extinct volcano with a variety of red, orange, black and even green volcanic formations. A trail of stairs leads to the summit of the volcano, boasting one of the best views of the islands. The beach is perfect for snorkeling and possible sightings of the Galapagos penguin.

Day 2 Rabida Island, Santiago Island: Egas Port

Rabida Island Rabida Island (Jervis) is one of the most colorful and volcanically varied islands in the archipelago and a great snorkeling site. Its famous maroon sandy beach and stunning lookouts provide wonderful

Wild Earth Travel

Small Ships, Big Adventures

0800 945 3327 (within New Zealand) | +64 (0) 3 365 1355 | **1800 107 715** (within Australia)

info@wildearth-travel.com | **wildearth-travel.com**



Wild Earth Travel

Small Ships, Big Adventures

wildearth-travel.com

info@wildearth-travel.com

landscapes. The island is a birdwatcher's delight. Some of the rarest species are in abundance, such as nine varieties of finches, large-billed flycatchers, Galapagos hawks and brown pelicans. Egas Port Also known as James Bay, Egas Port is home to the curious Galapagos hawks and quick-footed Galapagos lava lizards. The trail leads to a coastline with gorgeous tide pools and grottos full of fauna. Here the Galapagos fur sea lions bathe in the sun. This is also a great snorkeling site.

Day 3 Genovesa: Darwin Bay, Genovesa: El Barranco

Darwin Bay This white sand coral beach heads a half mile trail (0.75km) that winds through mangroves filled with land birds. Nazca boobies, red-footed boobies, and swallow-tailed gulls can be spotted here. Further down the path are tidal pools where sea lions swim playfully. At the end is a spectacular view off a cliff. El Barranco Also known as Prince Phillip's Steps, El Barranco's steep, rocky paths leads up to a high cliff-face. A marvelous view can be appreciated from here. This site is also home to palo santo vegetation as well as red-footed boobies, short-eared lava owls, Galapagos swallows, and Galapagos doves.

Day 4 Mosquera Islet, Santa Cruz Island: Highlands / Tortoise Breeding Center

Mosquera Islet Located between the islands of Baltra and North Seymour, this reef of rocks and coral (the result of an uprising) is only 160 meters across at its narrowest width. This island has one of the largest populations of sea lions and is home to many shorebirds. There have been occasional reports at this site of orcas feeding on sea lions. Santa Cruz Highlands Reached by bus from Puerto Ayora, the highlands of Santa Cruz are a deep green contrasting beautifully with much of the dry, lower islands. The dominant vegetation in the highlands is the forest of Scalesia trees creating the lush green color. The lava tubes, over half a mile long, are underground and walking through them is a unique, surreal experience. Charles Darwin Station / Fausto Llerena Breeding Center The Charles Darwin Research Station is home to turtles ranging from 3-inches (new hatchlings) to 4-feet long. Subspecies of turtles interact with one another and many of the older turtles are accustomed to humans stretching out their heads for a photo opportunity. The babies are kept until they are about four years old and strong enough to survive on their own.

Day 5 North Seymour Island, Transfer to Baltra Airport

North Seymour Island Galapagos sea lions, blue-footed boobies and magnificent frigatebirds are abundant on North Seymour Island. The island was formed by a series of submarine lava containing layers of sediment that were uplifted by tectonic activity. The island is characterized by its arid vegetation zone.

Please Note:

Itineraries are subject to change.

Wild Earth Travel

Small Ships, Big Adventures

0800 945 3327 (within New Zealand) | +64 (0) 3 365 1355 | **1800 107 715** (within Australia)

info@wildearth-travel.com | **wildearth-travel.com**

Wild Earth Travel

Small Ships, Big Adventures

wildearth-travel.com

info@wildearth-travel.com

YOUR SHIP: GALAPAGOS HORIZON

YOUR SHIP:	Galapagos Horizon
VESSEL TYPE:	Trimaran
LENGTH:	125 ft (38 m)
PASSENGER CAPACITY:	16
BUILT/REFURBISHED:	



Launched: 2018

Horizon provides a top-notch experience with one of the smoothest rides in Galapagos.

Horizon is outfitted with 8 elegant and ample cabins, each with their own private balcony. Her amenities include a modern lounge, bar, al fresco dining area, and an extensive solarium with jacuzzi, designed to catch the best sights that the islands can offer, surrounded by endless charm.

Wild Earth Travel

Small Ships, Big Adventures

0800 945 3327 (within New Zealand) | +64 (0) 3 365 1355 | **1800 107 715** (within Australia)

info@wildearth-travel.com | **wildearth-travel.com**



info@wildearth-travel.com

INSIDE YOUR SHIP

Main Deck

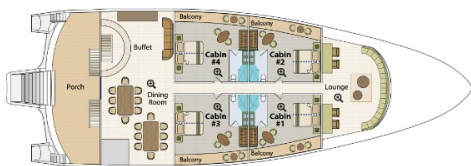

Upper Deck

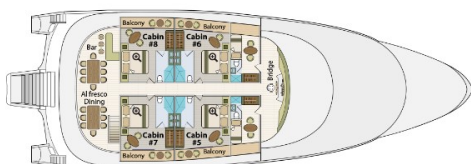

Sundeck

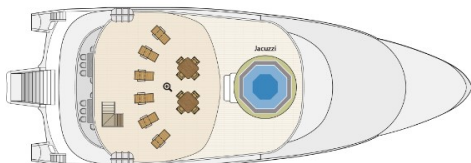

Standard Cabin



Wild Earth Travel

Small Ships, Big Adventures

wildearth-travel.com

info@wildearth-travel.com

PRICING

27-May-2025 to 31-May-2025

Standard Cabin	5845 USD pp
----------------	-------------

10-Jun-2025 to 14-Jun-2025

Standard Cabin	5845 USD pp
----------------	-------------

24-Jun-2025 to 28-Jun-2025

Standard Cabin	5845 USD pp
----------------	-------------

08-Jul-2025 to 12-Jul-2025

Standard Cabin	5845 USD pp
----------------	-------------

22-Jul-2025 to 26-Jul-2025

Standard Cabin	5845 USD pp
----------------	-------------

05-Aug-2025 to 09-Aug-2025

Standard Cabin	5845 USD pp
----------------	-------------

19-Aug-2025 to 23-Aug-2025

Standard Cabin	5845 USD pp
----------------	-------------

30-Sep-2025 to 04-Oct-2025

Standard Cabin	5845 USD pp
----------------	-------------

14-Oct-2025 to 18-Oct-2025

Standard Cabin	5845 USD pp
----------------	-------------

28-Oct-2025 to 01-Nov-2025

Standard Cabin	5845 USD pp
----------------	-------------

11-Nov-2025 to 15-Nov-2025

Standard Cabin	5845 USD pp
----------------	-------------

25-Nov-2025 to 29-Nov-2025

Standard Cabin	5845 USD pp
----------------	-------------

09-Dec-2025 to 13-Dec-2025

Standard Cabin	5845 USD pp
----------------	-------------

06-Jan-2026 to 10-Jan-2026

Standard Cabin	5845 USD pp
----------------	-------------

20-Jan-2026 to 24-Jan-2026

Standard Cabin	5845 USD pp
----------------	-------------

03-Feb-2026 to 07-Feb-2026

Standard Cabin	5845 USD pp
----------------	-------------

17-Feb-2026 to 21-Feb-2026

Standard Cabin	5845 USD pp
----------------	-------------

03-Mar-2026 to 07-Mar-2026

Standard Cabin	5845 USD pp
----------------	-------------

17-Mar-2026 to 21-Mar-2026

Standard Cabin	5845 USD pp
----------------	-------------

28-Apr-2026 to 02-May-2026

Standard Cabin	5845 USD pp
----------------	-------------

12-May-2026 to 16-May-2026

Standard Cabin	5845 USD pp
----------------	-------------

26-May-2026 to 30-May-2026

Standard Cabin	5845 USD pp
----------------	-------------

Wild Earth Travel
Small Ships, Big Adventures

0800 945 3327 (within New Zealand) | +64 (0) 3 365 1355 | **1800 107 715** (within Australia)

info@wildearth-travel.com | wildearth-travel.com



Wild Earth Travel

Small Ships, Big Adventures

wildearth-travel.com

info@wildearth-travel.com

09-Jun-2026 to 13-Jun-2026

Standard Cabin	5845 USD pp
----------------	-------------

23-Jun-2026 to 27-Jun-2026

Standard Cabin	5845 USD pp
----------------	-------------

07-Jul-2026 to 11-Jul-2026

Standard Cabin	5845 USD pp
----------------	-------------

21-Jul-2026 to 25-Jul-2026

Standard Cabin	5845 USD pp
----------------	-------------

04-Aug-2026 to 08-Aug-2026

Standard Cabin	5845 USD pp
----------------	-------------

10-Nov-2026 to 14-Nov-2026

Standard Cabin	5845 USD pp
----------------	-------------

24-Nov-2026 to 28-Nov-2026

Standard Cabin	5845 USD pp
----------------	-------------

08-Dec-2026 to 12-Dec-2026

Standard Cabin	5845 USD pp
----------------	-------------



Wild Earth Travel
Small Ships, Big Adventures

0800 945 3327 (within New Zealand) | +64 (0) 3 365 1355 | **1800 107 715** (within Australia)

info@wildearth-travel.com | **wildearth-travel.com**