

Wild Earth Travel

Small Ships, Big Adventures

wildearth-travel.com

info@wildearth-travel.com

GALAPAGOS HORIZON 5 DAY CRUISE C

This five-day Galapagos Islands itinerary offers an incredible exploration of Santiago, Isabela, Fernandina, and Santa Cruz Islands. Starting with a scenic arrival at Sullivan Bay, the journey includes snorkeling at Vicente Roca Point, hiking to view unique wildlife at Espinoza Point, and discovering geological wonders at Tagus Cove and Urbina Bay. Visitors can experience the diverse marine life and landscapes of Elizabeth Bay and Moreno Point before concluding with an educational visit to the Fausto Llerena Tortoise Breeding Center. Each day promises unique encounters with the islands' endemic species and breathtaking vistas.



ITINERARY

Day 1: SANTIAGO ISLAND

Morning flight from Quito or Guayaquil to Baltra, Galapagos Islands. You will arrive at Baltra Island in the morning. After passing through immigration and baggage claim, you will be met by a Horizon staff member and transferred to the yacht. You will be shown to your cabin where you will have some time to settle in before lunch and a welcome briefing. You will visit Sullivan Bay located on the southeast part of Santiago. This place is interesting for its geology because the area is covered by lava flows. This place has elevations in the form of small volcanoes formed by the lava flows.

Day 2: ISABELA AND FERNANDINA ISLANDS

Wild Earth Travel

Small Ships, Big Adventures

0800 945 3327 (within New Zealand) | +64 (0) 3 365 1355 | **1800 107 715** (within Australia)

info@wildearth-travel.com | **wildearth-travel.com**



Wild Earth Travel

Small Ships, Big Adventures

wildearth-travel.com

info@wildearth-travel.com

Comprised of two separate coves, Vicente Roca Point is a large bay with spectacular sea life. Keep an eye out for seahorses, sea turtles, and the strange yet fascinating Mola mola (or sunfish) while you snorkel.

Vicente Roca Point, Isabela Island

Crossing the Bolivar Channel that divides Isabela and Fernandina Islands, you will land at Espinoza Point, and after walking past a colony of marine iguanas and a group of sea lions, you will reach the island's highlight: the flightless cormorant nesting site. This area also provides a great opportunity to see the Galapagos hawk.

Day 3: ISABELA ISLAND

You will visit Tagus Cove on Isabela Island which is located across from Fernandina Island, near the Bolivar Channel dividing the two islands. This spot has been frequented by ships since the 1800s, using the area as an anchorage site. Trails winding by Lake Darwin up to a ridge display wonderful views. Urbina Bay is located at the base of Alcedo Volcano on the west coast between Tagus Cove and Elizabeth Bay. This area experienced a major uplift in 1954 causing the land to rise over 16 feet. The coast expanded half a mile out leaving marine life stranded on the new shore. This area is also a great place for snorkeling.

Day 4: ISABELA ISLAND

Elizabeth Bay is located on the east coast of Isabela Island. The bay contains many islets, which can be visited by dinghy. Penguins and blue-footed boobies can be spotted on the rocky islets. With an abundance of marine life and clear water, the area is perfect for snorkeling and viewing schools of colorful fish, sea lions, and perhaps even sharks.

Moreno Point is located southwest of Elizabeth Bay. Here a dry landing onto what was once flowing lava is possible. The lava has left craters in its wake which formed crystal tide pools. By looking into the pools, you can peer into another world as the marine life drifts by your window. In the brackish pools of this area, you may see pink flamingos, white-cheeked pintails, and common gallinules. If you look carefully into the pools, you may see white-tip reef sharks and some sea turtles.

Day 5: SANTA CRUZ ISLAND

You will visit "Fausto Llerena" Tortoise Breeding Center in Puerto Ayora, where giant tortoises are bred in captivity. This is home to tortoises ranging from 3-inches (new hatchlings) to 4-feet long adults. Subspecies of the giant tortoises interact with one another, and many of the older tortoises are accustomed to humans stretching out their heads for a photo opportunity. The babies are kept until they are about four years old and strong enough to survive on their own. After this final visit, you will be transferred to the Baltra airport in time for your flight back to the mainland.

Please note:

Itineraries are subject to change.

Wild Earth Travel

Small Ships, Big Adventures

0800 945 3327 (within New Zealand) | +64 (0) 3 365 1355 | **1800 107 715** (within Australia)

info@wildearth-travel.com | wildearth-travel.com

Wild Earth Travel

Small Ships, Big Adventures

wildearth-travel.com

info@wildearth-travel.com

YOUR SHIP: GALAPAGOS HORIZON

YOUR SHIP:	Galapagos Horizon
VESSEL TYPE:	Trimaran
LENGTH:	125 ft (38 m)
PASSENGER CAPACITY:	16
BUILT/REFURBISHED:	



Launched: 2018

Horizon provides a top-notch experience with one of the smoothest rides in Galapagos.

Horizon is outfitted with 8 elegant and ample cabins, each with their own private balcony. Her amenities include a modern lounge, bar, al fresco dining area, and an extensive solarium with jacuzzi, designed to catch the best sights that the islands can offer, surrounded by endless charm.

Wild Earth Travel

Small Ships, Big Adventures

0800 945 3327 (within New Zealand) | +64 (0) 3 365 1355 | **1800 107 715** (within Australia)

info@wildearth-travel.com | **wildearth-travel.com**

Wild Earth Travel

Small Ships, Big Adventures

wildearth-travel.com

info@wildearth-travel.com

INSIDE YOUR SHIP

Main Deck

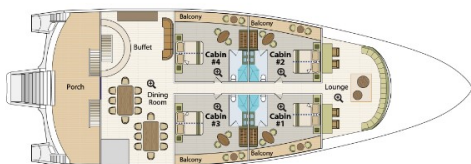

Upper Deck

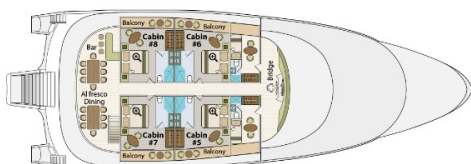

Sundeck

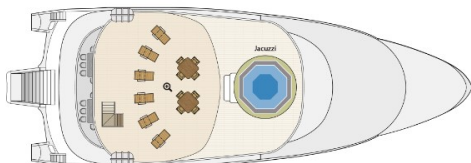

Standard Cabin



Wild Earth Travel

Small Ships, Big Adventures

0800 945 3327 (within New Zealand) | +64 (0) 3 365 1355 | 1800 107 715 (within Australia)

info@wildearth-travel.com | wildearth-travel.com



Wild Earth Travel

Small Ships, Big Adventures

wildearth-travel.com

info@wildearth-travel.com

PRICING

28-Jun-2025 to 02-Jul-2025

Standard Cabin	5845 USD pp
----------------	-------------

26-Jul-2025 to 30-Jul-2025

Standard Cabin	5845 USD pp
----------------	-------------

18-Oct-2025 to 22-Oct-2025

Standard Cabin	5845 USD pp
----------------	-------------

29-Nov-2025 to 03-Dec-2025

Standard Cabin	5845 USD pp
----------------	-------------

10-Jan-2026 to 14-Jan-2026

Standard Cabin	5845 USD pp
----------------	-------------

24-Jan-2026 to 28-Jan-2026

Standard Cabin	5845 USD pp
----------------	-------------

07-Feb-2026 to 11-Feb-2026

Standard Cabin	5845 USD pp
----------------	-------------

21-Feb-2026 to 25-Feb-2026

Standard Cabin	5845 USD pp
----------------	-------------

07-Mar-2026 to 11-Mar-2026

Standard Cabin	5845 USD pp
----------------	-------------

18-Apr-2026 to 22-Apr-2026

Standard Cabin	5845 USD pp
----------------	-------------

02-May-2026 to 06-May-2026

Standard Cabin	5845 USD pp
----------------	-------------

16-May-2026 to 20-May-2026

Standard Cabin	5845 USD pp
----------------	-------------

30-May-2026 to 03-Jun-2026

Standard Cabin	5845 USD pp
----------------	-------------

13-Jun-2026 to 17-Jun-2026

Standard Cabin	5845 USD pp
----------------	-------------

27-Jun-2026 to 01-Jul-2026

Standard Cabin	5845 USD pp
----------------	-------------

25-Jul-2026 to 29-Jul-2026

Standard Cabin	5845 USD pp
----------------	-------------

31-Oct-2026 to 04-Nov-2026

Standard Cabin	5845 USD pp
----------------	-------------

14-Nov-2026 to 18-Nov-2026

Standard Cabin	5845 USD pp
----------------	-------------

28-Nov-2026 to 02-Dec-2026

Standard Cabin	5845 USD pp
----------------	-------------



Wild Earth Travel
Small Ships, Big Adventures

0800 945 3327 (within New Zealand) | +64 (0) 3 365 1355 | **1800 107 715** (within Australia)

info@wildearth-travel.com | wildearth-travel.com