

# Wild Earth Travel

*Small Ships, Big Adventures*

**wildearth-travel.com**

**info@wildearth-travel.com**

## GALAPAGOS 6 DAY CRUISE B ABOARD ALYA LUXURY CATAMARAN

A 6 Day Cruise exploring the western islands in the Galapagos.  
Leaving and returning to Santa Cruz island.

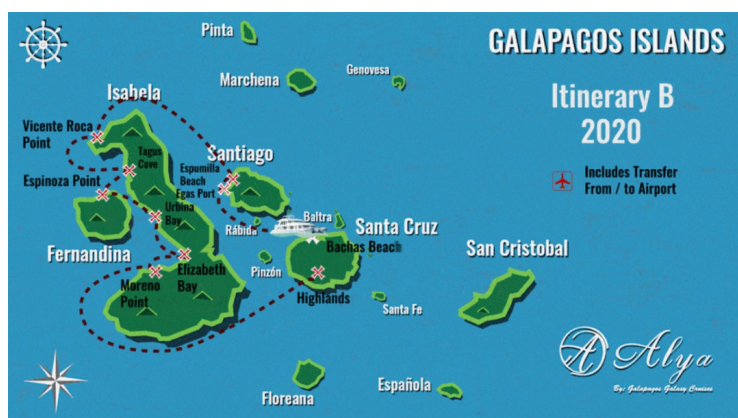

### ITINERARY

#### Day 1 SANTA CRUZ ISLAND: AIRPORT – HIGHLANDS

Baltra airport. Reception at the airport. Transfer in. Welcome on board Alya Catamaran. Lunch After lunch we will visit HIGHLANDS OF SANTA CRUZ, where we will hike and encounter giant tortoises in their natural habitat, a natural wonder.. For this visit we recommend to use sport shoes, long pants, raincoat, hat and sun block. Return to Alya.

#### Day 2 ISABELA ISLAND: MORENO POINT – ELIZABETH BAY

MORENO POINT: is located on the north coast of Isabela Island between Sierra Negra and Cerro Azul Volcanoes. The main attractions at Punta Moreno are coastal lagoons amid black lava flows where there are several species of birds. It has a panoramic view of the three most active volcanoes in the Galapagos: the Sierra Negra, the Cerro Azul (Isabela Island) and La Cumbre (Fernandina Island). Lunch. ELIZABETH BAY: This is one of the island's breeding sites for penguins. Located on the west coast of Isabela, Elizabeth Point is a marine visitor site. Visit Red Mangrove Cove: Brown pelicans, flightless cormorants, spotted eagle rays, golden rays and sea lions are often seen. Dinner.

Wild Earth Travel

*Small Ships, Big Adventures*

**0800 945 3327** (within New Zealand) | +64 (0) 3 365 1355 | **1800 107 715** (within Australia)

info@wildearth-travel.com | **wildearth-travel.com**



# Wild Earth Travel

*Small Ships, Big Adventures*

**wildearth-travel.com**

**info@wildearth-travel.com**

## Day 3 ISABELA ISLAND: URBINA BAY & FERNANDINA: ESPINOZA POINT

URBINA BAY: this place is located at the base of Alcedo Volcano between Elizabeth Bay and Tagus Cove. Wet landing. Trail length is around 3.20 Km; during this we can observe land iguanas, hawks, and tortoises. It is also possible to see red and blue lobsters. Lunch. ESPINOZA POINT: Fernandina is the third biggest island in the Galapagos and has only one visiting site: Espinoza Point, famous for the large colonies of marine iguanas and the home of the flightless cormorant, the Galapagos penguin, snakes, and more. From Espinoza Point, we can admire the beauty of Fernandina Island and its volcano which last erupted in May of 2005. Fernandina is the only island that doesn't have mammals and the open areas are extremely fragile. From January to June, the nesting period of the marine iguana, we take great care when walking. Dinner.

## Day 4 ISABELA ISLAND TAGUS COVE - VICENTE ROCA POINT

TAGUS COVE: It is located to the west of Darwin Volcano on Isabela Island. While walking, we will find several inscriptions (names of pirates) dating back to the 1800's. From here, we can see Darwin Lake, a salt water lake with a depth of approximately 9 m. It contains no fish. It is very common to see a variety of bird species. Lunch. VICENTE ROCA POINT: is comprised of two separate coves, this site is a large bay with spectacular sea life. Keep an eye out for seahorses, sea turtles, and the strange yet fascinating Mola-mola (sunfish). Dinner.

## Day 5 SANTIAGO ISLAND: ESPUMILLA BEACH - EGAS PORT

ESPUMILLA BEACH: The main attractions include Palo Santo Wood, the beach, and the stunning landscape; the beach is a very important site for tortoises because they use this place for nesting. Lunch. EGAS PORT: Here we find a beautiful black sand beach; to the south of the beach is the Pan de Azucar Volcano, whose volcanic deposits have contributed to the formation of the black sand beach. The crater of this volcano contains a saltwater lake that dries up during hot weather. Between 1928 and 1930, explorations to develop a salt mine were carried out, but it was decided that a mine was not feasible. The workers' use of endemic woods also damaged the environment and the development was scrapped. Descent to the salt mine is not allowed. Dinner.

## Day 6 SANTA CRUZ: BACHAS

BACHAS BEACH: This beautiful beach is located in the north of Santa Cruz Island; the beach is one km long. The site was named during WWII (World War II) when the American army left two barges on the beach. The early colonists couldn't pronounce barges correctly, so they called the area "Bachas". Transfer out.

### Please Note:

This itinerary is subject to change without notice; due to seasonal changes, weather conditions or Galapagos National Park regulations.



# Wild Earth Travel

*Small Ships, Big Adventures*

**wildearth-travel.com**

**info@wildearth-travel.com**

## YOUR SHIP: ALYA

<b>YOUR SHIP:</b>	<b>Alya</b>
<b>VESSEL TYPE:</b>	<b>Catamaran</b>
<b>LENGTH:</b>	<b>31.5 metres</b>
<b>PASSENGER CAPACITY:</b>	<b>16</b>
<b>BUILT/REFURBISHED:</b>	<b>2017</b>

Alya Catamaran is a Luxury cruise ship, built in Guayaquil in 2017. It has 2 life rafts, 2 Zodiacs and it has communication with the Galapagos, the Galagents office and the Ecuadorian Marine Service. Alya Luxury Catamaran offers: 9 comfortable cabins, eight of them have private balconies. The beds in the cabins can be king or twin. - There are many social areas for your comfort and relaxation. - Enjoy a drink from one of the catamaran's two bars. - The nine crew members and bilingual guide provide for a safe and informative trip in the Galapagos Islands. - Certified bilingual naturalist guide - Snorkel equipment provided and wetsuit rental available. - Safety equipment (35 life jackets - 4 lifebuoys 9mm - Flare light, smoke signals, flashlights with SOS signals and other types of visual signals. - 2 survival rafts, 25 passengers each. - Fire extinguishers 10 lb and 2lb. - Fire hoses 15m. - Fire detectors and complete fire protection system.)

### Upper Deck

4 Cabins 172ft<sup>2</sup> / 16m<sup>2</sup> double cabins (all with private balcony & bathroom) - Bridge - Captain's Cabin - Bar

### Main Deck

5 cabins, One 205ft<sup>2</sup> / 19m<sup>2</sup> double cabin. Four 215ft<sup>2</sup> / 20m<sup>2</sup>

double cabins with private balcony. - Guide's cabin - Boutique - Porch - Dining room 27.58m<sup>2</sup> - Living room 27.58m<sup>2</sup> - Wine storage - Bar - Coffee station

### Lower Deck

2 Machine Rooms - Crew Dining - 4 Crew Cabins & 1 Double Crew Cabin - Laundry - Cruise Manager

### Bar and Restaurant

Tasting the food on board the Alya Luxury Catamaran is a unique experience. The mixture of national and international dishes will surprise you. While on board, you can enjoy a cup of coffee, or cappuccino if you prefer. Our coffee machine is available to you during the day. If you prefer something stronger, you can choose from an assortment of cocktails or beer. We offer a variety of dishes, enough to satisfy the appetite of any guest, and we have a little more for those who want a second helping. If our guests have special dietary needs, such as: lactose intolerance, gluten-free, allergies, vegetarian, etc., we can accommodate their needs. However, keep in mind that we need to know about such needs in advance. Our buffet breakfast includes a variety of sausages; cheese and bread are available. On our buffet lunch, you will find accompaniments, along with hot and cold salads. Dinner is a served meal with two options to choose from. Juice or water will be included at each meal.

### Social Area

While you are sailing through the Galapagos Islands we have comfortable areas for your enjoyment. Have a good time with your family and meet new friends in the lounge and bar. In the dining room area we serve the most delicious food on the seas cooked by our professional chefs. You can also enjoy your food



Wild Earth Travel  
*Small Ships, Big Adventures*

**0800 945 3327** (within New Zealand) | +64 (0) 3 365 1355 | **1800 107 715** (within Australia)

info@wildearth-travel.com | **wildearth-travel.com**

# Wild Earth Travel

*Small Ships, Big Adventures*

**wildearth-travel.com**

**info@wildearth-travel.com**

in the alfresco area; it's a great idea to eat with the ocean view. On the sundeck area we have spacious sofas where you can enjoy the best views and sunsets of your life. Relax in the Jacuzzi while you have some drinks or simply take a rest.

## Activities

Having entertainment in the Galapagos is important! We have available four double kayaks, two zodiacs for panga rides, and snorkeling equipment. Wetsuits are available for rent. Our complete itineraries are developed for the benefit of our passengers, who will have the opportunity to combine hiking, snorkeling, beach time, swimming, photography, kayaking and animal watching in their natural habitat. Our professional guides will introduce you to the most relevant sites on each island. If you want to do some extra activities while you are enjoying your cruise, such as diving, artisanal fishing, and more, we will be glad to organize something special for you.



al for you.

Wild Earth Travel

*Small Ships, Big Adventures*

**0800 945 3327** (within New Zealand) | +64 (0) 3 365 1355 | **1800 107 715** (within Australia)

info@wildearth-travel.com | **wildearth-travel.com**

## INSIDE YOUR SHIP

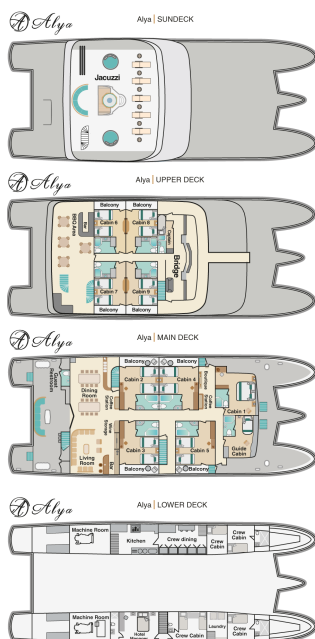

Cabin





# Wild Earth Travel

*Small Ships, Big Adventures*

**wildearth-travel.com**

**info@wildearth-travel.com**

## PRICING

**07-Jul-2025 to 12-Jul-2025**

Cabin	5000 USD pp
-------	-------------

**21-Jul-2025 to 26-Jul-2025**

Cabin	5000 USD pp
-------	-------------

**04-Aug-2025 to 09-Aug-2025**

Cabin	5000 USD pp
-------	-------------

**18-Aug-2025 to 23-Aug-2025**

Cabin	5000 USD pp
-------	-------------

**01-Sep-2025 to 06-Sep-2025**

Cabin	5000 USD pp
-------	-------------

**15-Sep-2025 to 20-Sep-2025**

Cabin	5000 USD pp
-------	-------------

**29-Sep-2025 to 04-Oct-2025**

Cabin	5000 USD pp
-------	-------------

**13-Oct-2025 to 18-Oct-2025**

Cabin	5000 USD pp
-------	-------------

**27-Oct-2025 to 01-Nov-2025**

Cabin	5000 USD pp
-------	-------------

**10-Nov-2025 to 15-Nov-2025**

Cabin	5000 USD pp
-------	-------------

**24-Nov-2025 to 29-Nov-2025**

Cabin	5000 USD pp
-------	-------------

**08-Dec-2025 to 13-Dec-2025**

Cabin	5000 USD pp
-------	-------------

**22-Dec-2025 to 27-Dec-2025**

Cabin	7500 USD pp
-------	-------------

**05-Jan-2026 to 10-Jan-2026**

Cabin	5700 USD pp
-------	-------------

**19-Jan-2026 to 24-Jan-2026**

Cabin	5700 USD pp
-------	-------------

**02-Feb-2026 to 07-Feb-2026**

Cabin	5700 USD pp
-------	-------------

**02-Mar-2026 to 07-Mar-2026**

Cabin	5700 USD pp
-------	-------------

**16-Mar-2026 to 21-Mar-2026**

Cabin	5700 USD pp
-------	-------------

**30-Mar-2026 to 04-Apr-2026**

Cabin	5700 USD pp
-------	-------------

**13-Apr-2026 to 18-Apr-2026**

Cabin	5700 USD pp
-------	-------------

**27-Apr-2026 to 02-May-2026**

Cabin	5700 USD pp
-------	-------------

**11-May-2026 to 16-May-2026**

Cabin	5700 USD pp
-------	-------------

**Wild Earth Travel**  
*Small Ships, Big Adventures*

**0800 945 3327** (within New Zealand) | +64 (0) 3 365 1355 | **1800 107 715** (within Australia)

info@wildearth-travel.com | wildearth-travel.com

# Wild Earth Travel

*Small Ships, Big Adventures*

**wildearth-travel.com**

**info@wildearth-travel.com**

**25-May-2026 to 30-May-2026**

Cabin	5700 USD pp
-------	-------------

**09-Nov-2026 to 14-Nov-2026**

Cabin	5700 USD pp
-------	-------------

**08-Jun-2026 to 13-Jun-2026**

Cabin	5700 USD pp
-------	-------------

**23-Nov-2026 to 28-Nov-2026**

Cabin	5700 USD pp
-------	-------------

**22-Jun-2026 to 27-Jun-2026**

Cabin	5700 USD pp
-------	-------------

**06-Jul-2026 to 11-Jul-2026**

Cabin	5700 USD pp
-------	-------------

**20-Jul-2026 to 25-Jul-2026**

Cabin	5700 USD pp
-------	-------------

**03-Aug-2026 to 08-Aug-2026**

Cabin	5700 USD pp
-------	-------------

**17-Aug-2026 to 22-Aug-2026**

Cabin	5700 USD pp
-------	-------------

**31-Aug-2026 to 05-Sep-2026**

Cabin	5700 USD pp
-------	-------------

**14-Sep-2026 to 19-Sep-2026**

Cabin	5700 USD pp
-------	-------------

**28-Sep-2026 to 03-Oct-2026**

Cabin	5700 USD pp
-------	-------------

**12-Oct-2026 to 17-Oct-2026**

Cabin	5700 USD pp
-------	-------------

**26-Oct-2026 to 31-Oct-2026**

Cabin	5700 USD pp
-------	-------------

**Wild Earth Travel**  
*Small Ships, Big Adventures*

**0800 945 3327** (within New Zealand) | +64 (0) 3 365 1355 | **1800 107 715** (within Australia)

info@wildearth-travel.com | **wildearth-travel.com**



# Wild Earth Travel

*Small Ships, Big Adventures*



**wildearth-travel.com**

**info@wildearth-travel.com**

## PRICING

**07-Dec-2026 to 12-Dec-2026**

<b>Cabin</b>	<b>5700 USD pp</b>
--------------	--------------------

**21-Dec-2026 to 26-Dec-2026**

<b>Cabin</b>	<b>8550 USD pp</b>
--------------	--------------------

**Galapagos National Park Entrance  
Fee, Galapagos Transit card 220**

**ADDITIONAL CHARGES:**

**USD pp**



**Wild Earth Travel**

*Small Ships, Big Adventures*

**0800 945 3327** (within New Zealand) | +64 (0) 3 365 1355 | **1800 107 715** (within Australia)

info@wildearth-travel.com | **wildearth-travel.com**