

# Wild Earth Travel

*Small Ships, Big Adventures*

**wildearth-travel.com**

**info@wildearth-travel.com**

## EPIC FALKLAND ISLANDS, SOUTH GEORGIA & ANTARCTICA EXPEDITION

On this extraordinary 19-day voyage, explore the fascinating Falkland Islands and mind-blowing South Georgia before heading to the South Shetlands Islands and the Antarctic peninsula. All the highlights of the Southern Ocean!

Departing Argentina's southernmost city of Ushuaia, we will venture east towards the Falkland Islands (Malvinas). A British Overseas Territory, the Falklands are a unique blend of British culture (expect tea and red phone boxes) and southern wildness, where penguins cavort alongside sheep on former battlefields.

From the Falklands, we venture onwards to South Georgia. A strip of jagged glacier-clad mountains piercing the brooding sky, South Georgia leaves a mark on every visitor, and it is no mystery why. The shores brim with wildlife, with thousands of King Penguins, elephant seals and Antarctic fur seals. The vast penguin colonies, seal-filled seas and albatross-packed skies have to be seen to be believed.

Continuing southward, we will delve deeper into the inlets and bays of the Antarctic Peninsula, entering the famous Gerlache Strait, where glittering ice cliffs and precipitous peaks rise straight out of the frigid water. Icebergs, glaciers, mountains and rugged snowfields characterise this wildly beautiful alien landscape. We always aim to visit locations which showcase the best of Antarctica, and we are always on the lookout for wildlife; feathered friends and jaw-dropping scenery and landscapes are guaranteed!

Any voyage in the Southern Ocean is an adventure, but with an average occupancy of 175 guests aboard Ocean Victory and Ocean Albatros, our cruises offer a unique experience for the brave few. Shore landings and Zodiac safaris will occupy our days, while our knowledgeable onboard Expedition Team will offer a selection of specially crafted lectures to inform your matchless expedition experience.



experience.

### ITINERARY

#### DAY 1 ARRIVAL AND EMBARKATION IN USHUAIA

Wild Earth Travel

*Small Ships, Big Adventures*

**0800 945 3327** (within New Zealand) | +64 (0) 3 365 1355 | **1800 107 715** (within Australia)

info@wildearth-travel.com | **wildearth-travel.com**



# Wild Earth Travel

*Small Ships, Big Adventures*

**wildearth-travel.com**

**info@wildearth-travel.com**

Arrive in Ushuaia, Argentina - the world's southernmost city. Explore this vibrant Patagonian city, or stretch your legs in the surrounding forests. Alternatively, consider a day trip off the beaten path into the raw nature of Tierra del Fuego. The island of Tierra del Fuego is a hiker's paradise with rugged snow-capped mountains, glaciers, flower-filled meadows and rich boggy wetlands. In the afternoon, we board our vessel, waiting to welcome us in port.

After our mandatory safety drill, our expedition begins as we navigate through the calm waters of the famous Beagle Channel (named for Charles Darwin's ship). This steep-sided strait divides southern Tierra del Fuego between Chile and Argentina, and has been the jumping-off point for thousands of expeditions into the unknown. Watch out for whales and dolphins as we sail off the edge of the map into the tempestuous Drake Passage.

## DAY 2 AT SEA TOWARDS THE FALKLAND ISLANDS

Following the ocean currents of the South Atlantic, we head towards the rarely-visited Falkland Islands (Islas Malvinas).

While the indigenous Yaghan people of Tierra del Fuego may have visited the islands, the Falkland Islands (Malvinas) had no indigenous population when Europeans arrived in the early 16th Century. The islands' sovereignty has been contested ever since, with historical Spanish, French, British and Argentine claims; the islands were established politically as a British colony in 1840. Tensions resulted in a conflict over the islands between Britain and Argentina in 1982. The conflict left a lasting impact on the islands - while it spurred much-needed development assistance from the United Kingdom, the conflict also left much of the islands heavily mined. Since the conflict however, the islands have flourished, selling lucrative fishing rights to their rich waters. The de-mining operation was completed in 2020, celebrated by a football match on the last patch of de-mined ground between the islands' Governor and the Zimbabwean de-mining team who have made the Falklands their home.

The waters around the Falklands are some of the richest in the world, with huge whale, seal and penguin populations feeding where cold Antarctic waters meet the warmer waters of the South Atlantic, so keep binoculars at the ready! Otherwise, join your Expedition Team lecturers to hear about these islands' fascinating history, biology and unique 'Kelper' (as the locals call themselves) culture.

## DAY 3-4 FALKLAND ISLANDS, VISIT PORT STANLEY

On our first day in the Falklands we will venture to some of the outer islands in the West Falklands - 'Camp', as the locals call the area outside Stanley. The outer islands of the Falklands are much wilder and more remote than the mainland, and host the majority of the islands' wildlife. Islands such as West Point, Carcass and Saunders are well known for their spectacular wildlife. Southern Rockhopper Penguins, Black-Browed Albatross and King Cormorants commonly nest together in vast cliffside colonies; penguins nurture their eggs and chicks in clefts between large cylindrical nests where cormorants and albatross nest. Be sure to look out above to see the bast albatross coming in to land (often less than gracefully). The islands are home to a vast number of other bird species such as the endearingly cheeky Striated Caracara (watch all unattended possessions!), and in the water a number of species new to us such as commerson's dolphins and South American sealions can be seen playing.

During the following morning we will cast anchor in the sheltered natural harbor of Port Stanley in the early afternoon. Utilizing our Zodiacs, we will land in the centre of this small city. Stanley is the only settlement on the islands of any size, with a population of around two thousand people. Behind the colourful buildings in neat rows, look closer and you will notice a very distinctly British feel to Stanley - Victorian houses which could be on any swanky London terrace line the harbourfront; red telephone and post boxes stand by the jetty; whitewashed pubs serve fish and chips alongside foaming pints of ale. The Falkland Islanders are proud of their unique homeland and capital, and Stanley is a great place to explore and soak up the local vibe. Highlights in the city include Christchurch Cathedral, the southernmost Anglican cathedral on Earth, as well as excellent shops selling local products (watch out for high quality woollen good in particular!), cafes and pubs offering a warm welcome, and several excellent museums; visitors are spoiled for choice! A short drive or a pleasant walk from the city are several stunning beaches; formerly heavily mined, these are now open, and locals and foreigners alike often visit to see the abundant penguins and spectacular gold-white sands.

## DAY 5-6 AT SEA, EN ROUTE TO SOUTH GEORGIA

From the Falklands, we set out eastwards again, following the furious seas towards South Georgia. Here we enter the Furious Fifties, the stretch of powerful waters marking the entry to Antarctic waters - watch the mercury drop





# Wild Earth Travel

*Small Ships, Big Adventures*

**wildearth-travel.com**

**info@wildearth-travel.com**

as we sail east; now we are truly in the Antarctic. Your crossing will benefit from our vessels' powerful engines, and the stability provided by the specially-designed X-Bow - making the journey in just two days!

In order to protect the extremely delicate and rich ecosystem of South Georgia, our dedicated Expedition Team will assist you to biosecure your clothing and equipment, while continuing with their in-depth lecture program, now focussing on the fascinating history, biology and wildlife of South Georgia. Be sure to wrap up warm and join your Expedition Team out on deck - this section of the South Atlantic is one of the most biologically productive on Earth, and is a haven for vast quantities of wildlife - from whales and albatross to penguins and seals. Watch the waves carefully - in this region, sub-Antarctic species (such as fur seals) mingle with true polar species (such as Adelie Penguins), creating a fascinating ecological mix.

## DAY 7-10 SOUTH GEORGIA ISLAND, WILDLIFE PARADISE OF THE SOUTH ATLANTIC

A strip of jagged mountains pierce the brooding clouds of the Southern Ocean. Icebound peaks loom over storm-washed beaches, while glaciers peek from the head of deep fjords. First believed to have been landed on by legendary explorer Captain James Cook, even to modern explorers, South Georgia presents a forbidding aura. But peer closer, and you will see greenery among the ice; movement on the beaches; wings in the skies above.

While it seems hard to believe today, South Georgia was once one of the most degraded environments on Earth. Hearing of the rich pickings, sealers flocked to the island after Cook, slaughtering wantonly. Once the seals had been almost exterminated, visiting ships sought larger prey, and South Georgia became the world's largest whaling destination, with several settlements built to carry out this industrialised slaughter. Whalers from Norway introduced reindeer as game, which soon destroyed the islands native vegetation, while brown rats (accidentally introduced by Europeans and their boats) feasted upon seabirds and their eggs - a horror against which these naive birds had no defence.

Thankfully, extensive conservation (including a painstaking eradication of reindeer and rats) has restored this magnificent island to its former glory - and glory it truly is. Beaches throng with hundreds of thousands of King Penguins, arguably some of Earth's most elegant animals. They must vie for space with the abundant Antarctic fur seals, all desperately defending territories and competing furiously for mates - and they themselves must avoid the southern

elephant seals, Earth's largest seals (weighing up to a staggering four tonnes). Tiny South Georgia Pippits and Pintail Ducks (once almost extinct) are now abundant, and petrels, albatross and shags nest on the steep hillsides and wheel in the air above. In the sea, leopard seals stalk for their next penguin meal, fur seal pups play in the shallows, and offshore, a huge variety of whale species gorge on krill. Nowhere else on Earth can boast such a diversity of wildlife, or in such quantities; South Georgia truly has to be experienced to be believed.

As in Antarctica, our exact itinerary will be dictated by weather and sea conditions, but especially by the wind and swell - nevertheless, our experienced Expedition Team and Captain will work their hardest to maximise opportunities to explore. Options include visiting the vast penguin colonies of Salisbury Plain and St Andrew's Bay, seeing the former whaling stations of Lieth and Stromness, drinking in the scenery and seal colonies of Gold Harbour, or exploring this island's fascinating exploration heritage at Grytviken (where legendary explorer Sir Ernest Shackleton is buried). South Georgia is one of those locations which grabs hold of the senses and never lets go; even long after departure, the jewel of the South Atlantic will captivate visitors for years to come.

## DAY 11-12 AT SEA - CROSSING THE DRAKE PASSAGE SOUTHBOUND

Now comes the time to cross the famed Drake Passage - the body of water separating Patagonia and the Antarctic Peninsula. The Drake Passage is known for rollicking conditions and strong westerly winds - the Furious Fifties and the Screaming Sixties. While this passage may be challenging, you can rest comfortably aboard our expedition vessels, which are purpose-built with stabilizers, powerful engines and manned by a highly-qualified crew. The most spirited sailors consider Drake Passage a lifetime achievement - and you will complete the crossing twice!

Our days in the Drake Passage will be put to good use preparing for our arrival in Antarctica - your Expedition Leader will brief you comprehensively on how to stay safe and minimise your impact on this precious wilderness, as well as briefing you thoroughly on our plans for our time spent exploring, including hints and tips for wildlife watching. Our dedicated Expedition Team will again assist you to biosecure your clothing and equipment, as well as sharing tailored lectures on Antarctic exploration history, wildlife, geology, glaciology and more!

# Wild Earth Travel

*Small Ships, Big Adventures*

**wildearth-travel.com**

**info@wildearth-travel.com**

## DAY 13-16 ANTARCTIC SOUND, ANTARCTIC PENINSULA AND SOUTH SHETLAND ISLANDS

Over the next days, we will enjoy a safe and exciting Antarctic experience explorers of yesteryear could only dream of.

Our Antarctic adventure begins in the South Shetland Islands, a chain of rugged rocks marking the northernmost point of Antarctica. It is also one of the richest in terms of wildlife, with large Gentoo and Chinstrap Penguin colonies, and an abundance of large seabirds such as predatory Giant Petrels. Landing sites which may be visited in the South Shetland Islands include the black steaming sands and rusting ruins of Deception Island (an active volcanic crater), the bustling penguin colonies of Aitcho and Half Moon Islands, or the old sealers' anchorage of Yankee Harbour.

The following days will be spent exploring further south on the Antarctic Peninsula in the Gerlache Strait region. This region is typically icy, so our exact route will be subject to careful planning by the Expedition Leader and Captain, and explained to our guests through regular evening briefings. However we will aim to visit a range of sites which showcase the best of this staggeringly beautiful region.

Consisting of the 'spine' of the Antarctic Peninsula and a large number of glaciated and mountainous islands, the Gerlache Strait is what comes to mind when most people think of Antarctica. Marvel at the massive icebergs and vast glaciers on a Zodiac cruise in Paradise Bay. Be moved by penguins tenderly caring for their precious eggs, and fiercely defending their nests on Cuverville Island. Watch cataracts of ice tumble into clear blue ocean on a hike over the active glaciers of Neko Harbour. Experience the Antarctica of old at historic huts such as Damoy Point, lovingly restored and open to all. Feel the spray of water from the blow of a humpback whale on a Zodiac safari in Wilhelmina Bay. Wonder at awe-inspiring scenery on a ship cruise through the Lemaire Channel. Wherever we go on the Antarctic Peninsula, endemic wildlife, tantalising history and breathtaking natural beauty abound.

On Antarctica, all human activity is subject to the whims of Mother Nature. While we will make every possible effort to maximise opportunities for exploration off the vessel, the safety of our guests and crew is our top priority. We therefore ask all our guests to join the expedition spirit and be flexible - harsh weather offers the opportunity to expand your knowledge of Antarctica with lectures from our expert Expedition Team, or to enjoy the superlative comfort of our vessels, be it wine-tasting, relaxing in the hot tubs, or recharging

with a relaxing massage in our Polar Spa.

## DAY 17-18 CROSSING THE DRAKE PASSAGE TOWARDS USHUAIA

We eventually depart Antarctica, and spend two days at sea on our way northwards back across the infamous Drake Passage towards the more welcoming shores of the Beagle Channel and Ushuaia, Argentina. During our time at sea, a variety of activities will be arranged on board to provide our guests with the chance to reflect on their voyage. Relax with an expertly crafted cocktail in the Nordic Bar in the company of new friends, soak up the knowledge and passion of our Expedition Team during lectures in the Shackleton Lounge, or simply enjoy the flight of the albatross which accompany us northwards.

During your last evening onboard, join the Captain and Officers for the Farewell Cocktail Party, followed by a presentation of photos and video by our onboard photographer - the ideal opportunity to re-live your Antarctic adventure. Skål!

## DAY 19 ARRIVAL IN USHUAIA AND DISEMBARKATION

On the morning of the final day of our voyage, we will arrive back at the pier of Ushuaia, Argentina. Trees, grass and a busy city may seem strange to you after the white wilderness of Antarctica! After a hearty breakfast, it is time to bid a fond farewell to the Crew and Albatros Expedition Team, and descend the gangway back to dry land with memories of the voyage of a lifetime.

### Please note:

Itineraries are subject to change.



# Wild Earth Travel

*Small Ships, Big Adventures*

**wildearth-travel.com**

**info@wildearth-travel.com**

## YOUR SHIP: OCEAN ALBATROS

<b>YOUR SHIP:</b>	<b>Ocean Albatros</b>
<b>VESSEL TYPE:</b>	<b>Luxury Expedition</b>
<b>LENGTH:</b>	<b>104.4 m</b>
<b>PASSENGER CAPACITY:</b>	<b>169 (95 cabins)</b>
<b>BUILT/REFURBISHED:</b>	<b>2022</b>

The Ocean Albatros, sistership to the Ocean Victory, will join the fleet of Albatros Expeditions in November 2022.

The Ocean Albatros will be deployed to a large selection of expedition cruise destinations, Antarctica, the Arctic, any various exciting new destinations in between.

With a total of 95 comfortable staterooms and suites, all with unobstructed sea view, most with their own balcony, the Ocean Albatros will definitely become one of the most popular expedition cruise vessels in the world. Like its sistership the Ocean Victory it offers two restaurants, a wellness area, an Albatros Nordic Bar, an open deck dining facility, a modern lecture lounge, and other state-of-the-art amenities. The vessel will have more than a 50% lower carbon footprint than traditional expedition vessels and be one of the most environmentally friendly, implementing the Green Initiative Program, ensuring both absolute comfort and sustainability for our guests. Unlike the Ocean Victory, the Ocean Albatros will also offer a unique panorama sauna, and a total of 12 dedicated solo travel cabins without a single-supplement.

### BRIDGE

Due to its important role as a control center for all nautical and

technical processes, the ship's bridge is a vital, sensitive place. Therefore, the bridge may not be accessible to the public at all times. Conditions permitting, we will be happy to welcome you into the bridge for a visit. Guests must be accompanied by the master or our expedition leader.

### STATEROOM SERVICE

Your stateroom is serviced daily. We provide a turn-down service. We provide meal to room only for serious cases of guest being sick. Our suites will have VIP services.

### ZODIAC LANDINGS

One feature of our expedition cruises includes landings and excursions aboard Ocean Albatros's fleet of 18 inflatable, motorized rubber "Zodiac" boats. The Zodiac brand has earned a well-deserved reputation as the sturdiest and safest small watercraft available. These boats have a low draft and great stability. Zodiacs are constructed for professional use and are outfitted with a top-quality outboard engine, yet their design minimally impacts the environment.

The Zodiacs are designed to provide unrestricted access to the world's last great frontier. Their versatility enables us to make landfall on remote shores, cruise along awe-inspiring coastlines and share breathtakingly close encounters with whales, seals, penguins, seabirds and more. We will come within arm's reach of icebergs and set foot on land discovered by pioneering explorers just over a century ago.

Your safety and comfort are our #1 priority, and your expedition leader will carefully plan for as many Zodiac excursions as possible, dependent upon the local weather and prevailing conditions. In each case, the expedition leader makes the final



# Wild Earth Travel

*Small Ships, Big Adventures*

**wildearth-travel.com**

**info@wildearth-travel.com**

decision if the landing is possible or not. Safety regulations apply on landings. All guests receive a mandatory instruction of the safety guidelines. Life jackets are mandatory to wear.

Please note, we highly recommend the use of waterproof bags in order to protect your personal camera or binoculars, as both hands must be free of everything during boarding. Participation is fairly easy and comfortable for able-bodied guests but can be more challenging for those with physical handicaps.

#### GRATUITIES

Following international standards in the service industry, it is customary to leave gratuity for the ship's crew at the end of the voyage. All gratuities will be divided among the crew. Typically, a recommended amount is approximately 13.5 USD per person per day. Gratuity is, of course, not required and any gratuity payments are voluntary.

#### DRESS CODE

The dress code on board is casual. Ties, jackets and evening dresses you may leave at home. It is rather more important to wear the right clothes in order to adapt to the different weather conditions. We recommend comfortable, breathable, waterproof and windproof clothing. Also, you should have a pair of gloves, thermal underwear and sturdy footwear in your luggage. For the captains and farewell cocktail, we recommend a smart casual dress style.

#### INTERNET / PHONE

Keep in mind, we will be cruising in a very remote region of the world. Where accessible, internet access is available for an extra charge. Mobile phone reception may be possible in select regions along our route. For further details please contact your mobile phone operator. Prices can be found in the information folder in your state room. Please ensure that your 'Data Roaming' function is switched off.

#### RECEPTION

The daily office hours of the board reception are from 06:00 until 23:00.

#### ALBATROS OCEAN SHOP

The selection of items available for purchase varies by ship, and may include a range of warm and practical clothing, as well as souvenirs, local arts and postcards at reasonable prices. A small selection of soap, toothpaste and other personal effects are also sold.

#### HEALTH / MEDICAL EMERGENCY

Each of our vessels has a small medical facility equipped with the necessary equipment and medicine to handle small emergencies. The infirmary is always staffed by a professionally licensed, English-speaking physician and nurse. Should a serious incident occur, the nearest hospital will be contacted. All guests must have personal travel/health insurance.

Although we do not have an official requirement regarding personal fitness, you should be able to move on board and ashore without the help of others. Please be aware that the ship does not provide wheelchair accessible state rooms.

Due to safety reasons a cruise is only possible for pregnant women until the 24th week of pregnancy. The state of pregnancy must be presented by a medical certificate.

#### PHYSICAL DISABILITIES / WHEELCHAIR ACCESSIBILITY

Guests with physical disabilities are recommended to travel with an accompanying person. The processes on board should be handled without external help. The gangway can be - depending on the individual disability - a challenge. The angle of inclination of the gangway varies due to tide and different circumstances in the respective port. Please note that the guest's participation in shore excursions as well as the (dis-)embarkation by Zodiac can



# Wild Earth Travel

*Small Ships, Big Adventures*

**wildearth-travel.com**

**info@wildearth-travel.com**

be denied by the expedition leader due to security reasons. The instructions of the expedition leader must be followed. The ship is not suitable for wheelchairs.

## SEASICKNESS / STABILISATORS

The ship is equipped with stabilizers in order to reduce the ship's roll. However, these expeditions are hosted in remote regions, and it is possible to periodically encounter changing environments and climate patterns, including rough seas and large swells. Seasickness patches (Scopoderm or similar) work solely or in part to help cure nausea for most people. These medicines can cause sleepiness. If you are prone to motion sickness, consult with your doctor prior to departure to help ensure your comfort while travelling.

## SPECIAL DIETARY REQUESTS

All meals on board the vessel is chef-prepared. If you have special dietary requirements (food allergies, intolerances, health conditions or religious preferences), please inform us as early as possible - ideally, no later than 2 weeks before departure. In order to ensure efficient service, please re-confirm your requirements with the crew upon boarding the ship.

## LAUNDRY

If you wish to have some laundry done while aboard the ship, laundry service is available for an additional fee.

tional fee.



Wild Earth Travel

*Small Ships, Big Adventures*

**0800 945 3327** (within New Zealand) | +64 (0) 3 365 1355 | **1800 107 715** (within Australia)

info@wildearth-travel.com | **wildearth-travel.com**



**Wild Earth Travel**  
*Small Ships, Big Adventures*

**wildearth-travel.com**

**info@wildearth-travel.com**

**INSIDE YOUR SHIP**

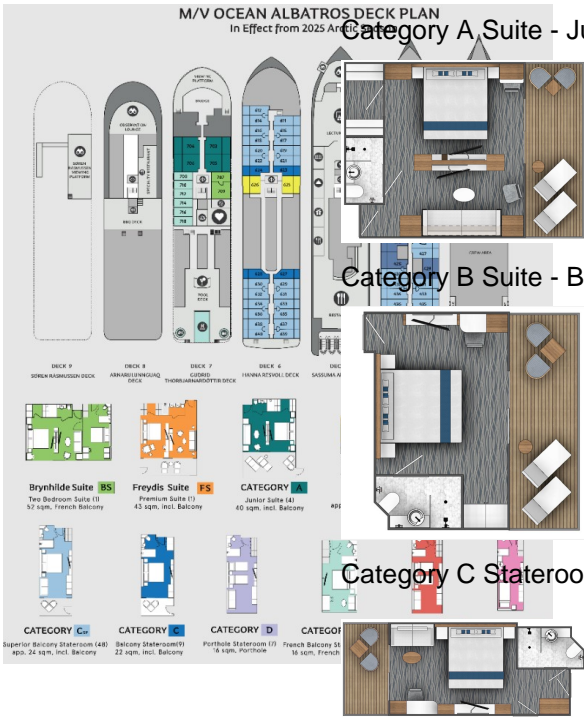

Category A Suite - Junior suite



Category C Stateroom - Balcony State



Category D Stateroom - Albatros State



Category E Stateroom - French Balcony

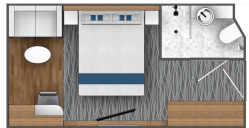



# Wild Earth Travel

*Small Ships, Big Adventures*

**wildearth-travel.com**

**info@wildearth-travel.com**

## PRICING

### 16-Dec-2025 to 03-Jan-2026

Category F Stateroom - Triple Stateroom (Porthole)	18095 USD pp
Category D Stateroom - Albatros Stateroom (Porthole)	21095 USD pp
Category E Stateroom - French Balcony Stateroom	22295 USD pp
Category C Stateroom - Balcony Stateroom	22895 USD pp
Category G Stateroom - Single Stateroom (Porthole)	26495 USD pp
Category B Suite - Balcony Suite	30195 USD pp
Category A Suite - Junior Suite	38595 USD pp
Premium Suite - Freydis Suite	43395 USD pp
Family Suite - Brynhilde Suite	43395 USD pp

### 17-Jan-2027 to 04-Feb-2027

Category F Stateroom - Triple Stateroom (Porthole)	20195 USD pp
Category D Stateroom - Albatros State Stateroom (Porthole)	23495 USD pp
Category E Stateroom - French Balcony Stateroom	24895 USD pp
Category C Stateroom - Balcony State Stateroom	25495 USD pp
Category G Stateroom - Single Stateroom (Porthole)	29495 USD pp
Category B Suite - Balcony Suite	29495 USD pp
Category A Suite - Junior suite	42995 USD pp
Premium Suite	48295 USD pp

### 11-Feb-2027 to 01-Mar-2027

Category F Stateroom - Triple Stateroom (Porthole)	19095 USD pp
Category D Stateroom - Albatros Stateroom (Porthole)	22295 USD pp
Category E Stateroom - French Balcony Stateroom	23595 USD pp
Category C Stateroom - Balcony Stateroom	24195 USD pp
Category G Stateroom - Single Stateroom (Porthole)	27995 USD pp
Category B Suite - Balcony Suite	31895 USD pp
Category A Suite - Junior Suite	40795 USD pp
Premium Suite - Freydis Suite	45895 USD pp
Family Suite - Brynhilde Suite	45895 USD pp



# Wild Earth Travel

*Small Ships, Big Adventures*



**wildearth-travel.com**

**info@wildearth-travel.com**

## **Optional extras & upgrades**

**Kayaking 345 USD**



**Wild Earth Travel**

*Small Ships, Big Adventures*

**0800 945 3327** (within New Zealand) | +64 (0) 3 365 1355 | **1800 107 715** (within Australia)

info@wildearth-travel.com | **wildearth-travel.com**