

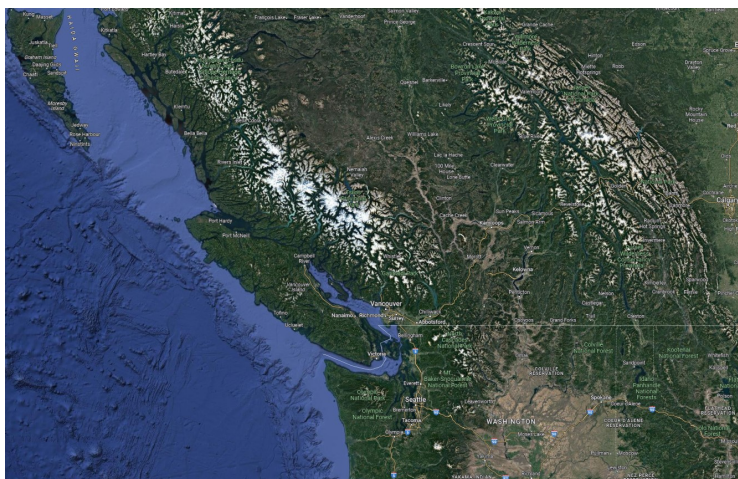

## DESOLATION SOUND IN SPRING - BRITISH COLUMBIA CRUISE

Explore the stunning waterways, fjords and islands of Desolation Sound, one of the world's most popular cruising destinations. Your small boat tour here in spring lets you experience the power of nature without the summer crowds. See the sample itinerary above, or the photo gallery below for more information. Download the brochure for all the details.



### ITINERARY

#### Day 1 Embarkation

Welcome aboard in Campbell River and cruise to Cortez Island. Rainforest walk with naturalist. Small community visit. Welcome Dinner.

#### Day 2 West Redonda Island

Cruise to spectacular Teakeme Arm on West Redonda Island. Here waterfalls plunge down a steep cut in the island's cliffs, where we'll moor. Dry rainforest and rocky buff walk to a lake with a picnic lunch. Cruising the scenic passages between West Rodonda and the mainland. Entering a small fjord at Roscoe Bay. Anchorage and beach walk and optional evening kayak.

#### Day 3 Toba Inlet

Sail or cruise into Toba Inlet. This spectacular fjord, 35 km long, cuts deep into



# Wild Earth Travel

*Small Ships, Big Adventures*

**wildearth-travel.com**

**info@wildearth-travel.com**

the coast mountains. As you cruise the snow-capped peaks tower above. Watch for seals and sea lions, seabirds and other animals. Evening arrive at Prideaux Haven, at the confluence of Malaspina Inlet and Homfray Channel.

## Day 4 Prideaux Haven

Explore Prideaux Haven. Cruise the mainland shore to the Copeland Islands. Investigate the wildlife that live on these small islets by journeying ashore with your naturalist.

## Day 5 Campbell River

Cruise to Campbell River across the Strait of Georgia watching for wildlife. Possible sightings of bald eagles, seals, sea lions, and marine birds.

### Please Note:

Note that as with all expedition cruises, the itinerary may change based on weather, wildlife activity, and interests of the guests. This itinerary is to give you a general idea of the trip.

**Wild Earth Travel**

*Small Ships, Big Adventures*

**0800 945 3327** (within New Zealand) | +64 (0) 3 365 1355 | **1800 107 715** (within Australia)

info@wildearth-travel.com | **wildearth-travel.com**



[wildearth-travel.com](http://wildearth-travel.com)

[info@wildearth-travel.com](mailto:info@wildearth-travel.com)

## YOUR SHIP: CASCADIA

<b>YOUR SHIP:</b>	<b>Cascadia</b>
<b>VESSEL TYPE:</b>	<b>Catamaran</b>
<b>LENGTH:</b>	<b>138 ft / 42 m</b>
<b>PASSENGER CAPACITY:</b>	<b>24</b>
<b>BUILT/REFURBISHED:</b>	<b>2007/2018/2019</b>

Cascadia is a go-anywhere, expedition style catamaran. She accommodates up to 24 guests in 12 luxurious cabins, with a crew of 10. She is unlike any other vessel offering expeditions on the British Columbia coast, having been built specifically for high-quality, boutique cruises. Light, spacious and comfortable, she is also capable of reaching the wildest, most naturally rich places on the coast. Her small size and guest numbers provide an authentic, human-scale experience that respects the carrying capacity of coastal inlets and communities.

**Ship And Accommodations** Find comfort and solitude in your private cabin or enjoy time in any of the interior or outdoor lounges, or the "open" bridge. Cascadia's large windows bring the outside in, and her separate dining area becomes a sophisticated "long table" event for meals. Her decks are wide and welcoming, with seating areas on different levels.

**Salon** Large windows surround the salon making it a perfect place to look for whales while staying protected, chat with other guests while lounging on our comfortable sofas, or enjoy a beverage from the nearby bar.

**Dining Area** Enjoy our chefs' fine west-coast influenced creations while watching the sun go down. Sit and discuss your day's

adventure with your captain, afloat in a remote natural anchorage.

**Terrace Lounge And Dining Area** Dine alfresco on temperate evenings, lounge with your morning coffee, or watch the world go by during the day. This area is the perfect mix of outside and inside.

**Bridge of Cascadia** Cascadia's bridge is open to you. You'll have 180-degree views from here, along with being able to learn about navigation and the vessel systems from our crew. On the port side, you may also enjoy our indoor-outdoor loveseat. You can watch the world go by from behind a protective window, but still have quick access to the fresh air and the deck for whale watching.

**Top Deck & Hot Tub Lounge** on a chaise, soak under the stars, or enjoy the bird's eye view of the ship and the world around her from Cascadia's new top deck.

**Cabins** All cabins have individual climate control, wardrobes and an outside location, with windows for natural light. All have ensembles. All are 'outside' cabins, with windows for natural light. **Kayaks, Shore Boats, Naturalist Tools** Cascadia has 6 double and 2 single kayaks for paddling in coves and bays, as well as two beautiful landing craft style tenders, custom designed for our program. She carries a suite of tools for exploring the natural world, including a hydrophone for listening to whales. Her library contains books on the cultural history and nature of the BC and Alaska coast.





**Wild Earth Travel**  
*Small Ships, Big Adventures*

**wildearth-travel.com**

**info@wildearth-travel.com**



aska coast.

# Wild Earth Travel

*Small Ships, Big Adventures*

[wildearth-travel.com](http://wildearth-travel.com)

[info@wildearth-travel.com](mailto:info@wildearth-travel.com)

## INSIDE YOUR SHIP

TOP DECK

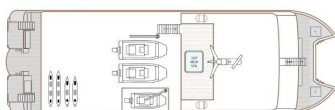

BRIDGE DECK

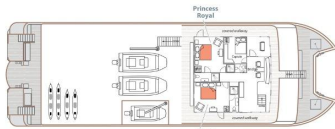

MAIN DECK



LOWER DECK

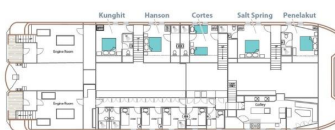

Cabin

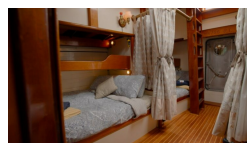

Category 1



Category 2



Category 3



Wild Earth Travel  
*Small Ships, Big Adventures*

0800 945 3327 (within New Zealand) | +64 (0) 3 365 1355 | 1800 107 715 (within Australia)

[info@wildearth-travel.com](mailto:info@wildearth-travel.com) | [wildearth-travel.com](http://wildearth-travel.com)



# Wild Earth Travel

*Small Ships, Big Adventures*



**wildearth-travel.com**

**info@wildearth-travel.com**

## PRICING

**28-Apr-2026 to 02-May-2026**

<b>Cabin</b>	<b>3650 CAD pp</b>
--------------	--------------------

**03-May-2026 to 07-May-2026**

<b>Category 1</b>	<b>5500 CAD pp</b>
-------------------	--------------------

<b>Category 2</b>	<b>6450 CAD pp</b>
-------------------	--------------------

<b>Category 3</b>	<b>7425 CAD pp</b>
-------------------	--------------------

**03-May-2026 to 07-May-2026**

<b>Cabin</b>	<b>3650 CAD pp</b>
--------------	--------------------



**Wild Earth Travel**  
*Small Ships, Big Adventures*

**0800 945 3327** (within New Zealand) | +64 (0) 3 365 1355 | **1800 107 715** (within Australia)

info@wildearth-travel.com | **wildearth-travel.com**