

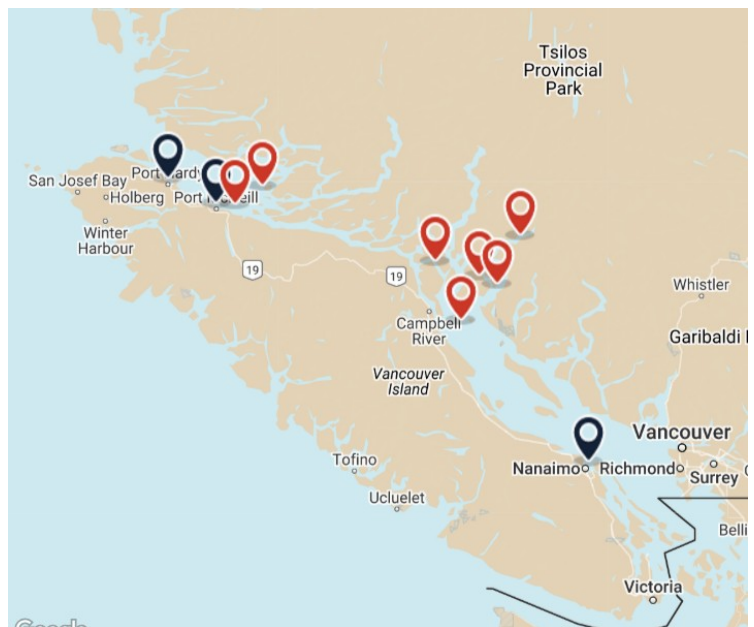

DESOLATION SOUND & FJORDS OF BRITISH COLUMBIA CRUISE

From backwaters to wildlife hotspots to cultural sites, this journey among the islands and fjords of the storied British Columbia coast includes Desolation Sound and the Broughton Archipelago as well as neighbouring inlets. This is the place off the edge of Vancouver Island that most people never see. Snowcapped mountains, glacier-fed fjords, calm and scenic cruising are the backdrop to our journey through the nature and wildlife of the west coast - from rainforest to bears and dolphins. On the cultural side, we partner with the Klahoose Nation to experience their bear viewing in a fjord; work with the Namgis U'mista Cultural Centre in Alert Bay, and usually visit local legend Billy Proctor and other out-of-the-way places, too.



ITINERARY

Day: 1: Board vessel

Board vessel and cruising to anchorage in the Broughton Archipelago. Hike to spectacular view.

Day: 2: Alert Bay and U'mista Cultural Centre

Small boat trip to explore the marine life of the archipelago: kelp forest, seabirds and marine mammals such as sea lions and whales. Heading deeper into the islands to visit Billy Proctor's museum and homestead. Visit Alert Bay and U'mista Cultural Centre with private guided tour of Kwakwaka'wakw potlatch collection. Evening cruising to island anchorage for alfresco dinner, keeping eyes and ears out for wildlife.



Day: 3: Johnstone Strait

Morning kayaking. Whale watching and marine science. Rainforest hike. Cruising south in Johnstone Strait.

Note that as with all expedition cruises, the itinerary may change based on weather, wildlife activity, and interests of the guests. This itinerary is to give you a general idea of the trip.

Day: 4: Discovery Islands and back channels

Exploring the cascades and waterways of the Discovery Islands and back channels. Shore trips to explore life in this region -- beaches, culture site. Kayaking. Aft deck barbecue and bubbly.

Day: 5: Toba Inlet

Exploring spectacular Toba Inlet, a fjord that cuts 35 kilometres into the Coast Mountains. Shore trips to explore the nature of estuary meadows and the coastal rainforest. Visit with our friends from the Klahoose Nation's viewing stands where grizzly bears fish salmon at several sites along the river. Island anchorage.

Day: 6: Desolation Sound

Exploring Desolation Sound -- by kayaking, small boats, walks, on sites such as Prideaux Haven, the Redonda Islands.

Day: 7: Gulf Islands

Exploring the islets and more mediterranean climate northern Gulf Islands, watching for marine mammals and birds. Island and beach hike. Intertidal exploration.

Day: 8: Disembarkation

Cruising to port, watching for wildlife.

Please Note:



0800 945 3327 (within New Zealand) | +64 (0) 3 365 1355 | **1800 107 715** (within Australia)

info@wildearth-travel.com | wildearth-travel.com



wildearth-travel.com

info@wildearth-travel.com

YOUR SHIP: CASCADIA

YOUR SHIP:	Cascadia
VESSEL TYPE:	Catamaran
LENGTH:	138 ft / 42 m
PASSENGER CAPACITY:	24
BUILT/REFURBISHED:	2007/2018/2019

Cascadia is a go-anywhere, expedition style catamaran. She accommodates up to 24 guests in 12 luxurious cabins, with a crew of 10. She is unlike any other vessel offering expeditions on the British Columbia coast, having been built specifically for high-quality, boutique cruises. Light, spacious and comfortable, she is also capable of reaching the wildest, most naturally rich places on the coast. Her small size and guest numbers provide an authentic, human-scale experience that respects the carrying capacity of coastal inlets and communities.

Ship And Accommodations Find comfort and solitude in your private cabin or enjoy time in any of the interior or outdoor lounges, or the "open" bridge. Cascadia's large windows bring the outside in, and her separate dining area becomes a sophisticated "long table" event for meals. Her decks are wide and welcoming, with seating areas on different levels.

Salon Large windows surround the salon making it a perfect place to look for whales while staying protected, chat with other guests while lounging on our comfortable sofas, or enjoy a beverage from the nearby bar.

Dining Area Enjoy our chefs' fine west-coast influenced creations while watching the sun go down. Sit and discuss your day's

adventure with your captain, afloat in a remote natural anchorage.

Terrace Lounge And Dining Area Dine alfresco on temperate evenings, lounge with your morning coffee, or watch the world go by during the day. This area is the perfect mix of outside and inside.

Bridge of Cascadia Cascadia's bridge is open to you. You'll have 180-degree views from here, along with being able to learn about navigation and the vessel systems from our crew. On the port side, you may also enjoy our indoor-outdoor loveseat. You can watch the world go by from behind a protective window, but still have quick access to the fresh air and the deck for whale watching.

Top Deck & Hot Tub Lounge on a chaise, soak under the stars, or enjoy the bird's eye view of the ship and the world around her from Cascadia's new top deck.

Cabins All cabins have individual climate control, wardrobes and an outside location, with windows for natural light. All have ensembles. All are 'outside' cabins, with windows for natural light. **Kayaks, Shore Boats, Naturalist Tools** Cascadia has 6 double and 2 single kayaks for paddling in coves and bays, as well as two beautiful landing craft style tenders, custom designed for our program. She carries a suite of tools for exploring the natural world, including a hydrophone for listening to whales. Her library contains books on the cultural history and nature of the BC and Alaska coast.



Wild Earth Travel
Small Ships, Big Adventures

wildearth-travel.com **info@wildearth-travel.com**



aska coast.

Wild Earth Travel

Small Ships, Big Adventures

wildearth-travel.com

info@wildearth-travel.com

INSIDE YOUR SHIP

TOP DECK

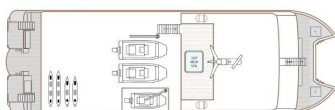

BRIDGE DECK

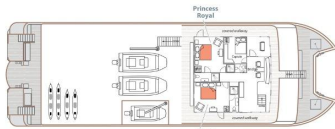

MAIN DECK



LOWER DECK

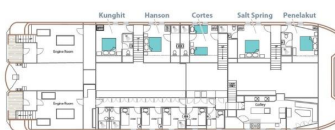

Category 1



Category 2



Category 3





wildearth-travel.com

info@wildearth-travel.com

PRICING

20-Oct-2025 to 27-Oct-2025

Category 1	8070 CAD pp
Category 2	9640 CAD pp
Category 3	10970 CAD pp

18-Oct-2026 to 26-Oct-2026

Category 1	9250 CAD pp
Category 2	11050 CAD pp
Category 3	12600 CAD pp
9 Day Port McNeill to Sidney Cruise	0 pp