



Wild Earth Travel

Small Ships, Big Adventures



wildearth-travel.com

info@wildearth-travel.com

CLASSIC SCOTTISH LUXURY HOTEL BARGES CRUISE

Scotland makes up the northern third of the Island of Great Britain. Other than neighbouring England in the southeast, the coast of Scotland is surrounded by nothing but the vast Atlantic Ocean. The Scottish Highlands are truly underrated and underappreciated by a majority of the world, Scotland is full of charm, character, history, and spectacular scenery.

The waters of Scotland are among the most beautiful and breathtaking in the world. Our luxury hotel barges cruise through the magical Great Glen, located between the historic city centre of Inverness, regarded as the capital of the Highlands, and the historic town of Fort William stretching the east to the west coast of Scotland. Everything about this cruise will leave you with everlasting memories of your hotel barging holiday.

On the boat's journey, you will be able to take in the charming heather-clad hilltops and ancient castles that decorate the Scottish canals. Over the duration of your holiday, we will be serenely cruising through some of the most stunning lochs that Scotland has to offer such as the infamous Loch Ness and Loch Oich, as well as navigating through the complex Caledonian Canal, a true engineering masterpiece.

You will also get the chance to pass through the infamous Loch Ness, giving you the unique opportunity to get your own sighting of the mythical Loch Ness Monster. The Loch is not just about its mythical stories, it has stunning scenery and architecture such as Urquhart Castle, making it a destination that you just cannot miss. The enchanting scenery and the history of the Scottish

Highlands make this truly one of the most phenomenal inland cruising experiences in the world.

Scotland Barge Cruise Highlights

The Scottish canal cruises on board The Scottish Highlander and The Spirit Of Scotland travel through some of the country's most amazing scenery. Thanks to its vast canals, lochs and rivers that run through the enchanting countryside, Scotland is undoubtedly one of the best countries to see from the water in the world.

On board our luxury vessels Scotland's stunning lochs and Caledonian Canals are fully accessible, allowing you to unlock the beauty of the waterways, no matter what the weather. There is no better way to travel the waters than in one of our incredibly luxurious barge hotels.

Over the course of the cruise, we will travel between the northeastern coastal city of Inverness and the mountainous town of Fort William, deep within the highlands. A popular stop along our cruises is at the many castles along our journey. You will get to experience the beauty of castles such as Cawdor Castle, immortalised in Shakespeare's Macbeth, as well as the stunning Urquhart Castle ruins.



Wild Earth Travel
Small Ships, Big Adventures

0800 945 3327 (within New Zealand) | +64 (0) 3 365 1355 | **1800 107 715** (within Australia)

info@wildearth-travel.com | **wildearth-travel.com**

Wild Earth Travel

Small Ships, Big Adventures

wildearth-travel.com

info@wildearth-travel.com

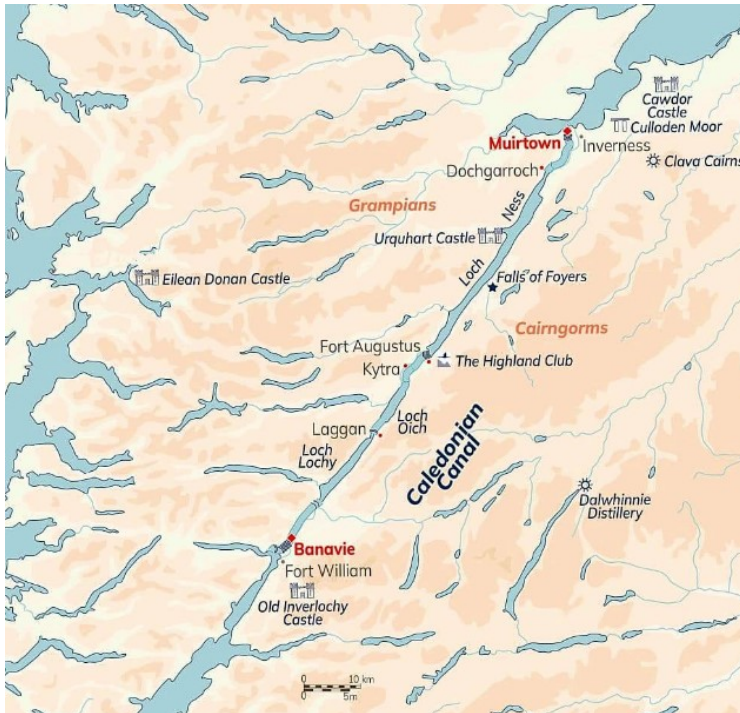

stle ruins.

ITINERARY

Day 1 Banavie

Guests are met at our designated meeting point in Inverness and transferred by private chauffeured minibus to Spirit of Scotland. A champagne welcome by the Captain and crew and perhaps an early evening stroll before our first dinner on board.

Day 2 Banavie to Laggan

We begin our week this morning with a cruise through Moy Bridge, the last hand-operated bridge of its type on the waterway, before crossing Loch Lochy.

As we approach our mooring at Laggan, a Highland Piper may be there to greet us with a stirring rendition of traditional Scottish music. After lunch on board, our tour today takes us to Dalwhinnie Distillery, built in 1897 and the highest distillery in Scotland. We are given a fascinating description of the maturing and ageing process of their whiskies, each with its distinctive characteristics, followed by a special tasting of several single malts. If time permits, we can also visit the ruins of Old Inverlochy Castle. Dinner on board.

Day 3 Laggan to Kytra

This morning we cruise across the very scenic Loch Oich, perhaps stopping en route for a spot of fishing or a gentle stroll, then onto our pretty mooring at Kytra. After lunch on board we take in some of the finest scenery Scotland has to offer as we drive to one of its best known and most photographed castles, Eilean Donan, which has featured in movies such as "Highlander" and James Bond's "The World Is Not Enough" and overlooks three sea lochs. Dinner on board.

Day 4 Kytra to Fort Augustus

After breakfast, we visit the private Highland Club, a spectacular exclusive set of residences and a former 19th century Benedictine Monastery. Here we are treated to a falconry and birds of prey demonstration*** on the banks of Loch Ness, and the majesty of the swooping birds against the backdrop of the sweeping Scottish Highlands is not easily forgotten. There is time to explore the pretty village of Fort Augustus before lunch on board, after which we cruise to Fort Augustus and down the "flight of locks" as the locals call it, to moor opposite the Benedictine Abbey at the entrance to Loch Ness. This evening we dine ashore at a local restaurant.

Day 5 Fort Augustus to Dochgarroch

This morning we enjoy a picturesque cruise across world-famous Loch Ness, with perhaps a chance of spotting "Nessie", where en-route we pass Urquhart Castle, navigating closely beneath its spectacular 13th century ruins, before continuing our cruise to moor at the hamlet of Dochgarroch. After lunch we visit Cawdor Castle*, forever immortalised in Shakespeare's "Scottish Play", Macbeth. The picturesque gardens have been listed amongst the top 100 in the UK. The castle contains a superb collection of tapestries, pictures and furnishings and is still in use as a home for the Dowager Countess of Cawdor

Wild Earth Travel

Small Ships, Big Adventures

0800 945 3327 (within New Zealand) | +64 (0) 3 365 1355 | 1800 107 715 (within Australia)

info@wildearth-travel.com | wildearth-travel.com

Wild Earth Travel

Small Ships, Big Adventures



wildearth-travel.com

info@wildearth-travel.com

who resides there for several months of the year. Dinner on board.

Day 6 Dochgarroch to Muirtown

This morning, our final cruise takes us through Tomnahurich swing bridge to the locks at Muirtown, where there is the opportunity to take a bicycle ride or stroll to the sea lock with wonderful views over the Moray and Beauly Firths. After lunch we visit Culloden Moor, scene of the last major battle on British soil in 1746, where English Government troops faced the Highlanders of "Bonnie Prince Charlie". If time allows, then we take a tour of Clava Cairns, a pre-historic clan chieftain burial site dating back to 2,000 B.C and setting for the Outlander TV series. Captain's Farewell Dinner on board.

Day 7 Muirtown

After breakfast, guests are transferred by private chauffeured minibus to their choice of location in Inverness

Please Note:

This is a sample itinerary and is subject to change. Please note, the excursion to Cawdor Castle is only possible between early May and the end of September. A visit to Fort George will replace it either side of these dates.

Wild Earth Travel

Small Ships, Big Adventures

0800 945 3327 (within New Zealand) | +64 (0) 3 365 1355 | **1800 107 715** (within Australia)

info@wildearth-travel.com | **wildearth-travel.com**

Wild Earth Travel

Small Ships, Big Adventures

wildearth-travel.com

info@wildearth-travel.com

YOUR SHIP: SCOTTISH HIGHLANDER

YOUR SHIP: Scottish Highlander

VESSEL TYPE: Hotel Barge

LENGTH: 117 feet

PASSENGER CAPACITY: 8

BUILT/REFURBISHED:

Scottish Highlander has the atmosphere of a comfortable Country House with subtle use of tartan furnishings and landscape paintings, a reminder of the spectacular surroundings to be seen on your voyage through the Great Glen.

At 117 feet long, she is spacious and has every comfort needed for enjoying the magnificence of the Scottish Highlands during Spring, Summer and Autumn.

The warm and welcoming saloon features rich-coloured wooden panelling, large picture windows and comfortable leather Chesterfield sofas to relax in, perhaps with a mellow single malt whisky from the very well-stocked bar.

Accommodation for eight guests is in three twin/double staterooms and one larger twin/double junior suite, each one centrally heated and with en suite facilities.

There is a cosy observation area behind the wheelhouse where you can admire the passing scenery and chat to the Captain about life on the Caledonian Canal and its interconnecting lochs. On the forward deck area, there is more seating where you can take in the far-reaching views and take photographs as Scottish Highlander plots her course past landmarks such as Urquhart Castle perched alongside Loch Ness.

A cruise on mystical waterways aboard Scottish Highlander as you marvel at some of Scotland's finest scenery will be one that stays in the memory for a long time.

Cuisine is traditional Scottish fare - salmon, game and seafood, prepared by your own Master Chef, and the hotel barge's experienced crew of four will take care of your every need.



every need.

Wild Earth Travel

Small Ships, Big Adventures

0800 945 3327 (within New Zealand) | +64 (0) 3 365 1355 | **1800 107 715** (within Australia)

info@wildearth-travel.com | **wildearth-travel.com**

Wild Earth Travel

Small Ships, Big Adventures

wildearth-travel.com

info@wildearth-travel.com

INSIDE YOUR SHIP

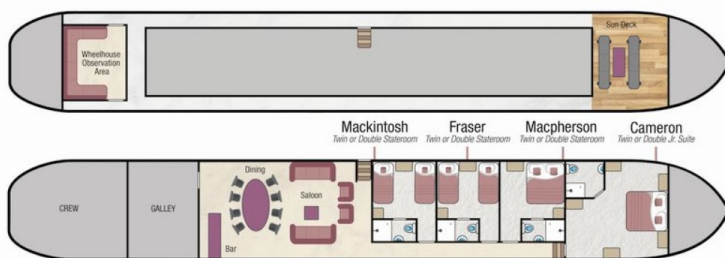

Cabin



Cabin. From



Wild Earth Travel

Small Ships, Big Adventures

0800 945 3327 (within New Zealand) | +64 (0) 3 365 1355 | 1800 107 715 (within Australia)

info@wildearth-travel.com | wildearth-travel.com

Wild Earth Travel

Small Ships, Big Adventures

wildearth-travel.com

info@wildearth-travel.com

PRICING

13-Jul-2025 to 19-Jul-2025

Cabin. From 6090 EUR pp

13-Jul-2025 to 19-Jul-2025

Cabin 6550 EUR pp

20-Jul-2025 to 26-Jul-2025

Cabin 6550 EUR pp

20-Jul-2025 to 26-Jul-2025

Cabin. From 6090 EUR pp

27-Jul-2025 to 02-Aug-2025

Cabin 6550 EUR pp

27-Jul-2025 to 02-Aug-2025

Cabin. From 6090 EUR pp

03-Aug-2025 to 09-Aug-2025

Cabin 6550 EUR pp

03-Aug-2025 to 09-Aug-2025

Cabin. From 6090 EUR pp

10-Aug-2025 to 16-Aug-2025

Cabin 6550 EUR pp

10-Aug-2025 to 16-Aug-2025

Cabin. From 6090 EUR pp

17-Aug-2025 to 23-Aug-2025

Cabin. From 6090 EUR pp

17-Aug-2025 to 23-Aug-2025

Cabin 6550 EUR pp

24-Aug-2025 to 30-Aug-2025

Cabin 6550 EUR pp

24-Aug-2025 to 30-Aug-2025

Cabin. From 6090 EUR pp

31-Aug-2025 to 06-Sep-2025

Cabin. From 6090 EUR pp

31-Aug-2025 to 06-Sep-2025

Cabin 6550 EUR pp

07-Sep-2025 to 13-Sep-2025

Cabin. From 6090 EUR pp

07-Sep-2025 to 13-Sep-2025

Cabin 6550 EUR pp

14-Sep-2025 to 20-Sep-2025

Cabin. From 6090 EUR pp

14-Sep-2025 to 20-Sep-2025

Cabin 6550 EUR pp

21-Sep-2025 to 27-Sep-2025

Cabin 6550 EUR pp

21-Sep-2025 to 27-Sep-2025

Cabin. From 6090 EUR pp

Wild Earth Travel

Small Ships, Big Adventures

0800 945 3327 (within New Zealand) | +64 (0) 3 365 1355 | **1800 107 715** (within Australia)

info@wildearth-travel.com | wildearth-travel.com

Wild Earth Travel

Small Ships, Big Adventures



wildearth-travel.com

info@wildearth-travel.com

28-Sep-2025 to 04-Oct-2025

Cabin	6550 EUR pp
-------	-------------

12-Apr-2026 to 18-Apr-2026

Cabin	5690 EUR pp
-------	-------------

28-Sep-2025 to 04-Oct-2025

Cabin. From	6090 EUR pp
-------------	-------------

12-Apr-2026 to 18-Apr-2026

Cabin. From	5250 EUR pp
-------------	-------------

05-Oct-2025 to 11-Oct-2025

Cabin. From	6090 EUR pp
-------------	-------------

05-Oct-2025 to 11-Oct-2025

Cabin	6550 EUR pp
-------	-------------

12-Oct-2025 to 18-Oct-2025

Cabin. From	5250 EUR pp
-------------	-------------

12-Oct-2025 to 18-Oct-2025

Cabin	5690 EUR pp
-------	-------------

19-Oct-2025 to 25-Oct-2025

Cabin	5690 EUR pp
-------	-------------

19-Oct-2025 to 25-Oct-2025

Cabin. From	5250 EUR pp
-------------	-------------

26-Oct-2025 to 01-Nov-2025

Cabin	5690 EUR pp
-------	-------------

29-Mar-2026 to 04-Apr-2026

Cabin. From	5250 EUR pp
-------------	-------------

05-Apr-2026 to 11-Apr-2026

Cabin	5690 EUR pp
-------	-------------

05-Apr-2026 to 11-Apr-2026

Cabin. From	5250 EUR pp
-------------	-------------

Wild Earth Travel
Small Ships, Big Adventures

0800 945 3327 (within New Zealand) | +64 (0) 3 365 1355 | **1800 107 715** (within Australia)

info@wildearth-travel.com | wildearth-travel.com

Wild Earth Travel

Small Ships, Big Adventures

wildearth-travel.com

info@wildearth-travel.com

PRICING

19-Apr-2026 to 25-Apr-2026

Cabin. From	5250 EUR pp
-------------	-------------

19-Apr-2026 to 25-Apr-2026

Cabin	5690 EUR pp
-------	-------------

26-Apr-2026 to 02-May-2026

Cabin	5690 EUR pp
-------	-------------

26-Apr-2026 to 02-May-2026

Cabin. From	5250 EUR pp
-------------	-------------

03-May-2026 to 09-May-2026

Cabin	6550 EUR pp
-------	-------------

03-May-2026 to 09-May-2026

Cabin. From	6090 EUR pp
-------------	-------------

10-May-2026 to 16-May-2026

Cabin	6550 EUR pp
-------	-------------

10-May-2026 to 16-May-2026

Cabin. From	6090 EUR pp
-------------	-------------

17-May-2026 to 23-May-2026

Cabin	6550 EUR pp
-------	-------------

17-May-2026 to 23-May-2026

Cabin. From	6090 EUR pp
-------------	-------------

24-May-2026 to 30-May-2026

Cabin. From	6090 EUR pp
-------------	-------------

24-May-2026 to 30-May-2026

Cabin	6550 EUR pp
-------	-------------

31-May-2026 to 06-Jun-2026

Cabin	6550 EUR pp
-------	-------------

31-May-2026 to 06-Jun-2026

Cabin. From	6090 EUR pp
-------------	-------------

07-Jun-2026 to 13-Jun-2026

Cabin. From	6090 EUR pp
-------------	-------------

07-Jun-2026 to 13-Jun-2026

Cabin	6550 EUR pp
-------	-------------

14-Jun-2026 to 20-Jun-2026

Cabin	6550 EUR pp
-------	-------------

14-Jun-2026 to 20-Jun-2026

Cabin. From	6090 EUR pp
-------------	-------------

21-Jun-2026 to 27-Jun-2026

Cabin. From	6090 EUR pp
-------------	-------------

21-Jun-2026 to 27-Jun-2026

Cabin	6550 EUR pp
-------	-------------

28-Jun-2026 to 04-Jul-2026

Cabin. From	6090 EUR pp
-------------	-------------

28-Jun-2026 to 04-Jul-2026

Cabin	6550 EUR pp
-------	-------------

Wild Earth Travel

Small Ships, Big Adventures

0800 945 3327 (within New Zealand) | +64 (0) 3 365 1355 | **1800 107 715** (within Australia)

info@wildearth-travel.com | wildearth-travel.com

Wild Earth Travel

Small Ships, Big Adventures



wildearth-travel.com

info@wildearth-travel.com

05-Jul-2026 to 11-Jul-2026

Cabin	6550 EUR pp
-------	-------------

16-Aug-2026 to 22-Aug-2026

Cabin	6550 EUR pp
-------	-------------

05-Jul-2026 to 11-Jul-2026

Cabin. From	6090 EUR pp
-------------	-------------

16-Aug-2026 to 22-Aug-2026

Cabin. From	6090 EUR pp
-------------	-------------

12-Jul-2026 to 18-Jul-2026

Cabin	6550 EUR pp
-------	-------------

12-Jul-2026 to 18-Jul-2026

Cabin. From	6090 EUR pp
-------------	-------------

19-Jul-2026 to 25-Jul-2026

Cabin. From	6090 EUR pp
-------------	-------------

19-Jul-2026 to 25-Jul-2026

Cabin	6550 EUR pp
-------	-------------

26-Jul-2026 to 01-Aug-2026

Cabin	6550 EUR pp
-------	-------------

26-Jul-2026 to 01-Aug-2026

Cabin. From	6090 EUR pp
-------------	-------------

02-Aug-2026 to 08-Aug-2026

Cabin. From	6090 EUR pp
-------------	-------------

02-Aug-2026 to 08-Aug-2026

Cabin	6550 EUR pp
-------	-------------

09-Aug-2026 to 15-Aug-2026

Cabin	6550 EUR pp
-------	-------------

09-Aug-2026 to 15-Aug-2026

Cabin. From	6090 EUR pp
-------------	-------------

Wild Earth Travel
Small Ships, Big Adventures

0800 945 3327 (within New Zealand) | +64 (0) 3 365 1355 | **1800 107 715** (within Australia)

info@wildearth-travel.com | wildearth-travel.com

Wild Earth Travel

Small Ships, Big Adventures

wildearth-travel.com

info@wildearth-travel.com

PRICING

23-Aug-2026 to 29-Aug-2026

Cabin. From 6090 EUR pp

23-Aug-2026 to 29-Aug-2026

Cabin 6550 EUR pp

30-Aug-2026 to 05-Sep-2026

Cabin 6550 EUR pp

30-Aug-2026 to 05-Sep-2026

Cabin. From 6090 EUR pp

06-Sep-2026 to 12-Sep-2026

Cabin. From 6090 EUR pp

06-Sep-2026 to 12-Sep-2026

Cabin 6550 EUR pp

13-Sep-2026 to 19-Sep-2026

Cabin 6550 EUR pp

13-Sep-2026 to 19-Sep-2026

Cabin. From 6090 EUR pp

20-Sep-2026 to 26-Sep-2026

Cabin. From 6090 EUR pp

20-Sep-2026 to 26-Sep-2026

Cabin 6550 EUR pp

27-Sep-2026 to 03-Oct-2026

Cabin. From 6090 EUR pp

27-Sep-2026 to 03-Oct-2026

Cabin 6550 EUR pp

04-Oct-2026 to 10-Oct-2026

Cabin 6550 EUR pp

04-Oct-2026 to 10-Oct-2026

Cabin. From 6090 EUR pp

11-Oct-2026 to 17-Oct-2026

Cabin 5690 EUR pp

11-Oct-2026 to 17-Oct-2026

Cabin. From 5250 EUR pp

18-Oct-2026 to 24-Oct-2026

Cabin 5690 EUR pp

18-Oct-2026 to 24-Oct-2026

Cabin. From 5250 EUR pp

25-Oct-2026 to 31-Oct-2026

Cabin 5690 EUR pp

Wild Earth Travel

Small Ships, Big Adventures

0800 945 3327 (within New Zealand) | +64 (0) 3 365 1355 | **1800 107 715** (within Australia)

info@wildearth-travel.com | wildearth-travel.com