



Wild Earth Travel

Small Ships, Big Adventures

wildearth-travel.com

info@wildearth-travel.com

CLASSIC RIVER CRUISE — IRELAND

When it comes to river cruises, Ireland may be one of the most fascinating and undiscovered locations in Europe and even the world. The small island in the Atlantic ocean offers so much to individuals who are discovering its beauty for the very first time. Its folklore, friendly locals, and magical green landscape are only a scratch at the surface of how beautiful this country truly is.

The island has earned the nickname 'The Emerald Isle' due to its enchanting beauty. A river cruise across Irish waters offers the perfect opportunity for individuals to see the true depth of beauty that Ireland has. We will cruise the picturesque lakes of western Ireland between the gorgeous village of Glasson and the County Clare village of Killaloe, stopping at several charming villages such as Carrick-On-Shannon, Terryglass, and Mountshannon on the River Shannon.

This breathtaking Irish cruise will put you in touch with the legends and fables of the mythical land, the hospitable Irish people, and the wonderful wildlife. The extraordinary history of this land will quickly become apparent as you navigate through the Irish waters and Lochs such as Lough Derg and Lough Ree. On the journey, you will bear witness to the warming soul of the nation through the music, the crafts, and the people.

Ireland River Cruise Highlights

The stunning Shannon Princess Hotel Barge navigates the River Shannon and Surrounding lakes between the quaint village of

Glasson and the gorgeous village of Killaloe. Throughout the voyage, you will get the opportunity to explore and unlock the widely undiscovered beauty of 'the emerald isle'.

The exploration of the stunning local villages along this stunning route will allow you to fully experience the true soul of the country. The lively music, friendly locals and enchanting scenery all ensure that your time on the waterways of Ireland will be a truly unforgettable experience.

One of the most popular explorations on our journey is through the breathtaking inner lakes of Lough Ree. From here we will head north where you will get the chance to explore some of the 365 glorious islands on the lake, surrounded by magical scenery.

The Shannon Princess will also take you to some of the area's most impressive architectural locations such as Portumna Castle, Birr Castle and many more. Not only are these locations incredibly impressive, but they are also steeped in history and culture.

Wild Earth Travel

Small Ships, Big Adventures

0800 945 3327 (within New Zealand) | +64 (0) 3 365 1355 | **1800 107 715** (within Australia)

info@wildearth-travel.com | **wildearth-travel.com**

Wild Earth Travel

Small Ships, Big Adventures

wildearth-travel.com

info@wildearth-travel.com

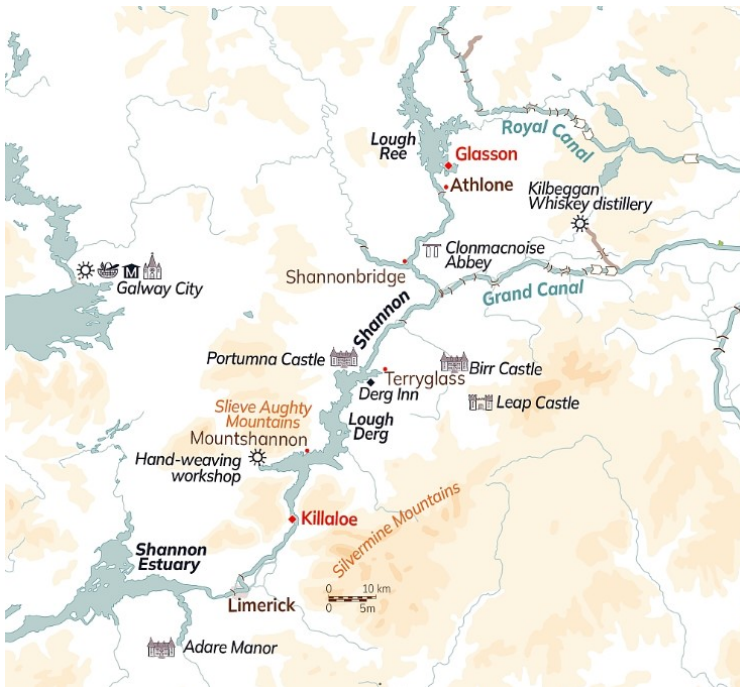

This morning we begin our cruise around the beautiful "Inner Lakes" of Lough Ree and then continue north as we explore some of the 365 islands on the lake. We then circle back to the River Shannon and onto our mooring in Athlone Town. After lunch we visit the Kilbeggan Whiskey Distillery, dating from 1757 and the oldest licensed whiskey distillery in the world. Dinner on board.

Tuesday, Day 3 Athlone to Shannonbridge

Today we negotiate Athlone Lock and head south through Europe's richest example of "Callow" landscape. We moor at Clonmacnoise ruins, a famed 6th century university and an early monastic settlement. Following a tour, we cruise on to our mooring at Shannonbridge. Then, after lunch we visit Leap Castle, reputed to be Ireland's most haunted house. You will be given a personal tour by the eccentric owner Sean Ryan, whom with traditional Irish musicians, will relate to you the fascinating history of the castle and its part in founding the American Constitution. Dinner on board.

Wednesday, Day 4 Shannonbridge to Terryglass

This morning, we cruise a very pretty stretch of the River Shannon through Meelick lock, pausing as Portumna swing bridge is opened to allow us passage onto idyllic Lough Derg and then moor at Terryglass Harbour. This afternoon we visit Birr Castle, still resided in by the Earl of Rosse and family, to see the magnificent gardens, the fascinating Science Centre and admire the historic Great Telescope. Dinner on board.

Thursday, Day 5 Terryglass to Mountshannon

Today, our tour is firstly, to the walled gardens of Portumna Castle, then on to Galway, a lively University City and cultural centre for Irish-speaking regions in Western Ireland. Visit the Galway crystal, craft and linen shops and then lunch at a traditional Guinness & Oyster pub. We return to Shannon Princess and set

nd culture.

ITINERARY

Sunday, Day 1 Glasson

Guests are met in Dublin and transferred by private chauffeured minibus to the Shannon Princess. Your Captain and his crew will welcome you onboard with champagne, black velvet cocktails or perhaps an Irish coffee, then time for a stroll and perhaps a visit to St. Flannan's Cathedral. Dinner on board.

Monday, Day 2 Glasson to Athlone

Wild Earth Travel

Small Ships, Big Adventures

0800 945 3327 (within New Zealand) | +64 (0) 3 365 1355 | 1800 107 715 (within Australia)

info@wildearth-travel.com | wildearth-travel.com

Wild Earth Travel

Small Ships, Big Adventures



wildearth-travel.com

info@wildearth-travel.com

sail across beautiful Lough Derg, passing Forrest Park and ancient mountains as we enjoy our dinner and sunset cruise to Mountshannon - a lovely lakeside village perched above the Lough.

Friday, Day 6 Mountshannon to Killaloe

Today we set sail across south Lough Derg, re-joining the River Shannon to moor at Killaloe, once home to the court of the greatest High King of Ireland, Brian Boru. After exploring this elegant little town, we lunch on board, then set off to Adare Manor, a magnificent estate located on the banks of the River Maigue. Here, in the setting of the Walled Garden, we gain a real insight into the history and tradition of falconry and have the opportunity to 'get up close and personal' with birds of prey such as owls, falcons and eagles - a magical experience. We end the afternoon by visiting a traditional Irish hand-weaving workshop. 'Slainte' cocktail reception and Captain's Farewell Dinner on board.

Saturday, Day 7 Killaloe

After breakfast, guests are transferred by private chauffeured minibus to Dublin.

Please Note:

This is a sample itinerary and is subject to change. On alternate weeks the cruise is in the reverse direction.

Wild Earth Travel

Small Ships, Big Adventures

0800 945 3327 (within New Zealand) | +64 (0) 3 365 1355 | **1800 107 715** (within Australia)

info@wildearth-travel.com | **wildearth-travel.com**

Wild Earth Travel

Small Ships, Big Adventures

wildearth-travel.com

info@wildearth-travel.com

YOUR SHIP: SHANNON PRINCESS

YOUR SHIP: Shannon Princess

VESSEL TYPE: Hotel Barge

LENGTH: 110 feet

PASSENGER CAPACITY: 10

BUILT/REFURBISHED:

The River Shannon and its lakes represent Ireland at its finest and your cruise aboard Shannon Princess features a landscape of rolling green fields, ancient Celtic landmarks and an abundance of wildlife.

The legends and fables of Ireland are found everywhere and are well understood by the hospitable Irish people who will be happy to tell you more about the ancient culture. The history of Ireland has been varied and sometimes difficult, but the locals always find the time to chat and perhaps charm you a tale or two of folklore.

During your cruise, there is a programme of fascinating excursions that will give you a true immersion into the heritage and traditions of this part of Ireland, such as a personal tour of a castle by its eccentric owner, a birds of prey display, visits to a whiskey distillery and hand-weaving workshop and, of course, the chance to sample a pint or two of the 'black stuff' - Guinness.

Shannon Princess, accommodating 10 guests in comfort, is the largest hotel barge to be cruising the River Shannon and its picturesque, intertwining lakes. Her thoughtfully-designed interior includes a comfortable saloon and dining area with

panoramic windows. The five junior twin/double cabin suites, also with picture windows, are stylishly furnished and each is air-conditioned, centrally heated, and accompanied by a modern en-suite shower room.

The large rooftop sundeck is certainly the place to relax, perhaps on one of the comfortable loungers, to watch the countryside glide slowly by, or in the heated spa pool. There is also an inviting dining area with circular table to savour that gourmet meal on warmer days.

Shannon Princess's Captain and his crew will go out of their way to ensure your every need is accommodated, while your Master Chef who was trained at Darina Allen's world-famous Ballymaloe Cookery School, will create some wonderful signature dishes to make your enthralling voyage through the 'Emerald Isle' complete.



' complete.

Wild Earth Travel

Small Ships, Big Adventures

0800 945 3327 (within New Zealand) | +64 (0) 3 365 1355 | **1800 107 715** (within Australia)

info@wildearth-travel.com | wildearth-travel.com

Wild Earth Travel

Small Ships, Big Adventures



wildearth-travel.com

info@wildearth-travel.com

INSIDE YOUR SHIP

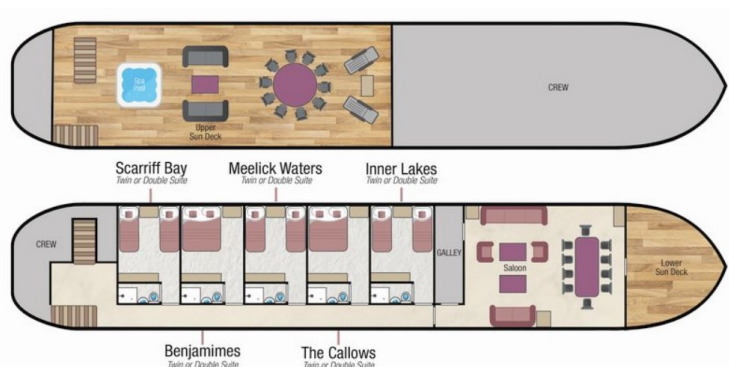

Cabin



Wild Earth Travel

Small Ships, Big Adventures

0800 945 3327 (within New Zealand) | +64 (0) 3 365 1355 | 1800 107 715 (within Australia)

info@wildearth-travel.com | wildearth-travel.com

Wild Earth Travel

Small Ships, Big Adventures

wildearth-travel.com

info@wildearth-travel.com

PRICING

06-Jul-2025 to 12-Jul-2025

Cabin	6090 EUR pp
-------	-------------

13-Jul-2025 to 19-Jul-2025

Cabin	6090 EUR pp
-------	-------------

20-Jul-2025 to 26-Jul-2025

Cabin	6090 EUR pp
-------	-------------

27-Jul-2025 to 02-Aug-2025

Cabin	6090 EUR pp
-------	-------------

03-Aug-2025 to 09-Aug-2025

Cabin	6090 EUR pp
-------	-------------

10-Aug-2025 to 16-Aug-2025

Cabin	6090 EUR pp
-------	-------------

17-Aug-2025 to 23-Aug-2025

Cabin	6090 EUR pp
-------	-------------

24-Aug-2025 to 30-Aug-2025

Cabin	6090 EUR pp
-------	-------------

31-Aug-2025 to 06-Sep-2025

Cabin	6090 EUR pp
-------	-------------

07-Sep-2025 to 13-Sep-2025

Cabin	6090 EUR pp
-------	-------------

14-Sep-2025 to 20-Sep-2025

Cabin	6090 EUR pp
-------	-------------

21-Sep-2025 to 27-Sep-2025

Cabin	6090 EUR pp
-------	-------------

28-Sep-2025 to 04-Oct-2025

Cabin	6090 EUR pp
-------	-------------

05-Oct-2025 to 11-Oct-2025

Cabin	6090 EUR pp
-------	-------------

19-Apr-2026 to 25-Apr-2026

Cabin	5990 EUR pp
-------	-------------

26-Apr-2026 to 02-May-2026

Cabin	5990 EUR pp
-------	-------------

03-May-2026 to 09-May-2026

Cabin	5990 EUR pp
-------	-------------

10-May-2026 to 16-May-2026

Cabin	6850 EUR pp
-------	-------------

17-May-2026 to 23-May-2026

Cabin	6850 EUR pp
-------	-------------

24-May-2026 to 30-May-2026

Cabin	6850 EUR pp
-------	-------------

31-May-2026 to 06-Jun-2026

Cabin	6850 EUR pp
-------	-------------

07-Jun-2026 to 13-Jun-2026

Cabin	6850 EUR pp
-------	-------------

Wild Earth Travel
Small Ships, Big Adventures

0800 945 3327 (within New Zealand) | +64 (0) 3 365 1355 | 1800 107 715 (within Australia)

info@wildearth-travel.com | wildearth-travel.com

Wild Earth Travel

Small Ships, Big Adventures



wildearth-travel.com

info@wildearth-travel.com

14-Jun-2026 to 20-Jun-2026

Cabin	6850 EUR pp
-------	-------------

21-Jun-2026 to 27-Jun-2026

Cabin	6850 EUR pp
-------	-------------

28-Jun-2026 to 04-Jul-2026

Cabin	6850 EUR pp
-------	-------------

05-Jul-2026 to 11-Jul-2026

Cabin	6850 EUR pp
-------	-------------

12-Jul-2026 to 18-Jul-2026

Cabin	6850 EUR pp
-------	-------------

19-Jul-2026 to 25-Jul-2026

Cabin	6850 EUR pp
-------	-------------

09-Aug-2026 to 15-Aug-2026

Cabin	6850 EUR pp
-------	-------------

30-Aug-2026 to 05-Sep-2026

Cabin	6850 EUR pp
-------	-------------

13-Sep-2026 to 19-Sep-2026

Cabin	6850 EUR pp
-------	-------------

20-Sep-2026 to 26-Sep-2026

Cabin	6850 EUR pp
-------	-------------

Wild Earth Travel
Small Ships, Big Adventures

0800 945 3327 (within New Zealand) | +64 (0) 3 365 1355 | **1800 107 715** (within Australia)

info@wildearth-travel.com | **wildearth-travel.com**